



## Stealthbox®

INSTALLATION GUIDE  
for the

**SB-POL-ACE/10TW1**

**SKU# 94628**

**2015 & Up Polaris Ace, Ace 570, & Ace 570 SP**

**Enclosure Type:** Sealed

**Driver Type:** 10TW1-4

**Nominal Impedance:** 2 ohms

**Continuous Power Handling:** 600 watts (RMS method)

### ! IMPORTANT

If you choose to perform the installation yourself, it is absolutely vital that the Stealthbox® be properly mounted to the vehicle according to these instructions. Failure to mount the enclosure properly presents two problems:

- 1) The sub-bass performance will suffer due to the movement of the enclosure caused by the force exerted by the woofer(s).
- 2) A loose enclosure presents a serious safety hazard in the event of a collision or sudden deceleration.

INSTALLATION  
DIFFICULTY:

**1** OUT OF **5**

ESTIMATED TIME:  
1 HOUR



*Thank you for choosing a JL Audio Stealthbox® for your automotive sound system. With proper installation, your new vehicle-specific enclosed subwoofer system will deliver years of listening pleasure.*

*We strongly recommend that you have your new Stealthbox® installed by your authorized JL Audio dealer. The installation professionals employed by your dealer have the necessary tools and experience to disassemble and reassemble your vehicle properly. If you prefer to perform your own installation, please read this installation guide completely before beginning the process.*

**INCLUDED HARDWARE**

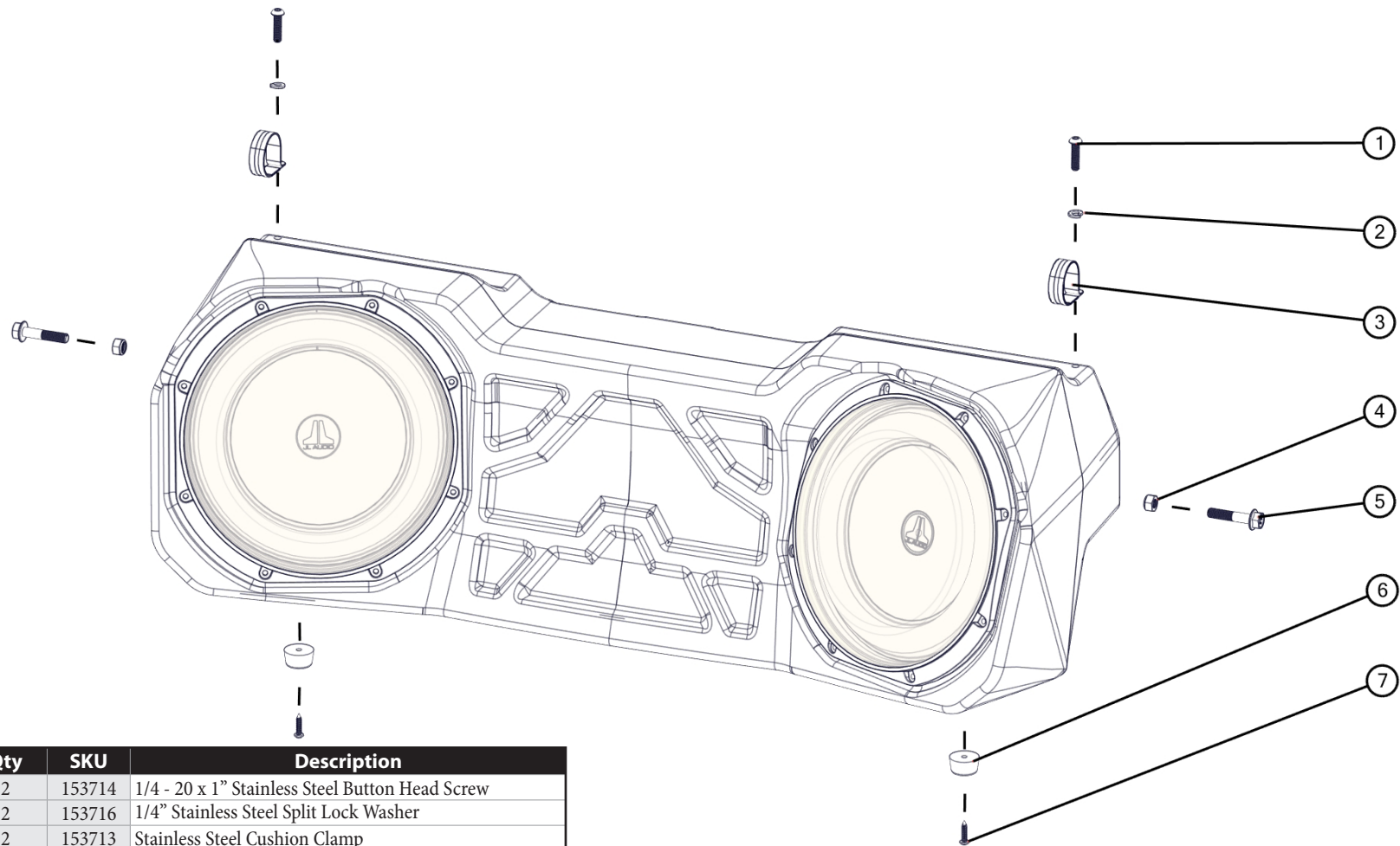

BOM ID	Qty	SKU	Description
1	2	153714	1/4 - 20 x 1" Stainless Steel Button Head Screw
2	2	153716	1/4" Stainless Steel Split Lock Washer
3	2	153713	Stainless Steel Cushion Clamp
4	2	153717	M8 - 1.25 Nylon Lock Nut
5	2	153718	M8 - 1.25 x 40mm Flange Head Cap Screw
6*	2	153709	Rubber Bumper
7*	2	153715	#8 x 3/4" Phillips Pan Head Stainless Steel Screw
-	1	150249	Foam Strips (not shown)

\* Pre-installed on enclosure

**Note: For optimum performance, JL Audio recommends applying the included Foam Strips (or sound damping material) to surrounding plastic panels to reduce unwanted vibrations.**

## POWER RECOMMENDATION

JL Audio recommends high quality amplifiers such as the JL Audio MX500/1. The diagram below shows the recommended crossover settings for the MX500/1. For a detailed description of the amplifier settings, consult the owner's manual for the amplifier. If another amplifier is being used, please reference this illustration and use similar settings on that amplifier.

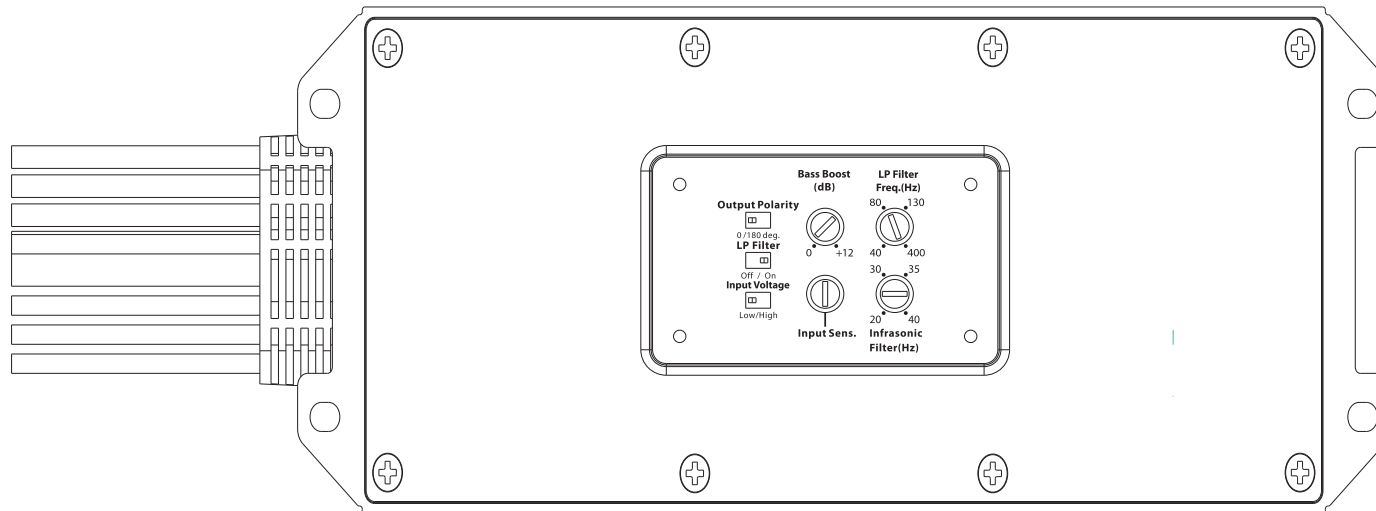

## CONNECTIONS

Using quality power, signal, and speaker wire is essential in ensuring the performance of your Stealthbox®. JL Audio recommends using a 4 AWG power kit such as the XD-PCS4-1B for your Stealthbox® amplifier. Other kits are available should you be using more than one amplifier. Signal wire such as the JL Audio Premium Audio Interconnect Cables should be used to provide signal for both channels of the amplifier. JL Audio recommends using 12AWG speaker wire for subwoofers such as the XC-BCS12-25.



**STEP 1**  
Empty the cargo area of the vehicle.



**STEP 2**  
Remove the factory bolt and nut from the horizontal section of the roll bar on both sides of the vehicle. These will not be reinstalled.



**STEP 3**  
Replace the factory bolts and nuts with the included, shorter M8 - 1.25 x 40 mm Flange Head Cap Screws and M8 - 1.25 Nylon Lock Nuts as shown, and firmly tighten.



**STEP 4**  
Attach the two Stainless Steel Cushion Clamps to the center, horizontal roll bar as shown. The holes in the clamps should be facing the rear of the vehicle. Slide both clamps to the center of the roll bar to allow clearance for the Stealthbox® installation in **Steps 6-7**.



**STEP 5**  
Pictured is one of the pre-installed Rubber Bumpers on the bottom of the Stealthbox®. These will sit into factory holes in the vehicle in **Step 7** to hold the base of the enclosure in place.



**STEP 6**  
It is recommended to use two people for **Steps 6-7**.  
Slide the seat forward. Connect speaker cable to the barrier strip on the bottom of the enclosure, and slide the enclosure into position, top first, as shown.



**STEP 7**  
Push the bottom of the enclosure toward the rear of the vehicle until the Rubber Bumpers drop into the factory holes in the vehicle.



**STEP 8**  
Slide a Stainless Steel Cushion Clamp to each of the outer edges of the roll bar, aligning the holes in the clamps to the threaded inserts in the top of the enclosure.



**STEP 9**

Secure each of the Stainless Steel Cushion Clamps to the enclosure using a 1/4 - 20 x 1" Stainless Steel Button Head Screw and 1/4" Stainless Steel Split Lock Washer, and fully tighten.



**STEP 10**

Route the speaker cable as necessary.

Note: For optimum performance, we recommend applying the included Foam Strips (or sound damping material) to surrounding plastic panels to reduce unwanted vibrations.

**CONGRATULATIONS!**

You have completed the installation for this model! Enjoy your new Stealthbox®!



**MID/HIGH FREQUENCY DRIVER FITMENT**

VeX™ Enclosed Speaker Systems are ideal for powersports and off-road vehicle applications. Each weatherproof pod can be mounted to a roll cage precisely aimed for optimum sound. Mounting fixtures are available to fit a variety of roll cage diameters.



**JL AUDIO** | How we play.®    

(954) 443-1100

[www.jlaudio.com](http://www.jlaudio.com)

All specifications are subject to change without notice. "JL Audio" and the JL Audio logo, and "Stealthbox" and the Stealthbox logo are registered trademarks of JL Audio, Inc. "Ahead of the Curve," its respective logo, and "How we play" are trademarks of JL Audio, Inc.  
Printed in USA • ©2016 JL Audio, Inc. • For more detailed information please visit us online at [www.jlaudio.com](http://www.jlaudio.com).

JLA-SKU# 011454 • ver. 09.16.2016 • 10369 NORTH COMMERCE PARKWAY • MIRAMAR, FLORIDA • 33025 • USA