



HOW TO USE THIS INSTALL GUIDE

- 1** Open the Bookmarks menu and find your vehicle OR scroll down until you find the install guide for your vehicle.
- 2** Print only the pages for your vehicle using the advanced options in the Print menu.
- 3** Install your Maestro RR according to the guide for your vehicle.

WARNING

Pressing the printer icon or “quick printing” this document will print all of the guides in this compilation.

RETAINS HEADS UP DISPLAY, STEERING WHEEL CONTROLS AND MORE!



PRODUCTS REQUIRED

iDatalink Maestro RR or RR2 Radio Replacement Interface
iDatalink Maestro CAM1 Dash Kit

PROGRAMMED FIRMWARE

ADS-RR(SR)-GM02C-DS

ADDITIONAL RESOURCES

[Maestro RR2 Programmable Outputs Guide](#)
[CAM1 Dash Kit Installation Video](#)

OPTIONAL ACCESSORIES



Click here for:

[Radar Integration Installation Guide](#)

[Radar Integration Owner's Guide for Kenwood and JVC Radios](#)

WELCOME

Congratulations on the purchase of your iDatalink Maestro RR Radio replacement solution. You are now a few simple steps away from enjoying your new car radio with enhanced features.

Before starting your installation, please ensure that your iDatalink Maestro module is programmed with the correct firmware for your vehicle and that you carefully review the install guide.

Please note that Maestro RR will only retain functionalities that were originally available in the vehicle.

NEED HELP?

 1 866 427-2999

 maestro.support@idatalink.com

 maestro.idatalink.com/support
www.12voltdata.com/forum

TABLE OF CONTENTS

Installation Instructions	3
Wiring Diagram	5
Radio Wire Reference Chart	6
Troubleshooting Table	7

INSTALLATION INSTRUCTIONS

DASH DISASSEMBLY (Center console removal)

Note: It is not possible to install the CAM1 dash kit and aftermarket radio without removing the center console.

1. Engage the parking brake. Put the shifter all the way back. (Fig. 1.1)
2. Pry upward and remove the center console trim. Unclip the center console wiring harnesses and remove it. (Fig. 1.2)
3. Using a panel tool, remove the side panels of the center console by prying the panels out and releasing the retainer clips. (Fig. 1.3)
4. (Automatic transmission) Remove a small cover on the front of the shifter to expose (1) torx screw. Remove the screw and shifter. (Fig. 1.4)

(Manual transmission) Pull up on the shifter knob to remove it.
5. Remove (4) 7mm screws securing the shifter bezel. Pull outward on the two clips below to release it. Disconnect the light from the panel (if equipped) and remove the shifter bezel. Disconnect the center console wiring harness (A), located at the back of the shifter. (Fig. 1.5)
6. Remove (2) Philips screws at the front of the center console (one on each side, near the junction of the radio/climate area). (Fig. 1.6)
7. Remove (4) Philips screws on the the rear sides the console. Remove the rear cover of the center console by gently releasing the clips that secure it. (Fig. 1.7)
8. Remove (2) Philips screws at the rear base of the center console. (Fig. 1.8)
9. Remove the center console cover by pulling upward and lifting it over the parking brake. (Fig. 1.9)

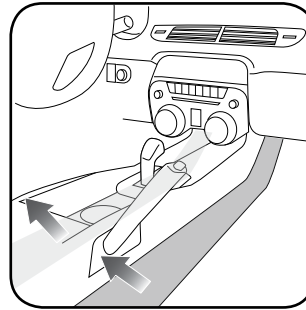

Fig. 1.3

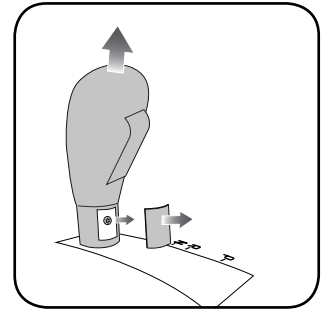

Fig. 1.4

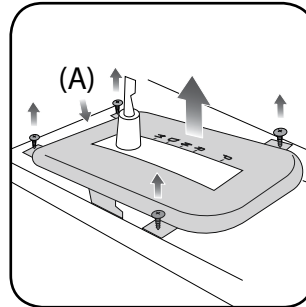

Fig. 1.5

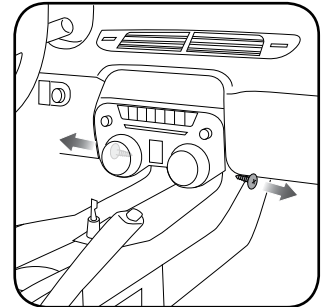

Fig. 1.6

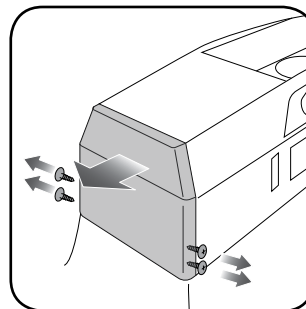

Fig. 1.7

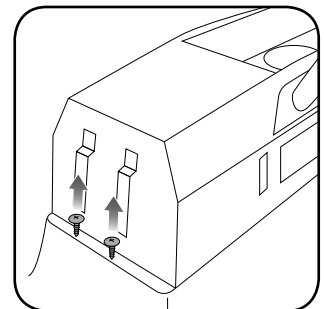

Fig. 1.8

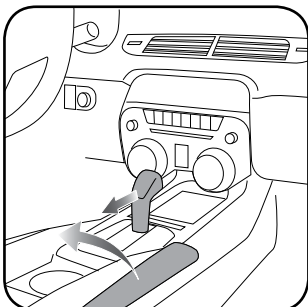

Fig. 1.1

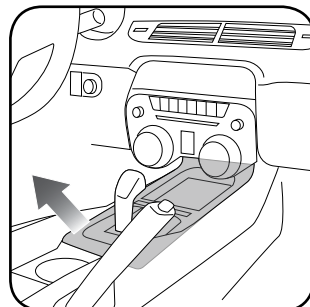

Fig. 1.2

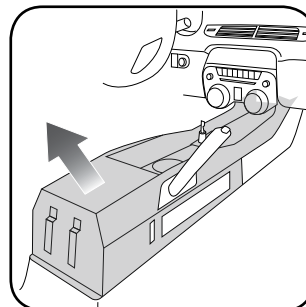

Fig. 1.9

INSTALLATION INSTRUCTIONS

DASH DISASSEMBLY (Radio removal)

1. Remove (2) 7mm screws securing the bottom of the radio bezel. (Fig. 2.1)
2. Using a panel tool, gently release the clips securing the radio bezel to the dash. Disconnect the wiring harness on the back of the OEM panel. (Fig. 2.1)
3. Remove (4) 7mm screws holding the OEM radio in the dash. Unclip the radio and remove it. (Fig. 2.2)

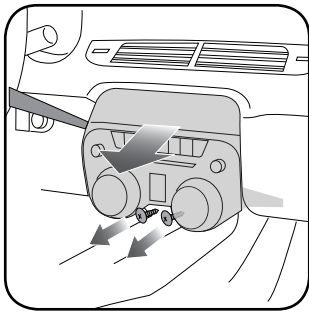

Fig. 2.1

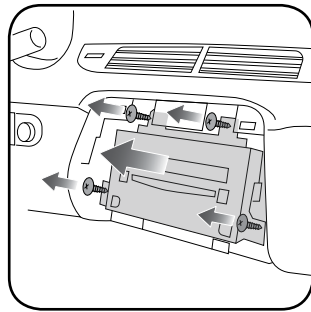

Fig. 2.2

RADIO INSTALLATION/MAKE CONNECTIONS

Unbox the aftermarket radio. Install the metal brackets provided with the CAM1 kit to the aftermarket radio using the screws supplied with the aftermarket radio. (Fig. 2.3)

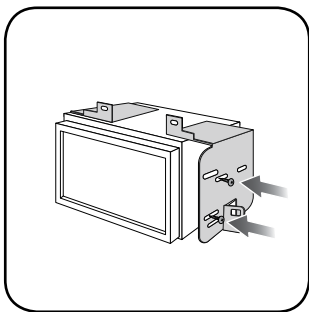

Fig. 2.3

(refer to wiring diagram)

1. Locate the aftermarket radio's main harness. Connect the wires from the aftermarket radio's main harness to the CAM1 t-harness and match the wire functions
2. Plug the backup camera cable into the factory harness (if applicable).

3. Connect the CAM1 T-harness to the factory radio harness.
4. Plug the OBD2 connector into the OBD2 port of the vehicle, located under the driver side dash.
5. Plug the aftermarket radio harnesses into the aftermarket radio. Plug the data cable to the data port of the aftermarket radio. Insert the audio cable into the iDatalink 3.5mm audio jack of the aftermarket radio (labeled iDatalink). If there is no iDatalink audio input, connect to AUX). Plug the backup camera RCA into the aftermarket radio (if applicable).

Note: When using a Pioneer radio, please ensure that there is nothing plugged into the W/R port of the radio.

6. Connect all harnesses to the Maestro RR module.
7. Insert the radio into the dash and secure the metal brackets with (4) 7mm screws removed during disassembly. (Fig. 2.4)
8. Connect the white 6-pin harness to the button bar of the dash kit.
9. Press the CAM1 bezel into place and secure it with the (2) 7mm screws. Test your installation before completely re-assembling the vehicle. (Fig. 2.5)

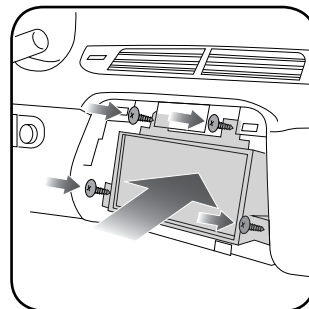

Fig. 2.4

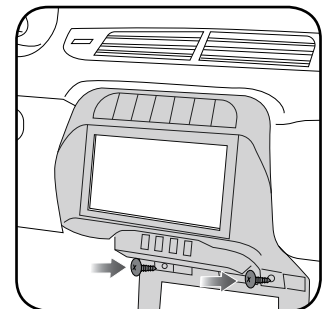
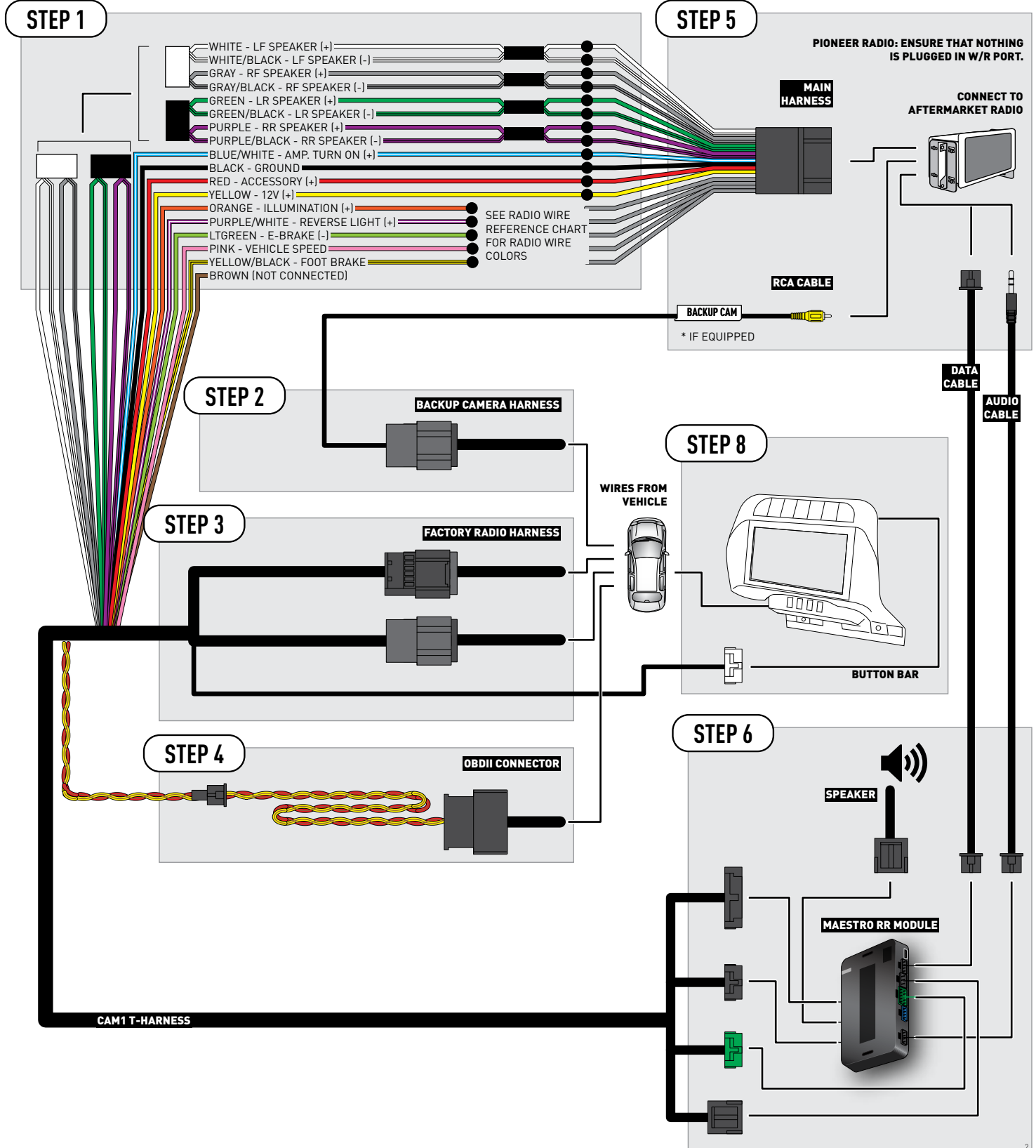

Fig. 2.5

WIRING DIAGRAM *with an Amplifier*



RADIO WIRE REFERENCE CHART

Wire Description	Polarity	Wire Color on Maestro T-Harness	Wire Color on Alpine cable	Wire Color on Kenwood cable	Wire Color on Pioneer cable	Wire Color on Sony cable
Illumination	(+)	Orange	N/A	Orange/White	Orange/White	Orange
Reverse Light	(+)	Purple/White	Orange/White	Purple/White	Purple/White	Purple/White
E-Brake	(-)	Lt Green	Yellow/Blue	Lt Green	Lt Green	Lt Green
Foot Brake	(+)	Yellow/Black	Yellow/Black	N/A	Pink	N/A
VSS (vehicle speed sensor)	(DATA)	Pink	Green/White	N/A	N/A	N/A

TROUBLESHOOTING TABLE

PROBLEM	SOLUTION
The light on the Maestro is blinking RED TWICE .	<p>Ensure the 4-pin data cable is connected between the radio and the RR, and that it is plugged into the black port on the Maestro RR. The red and blue ports on the RR should be empty.</p> <p>Make sure the correct radio model and serial number were entered during the flash. Verify the radio's serial number entered during the flash matches what is listed on the radio screen. This can be found in the settings of the radio, listed as Device Id, Device Number, or Serial Number.</p>
The light on the Maestro is flashing RED ONCE .	There is no firmware on the module; flash the RR module.

MAESTRO RR RESET PROCEDURE:

Turn the key to the OFF position, then disconnect all connectors from the module.
 Press and hold the module's programming button and connect all the connectors back to the module. Wait, the module's LED will flash RED rapidly (this may take up to 10 seconds).
 Release the programming button. Wait, the LED will turn solid GREEN for 2 seconds to show the reset was successful.

TECHNICAL ASSISTANCE

Phone: 1-866-427-2999

Email: maestro.support@idatalink.com

Web: maestro.idatalink.com/support add www.12voldata.com/forum/

IMPORTANT: To ensure proper operation, the aftermarket radio needs to have the latest firmware from the manufacturer. Please visit the radio manufacturer's website and look for any updates pertaining to your radio.

RETAINS HEADS UP DISPLAY, STEERING WHEEL CONTROLS AND MORE!



PRODUCTS REQUIRED

iDatalink Maestro RR or RR2 Radio Replacement Interface
iDatalink Maestro CAM1 Dash Kit

PROGRAMMED FIRMWARE

ADS-RR(SR)-GM02C-DS

ADDITIONAL RESOURCES

[Maestro RR2 Programmable Outputs Guide](#)
[CAM1 Dash Kit Installation Video](#)

OPTIONAL ACCESSORIES



Click here for:

[Radar Integration Installation Guide](#)

[Radar Integration Owner's Guide for Kenwood and JVC Radios](#)

WELCOME

Congratulations on the purchase of your iDatalink Maestro RR Radio replacement solution. You are now a few simple steps away from enjoying your new car radio with enhanced features.

Before starting your installation, please ensure that your iDatalink Maestro module is programmed with the correct firmware for your vehicle and that you carefully review the install guide.

Please note that Maestro RR will only retain functionalities that were originally available in the vehicle.

NEED HELP?

 1 866 427-2999

 maestro.support@idatalink.com

 maestro.idatalink.com/support
www.12voltdata.com/forum

TABLE OF CONTENTS

Installation Instructions	3
Wiring Diagram	5
Radio Wire Reference Chart	6
Troubleshooting Table	7

INSTALLATION INSTRUCTIONS

DASH DISASSEMBLY (Center console removal)

Note: It is not possible to install the CAM1 dash kit and aftermarket radio without removing the center console.

1. Engage the parking brake. Put the shifter all the way back. (Fig. 1.1)
2. Pry upward and remove the center console trim. Unclip the center console wiring harnesses and remove it. (Fig. 1.2)
3. Using a panel tool, remove the side panels of the center console by prying the panels out and releasing the retainer clips. (Fig. 1.3)
4. (Automatic transmission) Remove a small cover on the front of the shifter to expose (1) torx screw. Remove the screw and shifter. (Fig. 1.4)

(Manual transmission) Pull up on the shifter knob to remove it.
5. Remove (4) 7mm screws securing the shifter bezel. Pull outward on the two clips below to release it. Disconnect the light from the panel (if equipped) and remove the shifter bezel. Disconnect the center console wiring harness (A), located at the back of the shifter. (Fig. 1.5)
6. Remove (2) Philips screws at the front of the center console (one on each side, near the junction of the radio/climate area). (Fig. 1.6)
7. Remove (4) Philips screws on the the rear sides the console. Remove the rear cover of the center console by gently releasing the clips that secure it. (Fig. 1.7)
8. Remove (2) Philips screws at the rear base of the center console. (Fig. 1.8)
9. Remove the center console cover by pulling upward and lifting it over the parking brake. (Fig. 1.9)

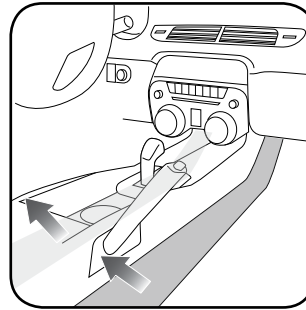

Fig. 1.3

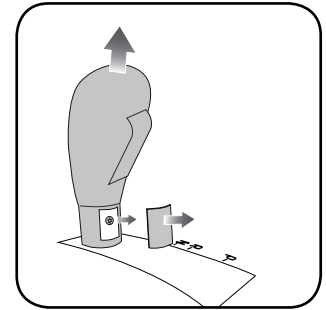

Fig. 1.4

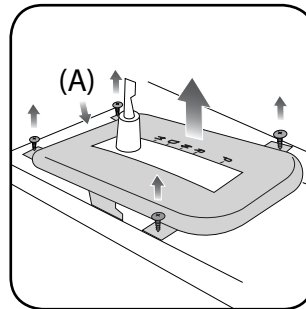

Fig. 1.5

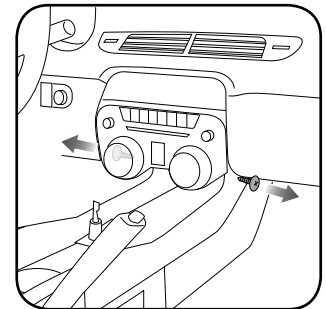

Fig. 1.6

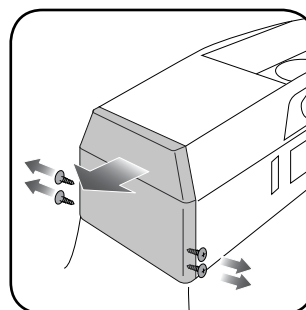

Fig. 1.7

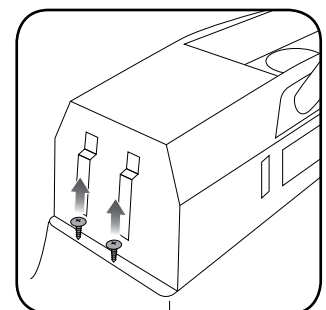

Fig. 1.8

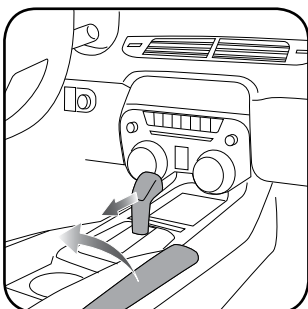

Fig. 1.1

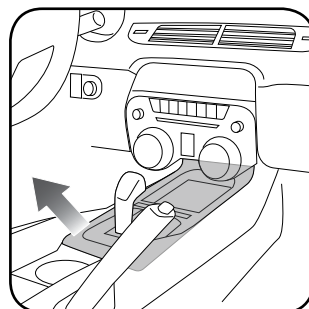

Fig. 1.2

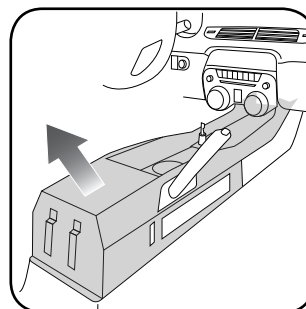

Fig. 1.9

INSTALLATION INSTRUCTIONS

DASH DISASSEMBLY (Radio removal)

1. Remove (2) 7mm screws securing the bottom of the radio bezel. (Fig. 2.1)
2. Using a panel tool, gently release the clips securing the radio bezel to the dash. Disconnect the wiring harness on the back of the OEM panel. (Fig. 2.1)
3. Remove (4) 7mm screws holding the OEM radio in the dash. Unclip the radio and remove it. (Fig. 2.2)

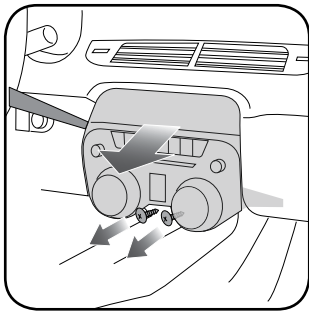

Fig. 2.1

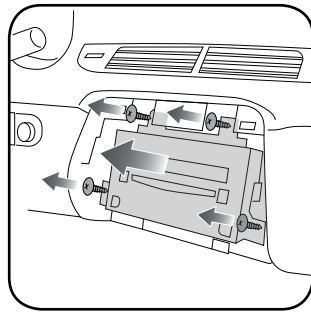

Fig. 2.2

RADIO INSTALLATION/MAKE CONNECTIONS

Unbox the aftermarket radio. Install the metal brackets provided with the CAM1 kit to the aftermarket radio using the screws supplied with the aftermarket radio. (Fig. 2.3)

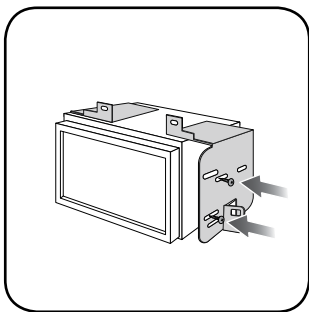

Fig. 2.3

(refer to wiring diagram)

1. Locate the aftermarket radio's main harness. Cut and remove the speaker wire junction connectors. Connect the wires from the aftermarket radio's main harness to the CAM1 t-harness and match the wire functions
2. Plug the backup camera cable into the factory harness (if applicable).

3. Connect the CAM1 T-harness to the factory radio harness.
4. Plug the OBD2 connector into the OBD2 port of the vehicle, located under the driver side dash.
5. Plug the aftermarket radio harnesses into the aftermarket radio. Plug the data cable to the data port of the aftermarket radio. Insert the audio cable into the iDatalink 3.5mm audio jack of the aftermarket radio (labeled iDatalink). If there is no iDatalink audio input, connect to AUX). Plug the backup camera RCA into the aftermarket radio (if applicable).

Note: When using a Pioneer radio, please ensure that there is nothing plugged into the W/R port of the radio.

6. Connect all harnesses to the Maestro RR module.
7. Insert the radio into the dash and secure the metal brackets with (4) 7mm screws removed during disassembly. (Fig. 2.4)
8. Connect the white 6-pin harness to the button bar of the dash kit.
9. Press the CAM1 bezel into place and secure it with the (2) 7mm screws. Test your installation before completely re-assembling the vehicle. (Fig. 2.5)

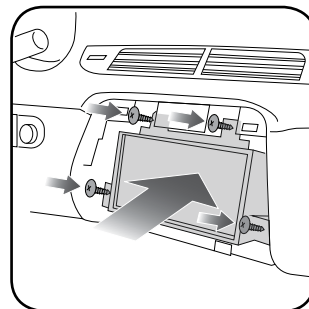

Fig. 2.4

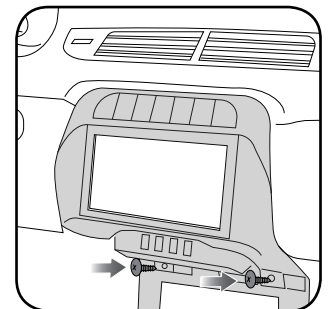
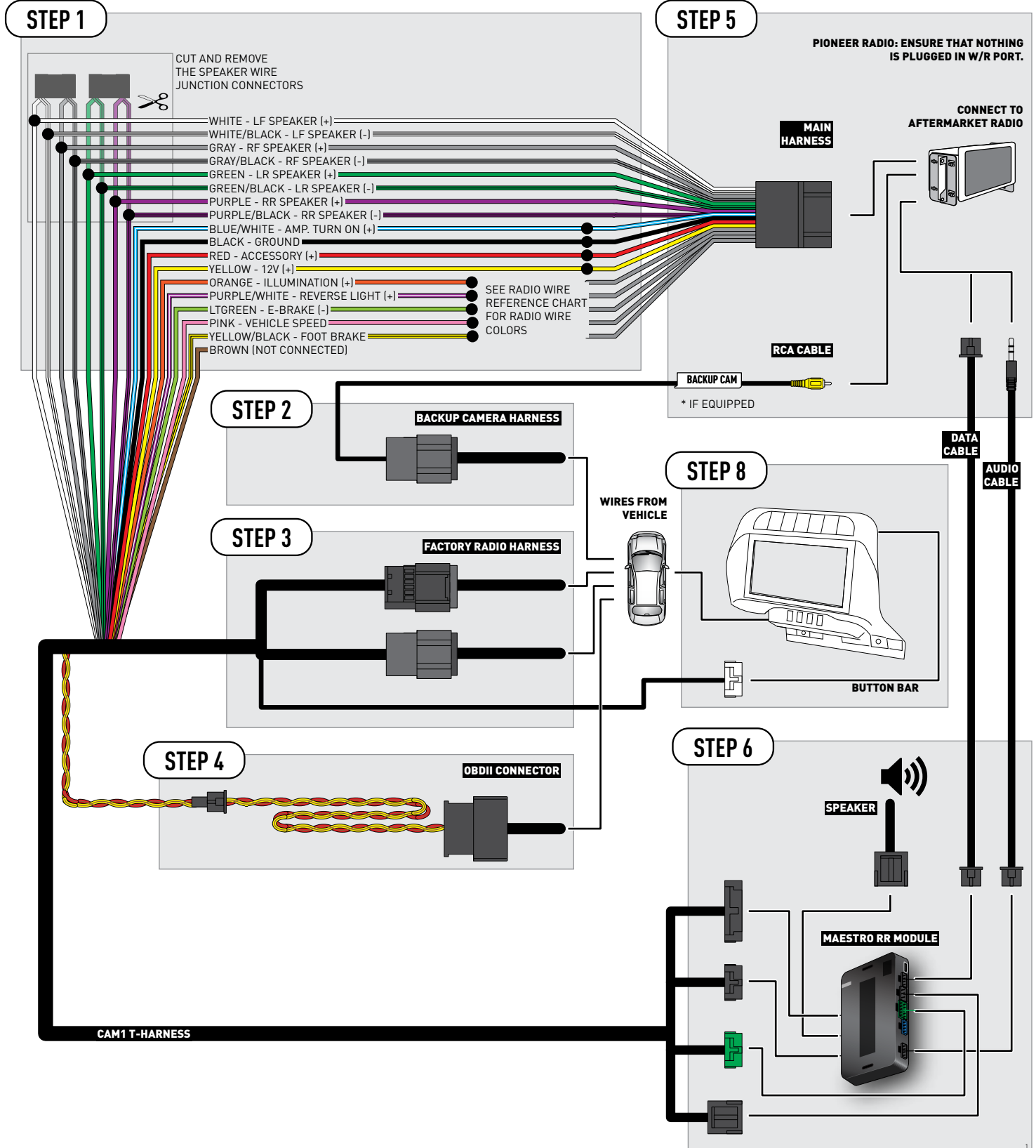

Fig. 2.5

WIRING DIAGRAM *without an Amplifier*



RADIO WIRE REFERENCE CHART

Wire Description	Polarity	Wire Color on Maestro T-Harness	Wire Color on Alpine cable	Wire Color on Kenwood cable	Wire Color on Pioneer cable	Wire Color on Sony cable
Illumination	(+)	Orange	N/A	Orange/White	Orange/White	Orange
Reverse Light	(+)	Purple/White	Orange/White	Purple/White	Purple/White	Purple/White
E-Brake	(-)	Lt Green	Yellow/Blue	Lt Green	Lt Green	Lt Green
Foot Brake	(+)	Yellow/Black	Yellow/Black	N/A	Pink	N/A
VSS (vehicle speed sensor)	(DATA)	Pink	Green/White	N/A	N/A	N/A

TROUBLESHOOTING TABLE

PROBLEM	SOLUTION
The light on the Maestro is blinking RED TWICE .	<p>Ensure the 4-pin data cable is connected between the radio and the RR, and that it is plugged into the black port on the Maestro RR. The red and blue ports on the RR should be empty.</p> <p>Make sure the correct radio model and serial number were entered during the flash. Verify the radio's serial number entered during the flash matches what is listed on the radio screen. This can be found in the settings of the radio, listed as Device Id, Device Number, or Serial Number.</p>
The light on the Maestro is flashing RED ONCE .	There is no firmware on the module; flash the RR module.

MAESTRO RR RESET PROCEDURE:

Turn the key to the OFF position, then disconnect all connectors from the module.
 Press and hold the module's programming button and connect all the connectors back to the module. Wait, the module's LED will flash RED rapidly (this may take up to 10 seconds).
 Release the programming button. Wait, the LED will turn solid GREEN for 2 seconds to show the reset was successful.

TECHNICAL ASSISTANCE

Phone: 1-866-427-2999

Email: maestro.support@idatalink.com

Web: maestro.idatalink.com/support add www.12voldata.com/forum/

IMPORTANT: To ensure proper operation, the aftermarket radio needs to have the latest firmware from the manufacturer. Please visit the radio manufacturer's website and look for any updates pertaining to your radio.

LIMITED 1-YEAR WARRANTY

Automotive Data Solutions Inc. ("ADS") warrants to the original purchaser that this product shall be free of defects in material and workmanship under normal use and circumstances, for the period of one (1) year as of the original date of purchase.

In the event of any product malfunction during the Warranty period, the original purchaser must return to the Authorized Dealer where it was originally purchased with the original proof of purchase. If a malfunction is detected, the Authorized Dealer will elect to repair or replace the product at its discretion. Labor costs may be applicable and are at the discretion of the Authorized Dealer.

ADS is not responsible for any damages whatsoever, including but not limited to any consequential damages, incidental damages for loss of time, loss of earnings, commercial loss of economic opportunity and the like that may or may not have resulted from the installation or operation of an iDatalink Maestro product.

GARANTIE LIMITÉE DE 1 AN

Automotive Data Solutions Inc. (ADS) garantit à l'acheteur original que ce produit est exempt de défauts dans les matériaux et dans la fabrication, et ce, dans des conditions normales d'utilisation, pour une période de un (1) an à partir de la date d'achat originale.

Si le produit ne fonctionne pas correctement alors qu'il est encore sous garantie, l'acheteur original doit retourner chez le détaillant autorisé où il a acheté son produit avec la preuve d'achat originale. Si le détaillant autorisé détecte une quelconque anomalie, il réparera ou de remplacera le produit, et ce, à sa discrétion. Des frais de main d'oeuvre peuvent s'appliquer et sont à la discrétion du détaillant autorisé.

ADS n'accepte aucune responsabilité pour tout dommage, y compris, sans s'y limiter, aux dommages consécutifs, dommages indirects, dommages pour pertes de temps, pour pertes de revenus, pour pertes commerciales, pour pertes de possibilités économiques qui pourraient ou non avoir résulté de l'installation ou du fonctionnement d'un produit iDatalink Maestro.

iDATALINK
maestro

GARANTÍA LIMITADA POR 1 AÑO

Automotive Data Solutions Inc. ("ADS") garantiza al comprador original que este producto no presentará ningún defecto relacionado con sus materiales o su fabricación, bajo condiciones normales de uso, durante un (1) año a partir de la fecha original de compra.

En caso de que el producto presente alguna falla durante el período de Garantía, el comprador original deberá remitirse al Distribuidor Autorizado donde lo compró, llevando consigo la prueba de compra original. Si se determina que el producto presenta una falla, el Distribuidor Autorizado podrá decidir si reparará o reemplazará el producto, según su criterio. Si esta situación genera costos por mano de obra, estos responderán al criterio del Distribuidor Autorizado.

ADS no se hace responsable por ningún tipo de daños, incluyendo, pero sin limitarse a, daños consecuenciales, daños indirectos producto de la pérdida de tiempo, la pérdida de ingresos, la pérdida comercial de una oportunidad económica y otros similares que puedan haber resultado o no de la instalación de un producto iDatalink Maestro.

iDATALINK
maestro

NEED HELP? BESOIN D'AIDE? ¿NECESITA AYUDA?

☎ 877.212.6169

ADS
AUTOMOTIVE DATA SOLUTIONS

iDATALINK
maestro

QUICK START GUIDE
FOR CAR RADIO INSTALLATION KITS

GUIDE DE DÉMARRAGE RAPIDE
POUR KITS D'INSTALLATION AUTORADIO

GUÍA DE INICIO RÁPIDO
PARA KITS DE INSTALACIÓN DE AUTORRADIO

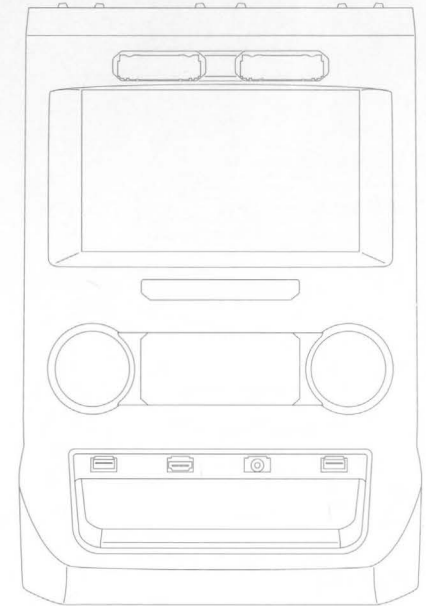

2017/09

ADS
AUTOMOTIVE DATA SOLUTIONS

WEB-PROGRAMMING STEPS



THIS PRODUCT REQUIRES THE INSTALLATION OF A MAESTRO RR (ADS-MRR) MODULE SOLD SEPARATELY

- 1 **INSTALL THE WEBLINK PLUGIN (FOR PC ONLY)**
Go to idatalinkmaestro.com/plugin and follow the installation steps. Review the System Requirements before installing. **Macintosh not supported.**
- 2 **REGISTER A WEBLINK ACCOUNT**
Go to idatalinkmaestro.com/register and complete the registration process. A confirmation email will be sent to you requiring validation.
- 3 **CONNECT THE MODULE TO YOUR PC**
Use the included mini USB cable to connect your iDataLink Maestro RR module to your PC.
- 4 **WEBLINK PROGRAMMING**
Go to idatalinkmaestro.com/login. Enter your username and password, then click OK. Follow the installation steps in Weblink until your module is flashed, then download your install guide. **Be sure to select the dash kit as an accessory in step 4.**
- 5 **COMPLETE VEHICLE-SPECIFIC INSTALLATION**
Follow the steps in your install guide and complete the installation. **ADS recommends having your iDataLink Maestro products installed by a certified technician.**

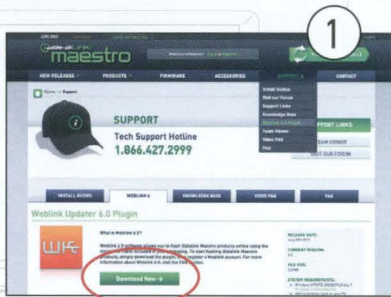

CE PRODUIT NÉCESSITE L'INSTALLATION D'UN MODULE MAESTRO RR (ADS-MRR) VENDU SÉPARÉMENT

- 1 **INSTALLEZ LE PLUGIN WEBLINK (PC SEULEMENT)**
Allez à idatalinkmaestro.com/plugin et suivez les étapes d'installation. Vérifiez les exigences système avant l'installation. **Macintosh n'est pas supporté.**
- 2 **INSCRIVEZ-VOUS À WEBLINK**
Allez à idatalinkmaestro.com/register et terminez le processus d'inscription. Un courriel de confirmation vous sera envoyé pour validation.
- 3 **BRANCHEZ LE MODULE À VOTRE PC**
Utilisez le mini-câble USB fourni pour brancher votre module iDataLink Maestro RR à votre PC.
- 4 **PROGRAMMATION WEBLINK**
Allez à idatalinkmaestro.com/login. Entrez votre nom d'utilisateur et votre mot de passe, puis cliquez sur OK. Suivez les étapes d'installation dans Weblink jusqu'à ce que votre module soit flashé, puis téléchargez votre guide d'installation. **Assurez-vous de sélectionner le kit de tableau de bord comme accessoire à l'étape 4.**
- 5 **INSTALLATION COMPLÈTE DU VÉHICULE**
Suivez les étapes de votre guide d'installation et terminez l'installation. **ADS recommande que vos iDataLink Maestro soient installés par un technicien certifié.**



PASOS DE PROGRAMACIÓN WEB



ESTE PRODUCTO REQUIERE LA INSTALACIÓN DEL MÓDULO MAESTRO RR (ADS-MRR) VENDIDO POR SEPARADO

- 1 **INSTALE EL COMPLEMENTO WEBLINK (SÓLO PC)**
Vaya a idatalinkmaestro.com/plugin y siga los pasos de instalación. Compruebe los requisitos del sistema antes de la instalación. **Macintosh no es compatible.**
- 2 **REGÍSTRESE A WEBLINK**
Vaya a idatalinkmaestro.com/register y complete el proceso de registro. Se le enviará un correo electrónico de confirmación para su validación.
- 3 **CONECTE EL MÓDULO A SU PC**
Utilice el cable mini USB suministrado para conectar su módulo iDataLink Maestro RR a su PC.
- 4 **PROGRAMACIÓN WEBLINK**
Vaya a idatalinkmaestro.com/login. Introduzca su nombre de usuario y contraseña y haga clic en OK. Siga los pasos de instalación en Enlace web hasta que su módulo se muestra, luego descargue la guía de instalación. **Asegúrese de seleccionar el kit del panel de instrumentos como accesorio en el paso 4.**
- 5 **INSTALACIÓN COMPLETA PARA SU VEHÍCULO**
Siga los pasos de la guía de instalación y complete la instalación. **ADS recomienda que su productos iDataLink Maestro sea instalado por un técnico certificado.**