



Head of the Curve®



Stealthbox®

INSTALLATION GUIDE
for the

SB-F-150-SPRCRW/13TW5v2
SKU# 94460-94462

2009-Up Ford F-150 SuperCrew & 2017-Up Ford SuperDuty Crew Cab

Enclosure Type: Sealed

Driver Type: 13TW5v2

Nominal Impedance: 2 ohms

Continuous Power Handling: 600 watts (RMS method)

SB-F-SPRCRW/13TW5v2 INSTR_SKU# 011297

! IMPORTANT

If you choose to perform the installation yourself, it is absolutely vital that the Stealthbox® be properly mounted to the vehicle according to these instructions. Failure to mount the enclosure properly presents two problems:

- 1) The sub-bass performance will suffer due to the movement of the enclosure caused by the force exerted by the woofer(s).
- 2) A loose enclosure presents a serious safety hazard in the event of a collision or sudden deceleration.

INSTALLATION
DIFFICULTY:

2 OUT OF 5

ESTIMATED TIME:
1-2 HOURS



Thank you for choosing a JL Audio Stealthbox® for your automotive sound system. With proper installation, your new vehicle-specific enclosed subwoofer system will deliver years of listening pleasure.

We strongly recommend that you have your new Stealthbox® installed by your authorized JL Audio dealer. The installation professionals employed by your dealer have the necessary tools and experience to disassemble and reassemble your vehicle properly. If you prefer to perform your own installation, please read this installation guide completely before beginning the process.

Continued on Next Page

INCLUDED HARDWARE

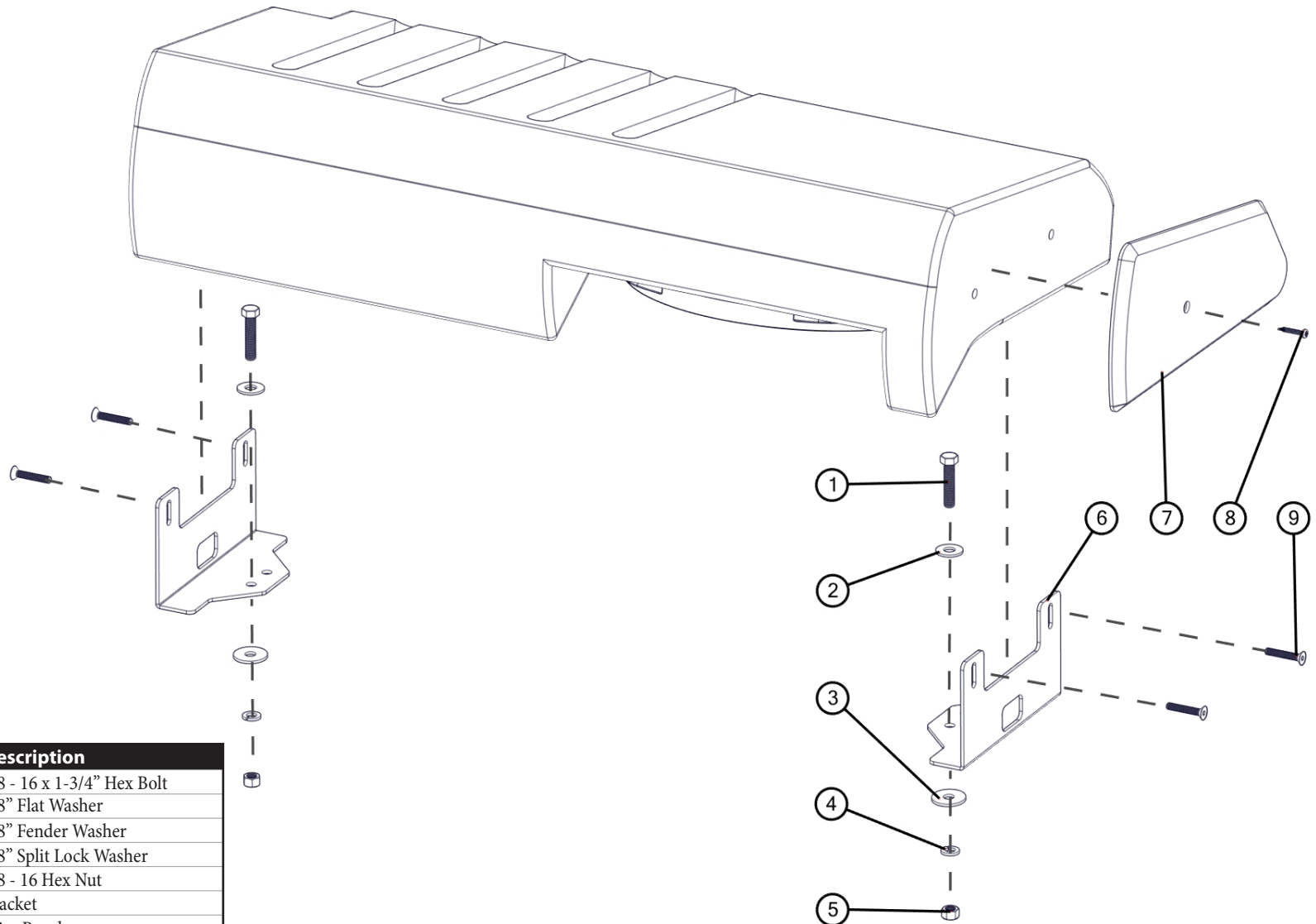

BOM ID	Qty	SKU	Description
1	2	151087	3/8 - 16 x 1-3/4" Hex Bolt
2	2	151095	3/8" Flat Washer
3	2	151126	3/8" Fender Washer
4	2	151081	3/8" Split Lock Washer
5	2	151406	3/8 - 16 Hex Nut
6	2	153865	Bracket
7	1	150570	Trim Panel
8	1	150295	#8 x 1" Self Tap Screw
9	4	150072	1/4 - 20 x 1-1/2" Hex Drive Bolt
-	2	151345	Wax Square (not shown)

POWER RECOMMENDATION

JL Audio recommends high quality amplifiers such as the JL Audio XD600/1v2. The diagram below shows the recommended crossover settings for the XD600/1v2. For a detailed description of the amplifier settings, consult the owner's manual for the amplifier. If another amplifier is being used, please reference this illustration and use similar settings on that amplifier.

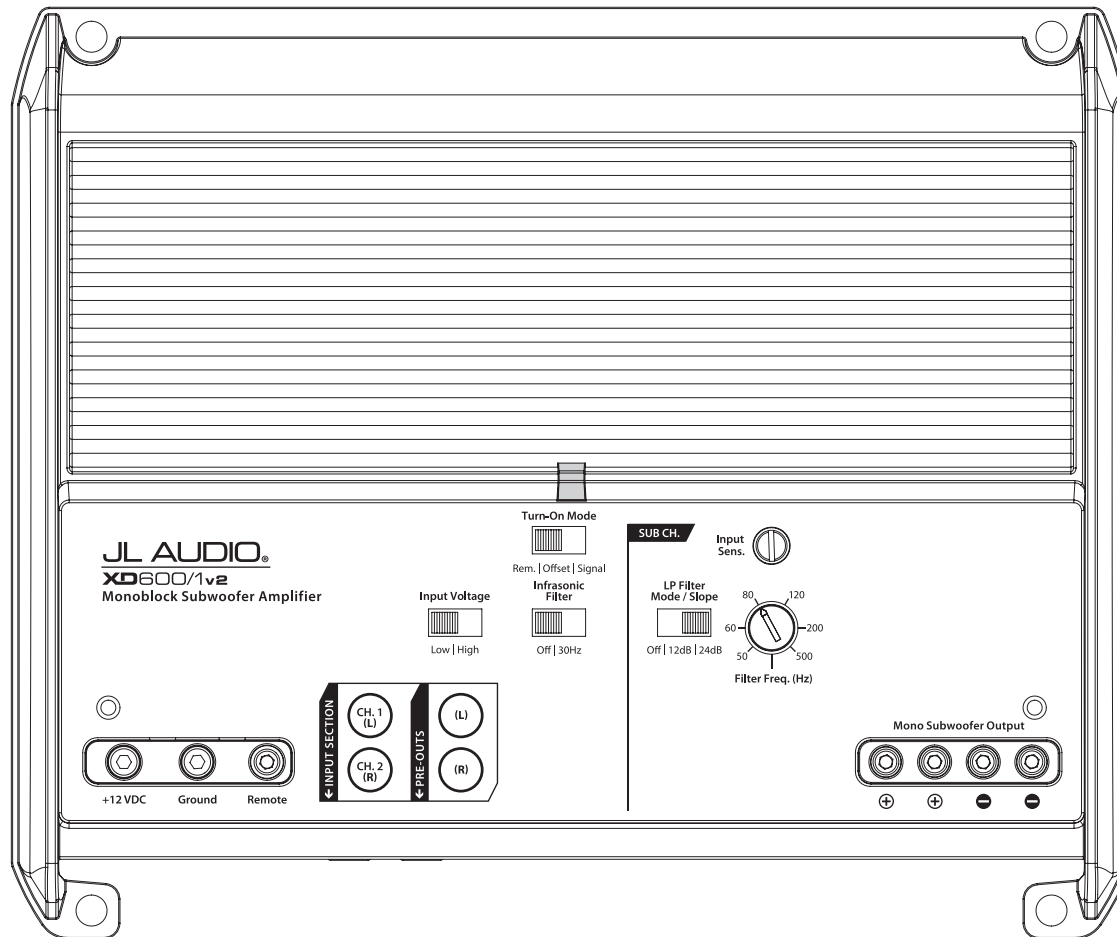

CONNECTIONS

Using quality power, signal, and speaker wire is essential in ensuring the performance of your Stealthbox®. JL Audio recommends using a 4 AWG power kit such as the XD-PCS4-1B for your Stealthbox® amplifier. Other kits are available should you be using more than one amplifier. Signal wire such as the JL Audio Premium Audio Interconnect Cables should be used to provide signal for both channels of the amplifier. JL Audio recommends using 12 AWG speaker wire for subwoofers such as our XC-BCS12-25.



STEP 1

Empty the rear seat area.



STEP 2

Lift the rear seat.



STEP 3

Note: Steps 3-9 are for vehicles equipped with the pictured plastic storage tray. For vehicles without the tray, skip to **Step 10**.

Fold open the plastic storage tray.

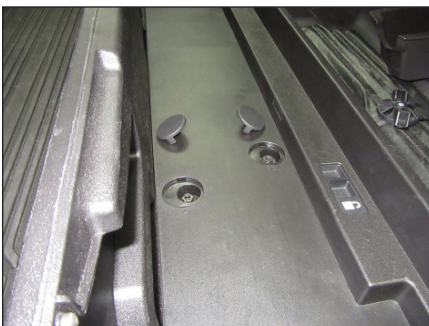

STEP 4

Remove the two cover panels from each side of the tray to expose the factory nuts.



STEP 5

Remove the two factory nuts from each side of the tray.



STEP 6

Unscrew the wing nut securing the jack tools.



STEP 7

Remove the jack tools from the vehicle.



STEP 8

Remove the plastic storage tray from the vehicle.



STEP 9

Reinstall the factory nuts on the studs, and fully tighten.



STEP 10

Note: Steps 10-12 are for F-150 vehicles equipped with the pictured factory subwoofer enclosure only. For all other vehicles, skip to **Step 13**.



STEP 11

Unclip and remove the three bolt covers, and remove the three bolts securing the factory subwoofer enclosure.



STEP 12

Unplug and remove the enclosure from the vehicle.



STEP 13

Align a Bracket to each end of the Stealthbox® as shown.



STEP 14

Thread a 1/4 - 20 x 1-1/2" Hex Drive Bolt through each of the slots in the Bracket, into the threaded inserts on the enclosure. With the 1/4 - 20 x 1-1/2" Hex Drive Bolts positioned at the top of each slot, fully tighten both bolts.

Repeat the process for the opposite side.



STEP 15

Place the Stealthbox® into the vehicle, as shown.



STEP 16

Align the Bracket with the raised edge of the floor on the driver's side, as shown.

Slide a Wax Square under each of the Brackets, centering them with the forward hole in the Bracket.



STEP 17

Carefully remove the Stealthbox® from the vehicle without moving the two Wax Squares.

Remove the adhesive backing from each Wax Square, and adhere them to the floor of the vehicle.



STEP 18

Carefully reinstall the Stealthbox®, and mark the locations of each of the forward holes on the Wax Squares using a pick tool or similar.



STEP 19

Remove the Stealthbox® once more. Using a 3/8" drill bit, carefully drill through the carpet and floor at each Wax Square mark made in the previous step. Remove the Wax Squares.



STEP 20

Remove the Bracket from each side of the Stealthbox®.



STEP 21

Align the forward hole in a Bracket with one of the drilled holes in the floor, as shown. Slide a 3/8" Flat Washer over a 3/8 - 16 x 1-3/4" Hex Bolt, and slide the bolt through the forward hole in the Bracket and the hole in the floor.



STEP 22

Repeat the process for the opposite side.



STEP 23

From under the vehicle, slide a 3/8" Fender Washer, a 3/8" Split Lock Washer, and a 3/8 - 16 Hex Nut over each of the 3/8 - 16 x 1-3/4" Hex Bolts, and fully tighten.



STEP 24

Reinstall the Stealthbox®. Reinstall the two 1/4 - 20 x 1-1/2" Hex Drive Bolts through the slots in each Bracket, into the threaded holes in each side of the enclosure, and fully tighten while pressing down on the enclosure.



STEP 25

Align the Trim Panel with the driver's side of the enclosure, as shown.



STEP 26

Lift the carpet flap to access the hole in the Trim Panel. Using a 1/8" drill bit, drill through the hole in the Trim Panel and into the Stealthbox®.

Secure the Trim Panel with a #8 x 1" Self Tap Screw, as shown.



STEP 27

Connect speaker cable to the terminal cup on the side of the Stealthbox®, and route the cable as necessary.

Replace the jack tools, if desired, and fold the rear seats back down.

CONGRATULATIONS!

You have completed the installation for this model! Enjoy your new Stealthbox®!



MID/HIGH FREQUENCY DRIVER FITMENT

A variety of JL Audio coaxial and component systems will fit in the factory speaker locations of your vehicle.

Vehicle	Location / OEM	Suggested JL Audio Speaker Models	
		Coaxial Models	Component Models
'09-'14 F-150	Front Doors / 6 x 8-inch	C1-570x, C2-570x, C5-570x	C3-570, C5-570
	Rear Doors / 6 x 8-inch	C1-570x, C2-570x, C5-570x	C3-570, C5-570
'15-Up F-150 & '17-Up SuperDuty	Front Doors / 6 x 9-inch	C1-690x, C1-690tx, C2-690tx, C5-650x ⁽¹⁾	C1-690, C3-650 ⁽¹⁾ , C5-650 ⁽¹⁾ , C7-650cw ^(1,2)
	Rear Doors / 6,5-inch	C1-650x, C2-650x, C5-650x	C1-650, C2-650, C3-650, C5-650, C7-650cw ⁽²⁾

1 - Installation may require adaptor, 2 - Component woofer only

JL AUDIO® | How we play.®    

(954) 443-1100

www.jlaudio.com

All specifications are subject to change without notice. "JL Audio" and the JL Audio logo, "Stealthbox" and the Stealthbox logo, and "How we play" are registered trademarks of JL Audio, Inc. "Ahead of the Curve" and its respective logo are trademarks of JL Audio, Inc. Printed in USA • ©2017 JL Audio, Inc. • For more detailed information please visit us online at www.jlaudio.com.