

UltraLink Auto

Apple CarPlay | Android Auto
Wireless Adapter



USER MANUAL

Attention: Use only under safe and legal conditions. Do not interact with the infotainment system unless conditions permit safe use.

INTRODUCTION

The **Ultralink Auto** Apple CarPlay® / Android Auto™ Wireless Adapter plugs into your car's USB port, enabling wireless connection to your car's existing wired Apple CarPlay or Android Auto feature. Once your phone is successfully paired with the wireless adapter, your phone should connect to Apple CarPlay or Android Auto automatically when the wireless adapter is powered on.*

* Note: This product is compatible with vehicles that support wired Apple CarPlay or Android Auto and requires a compatible smartphone device. Please consult your vehicle manufacturer or dealer for further information.

What's in the Box

- 1x Apple CarPlay / Android Auto Wireless Adapter
- 1x USB-C to USB-A Cable
- 1x USB-C to USB-C Cable
- 1x User Manual

COMPATIBILITY

Vehicles

Vehicles with built-in wired CarPlay or Android Auto functionality.

Phones

Apple CarPlay requires an iPhone 6 or newer model with iOS 10 and above. Android Auto requires Android phones running Android 11.0 and above, with the latest Android Auto app installed.

CONNECTING WIRELESSLY

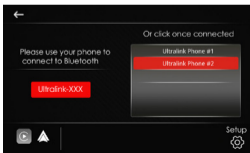

CONNECTING WIRELESSLY

Unpair and disconnect your phone's Bluetooth from the vehicle to prevent interference during setup.

For Apple CarPlay:

1. Connect the Ultralink Auto Wireless Adapter to the USB port in your car. Allow about 30 seconds for your device to power on.
2. Turn on your iPhone's Bluetooth and Wi-Fi. Search and connect to the Bluetooth device: **Ultralink-XXX**.
3. Approve the CarPlay connection request on your iPhone.
4. Wait for a CarPlay connection prompt on the car's infotainment system, select the CarPlay logo to access the main screen.

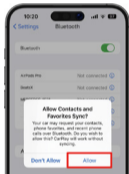

For Android Auto:

1. Connect the Ultralink Auto Wireless Adapter to the USB port in your car. Allow about 30 seconds for your device to power on.
2. Turn on your Android phone's Bluetooth and Wi-Fi. Search and connect to the Bluetooth device: **Ultralink-XXX**.
3. Wait for your Android Phone to complete the connection.
4. Wait for an Android Auto connection prompt on the car's infotainment system, select the Android Auto logo to access the main screen.



* Note: Not all Android phones support wireless Android Auto. Ensure you have downloaded and enabled the Wireless Android Auto feature on the latest Android Auto app from Google Play.

OPERATION

LED Indicators

- Red: Powering on but not connected
- Blue: Searching for a connection
- Green: Successfully connected

Technical Specifications

- Power input: 5V=1A
- Power consumption: 0.75W
- Compatible resolution: Dependent on the vehicle model

Troubleshooting

Q: The adapter doesn't seem to be working. What can I do?

A: Make sure that your car supports the wired version of CarPlay or Android Auto, and your phone is also compatible. This device does not add CarPlay or Android Auto to your car's infotainment system; rather, it offers additional wireless connectivity.

Q: I've confirmed that my car supports wired CarPlay / Android Auto, but still nothing happens when I plug in the wireless adapter. What now?

A: Try plugging the wireless adapter into different USB ports in your car, if available. For information on the locations of USB ports in your vehicle, consult your car's owner manual.

Q: My car supports wired CarPlay, but I can't seem to use wireless Android Auto with the adapter. Why is this?

A: This adapter only enables wireless connectivity for pre-existing wired CarPlay or Android Auto features in your car's infotainment system. It doesn't add new functionality like Android Auto to a system that doesn't already support it.

Q: Is it possible to pair the adapter with multiple devices?

A: Yes, you can pair the adapter with several phones, but it can maintain an active connection with only one device at a time. To switch the connected device, disconnect the currently active phone and adjust in the settings menu.

SERVICE

Customer Support

The illustrated products and specifications may differ slightly from those supplied. For more information or service contact our Customer Service Department.

E-mail

service@gentec-intl.com

Phone

905-513-7733

Ultralink One-Year Limited Warranty Summary

Ultralink warrants the included hardware product and accessories against defects in materials and workmanship for one year from the date of original retail purchase. This warranty does not cover normal wear and tear, nor damage from accidents or misuse. For service, contact the Ultralink customer service department. Charges for calls and shipping may apply, depending on your location. You may be required to provide proof of purchase details when making a warranty claim.

Distributed in Canada by Gentec International. ©2023 Ultralink, Ultralink Auto and certain graphic designs are trademarks of Gentec International, Markham, Ontario, Canada L3R 9X6. Apple, the Apple logo, iPhone and Apple CarPlay are trademarks of Apple Inc., registered in the U.S. and other countries. Android, Google Play and Android Auto are trademarks of Google LLC. All other brand names are trademarks of their respective owners. Gentec International is not affiliated with the respective trademark owners.