



HOW TO USE THIS INSTALL GUIDE

- 1** Open the Bookmarks menu and find your vehicle OR scroll down until you find the install guide for your vehicle.
- 2** Print only the pages for your vehicle using the advanced options in the Print menu.
- 3** Install your Maestro RR according to the guide for your vehicle.

WARNING

Pressing the printer icon or “quick printing” this document will print all of the guides in this compilation.

2017

FORD F-SERIES SUPER DUTY NOT RETAINING SYNC WITH MYFORD 4.3" SCREEN

RETAINS STEERING WHEEL CONTROLS, BACKUP CAMERA AND MORE!



PRODUCTS REQUIRED

iDatalink Maestro RR or RR2 Radio Replacement Interface
iDatalink Maestro FTR1 Dash Kit

PROGRAMMED FIRMWARE

ADS-RR(SR)-F02B-DS

ADDITIONAL RESOURCES

[Maestro RR2 Programmable Outputs Guide](#)

OPTIONAL ACCESSORIES

K40[™]
ELECTRONICS
ESCORT

HRN-ANT-SAT1

Click here for:
[Radar Installation Guides](#)

WELCOME

Congratulations on the purchase of your iDatalink Maestro RR Radio replacement solution. You are now a few simple steps away from enjoying your new car radio with enhanced features.

Before starting your installation, please ensure that your iDatalink Maestro module is programmed with the correct firmware for your vehicle and that you carefully review the install guide.

Please note that Maestro RR will only retain functionalities that were originally available in the vehicle.

NEED HELP?

 1 866 427-2999

 maestro.support@idatalink.com

 maestro.idatalink.com/support
www.12voltdata.com/forum

TABLE OF CONTENTS

Installation Instructions	3
Wiring Diagram	7
Radio Wire Reference Chart	8
Troubleshooting Table	9

INSTALLATION INSTRUCTIONS *NOT RETAINING SYNC

DASH DISASSEMBLY

1. If the vehicle is equipped with a center channel speaker: Pop the speaker grille up (A), unscrew (2) 7mm bolts from the tray (B), and remove it (C). (Fig. 1.0)
If there is no center channel speaker: lift the rubber mat at the top of the dash (A), then remove (2) 7mm bolts from the tray (B), and remove it (C). (Fig. 1.1)
2. Remove the (2) 7mm bolts from the top of the radio panel. Unclip the radio bezel, unplug its connectors, and remove the panel. (Fig. 2.0)
3. Remove the 7mm screws securing the factory screen and disconnect it. (Fig. 3.0)
4. Remove the (4) 7mm screws securing the radio module, then unplug and remove it. (Fig. 4.0)
5. Remove (2) 7mm screws securing the Sync module. Unplug and remove it. Note: Because sync is not being retained, the sync module does not need to be re-installed. (Fig. 5.0)
6. If the camera module is present, remove the (3) 10mm nuts securing it and remove the module. (Fig. 6.0)
Looking down, from the top of the dash, locate the (2) 8mm bolts securing the camera module's bracket and remove them. Remove the (2) 7mm bolts under the plastic of the top of the dash (bolts aren't visible). Work the metal bracket free from the sub-dash and remove it. (Fig. 6.1)
Note: the bracket may be cut but this will prevent re-installing OEM equipment.
7. Unclip the factory harness that is secured to the plastic trim at the front of the radio cavity and push it out of the way, to the back of the dash. Cut and remove the plastic sub-dash at the front of the radio cavity. (Fig. 7.0)

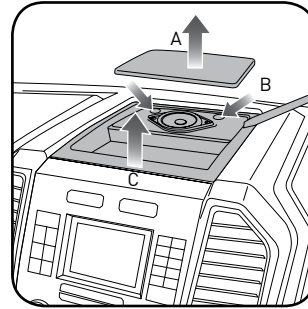

Fig. 1.0

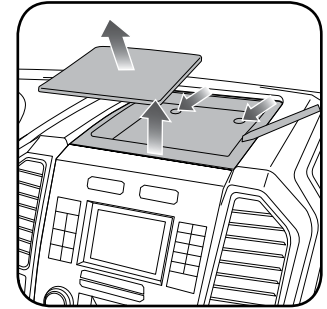

Fig. 1.1

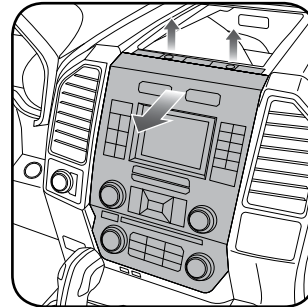

Fig. 2.0

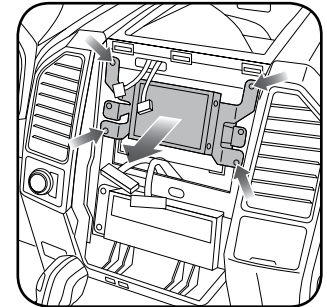

Fig. 3.0

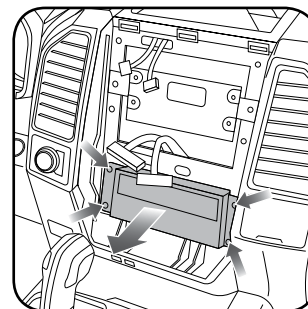

Fig. 4.0

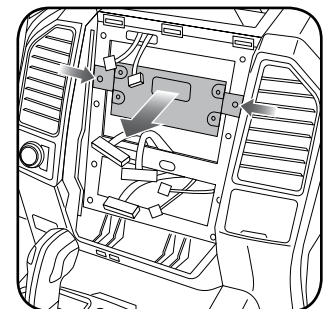

Fig. 5.0

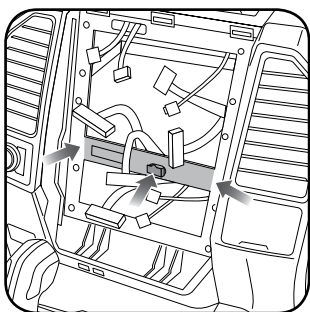

Fig. 7.0

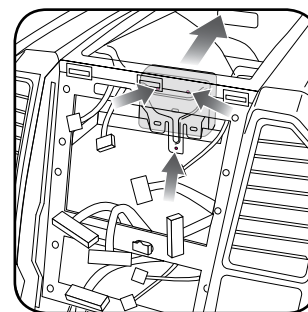

Fig. 6.0

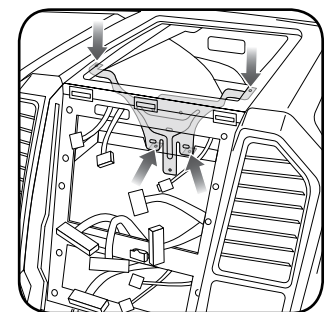

Fig. 6.1

INSTALLATION INSTRUCTIONS *NOT RETAINING SYNC

RADIO BEZEL DISASSEMBLY

Note: Save all of the screws from the disassembly and separate them by length, short and long, many of these screws will be used to assemble the FTR-1 kit.

1. Remove the hazard and traction control buttons by depressing the release tabs. (Fig. 1.0)
2. Remove the T10 screws from the back of the factory dash panel. (Fig. 2.0)
Remove the back cover of the bezel. (Fig. 2.0)
3. Remove the (4) ribbon cables from the circuit boards on the factory panel (gently push on the white release tabs and gently pull on the cables to detach them). (Fig. 3.0)
4. Remove the T10 screws from the climate circuit board. Remove the circuit board; set the board and screws aside. (Fig. 4.0)
5. Remove the fan speed and temperature control knobs, the HVAC buttons and rubber button pad. (Fig. 5.0)
6. Remove T10 screws from the controller board, the middle circuit board on the bezel. Remove the middle circuit board and set aside. The rubber buttons will not be used for this installation; set them aside to be saved with the OEM parts. (Fig. 6.0)

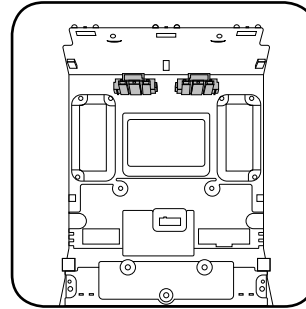

Fig. 1.0

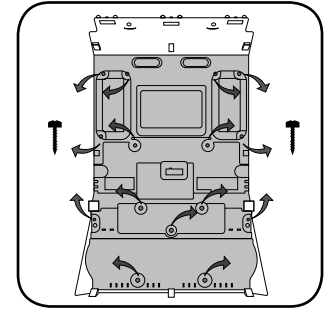

Fig. 2.0

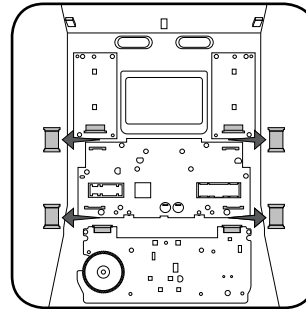

Fig. 3.0

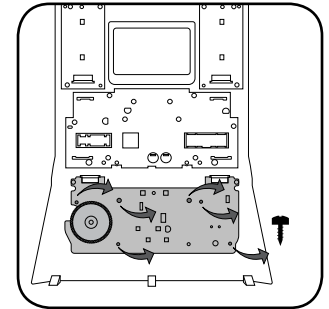

Fig. 4.0

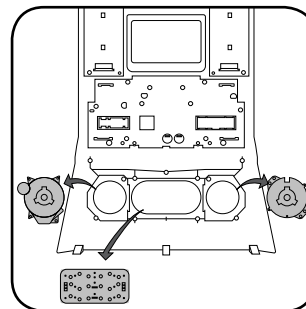

Fig. 5.0

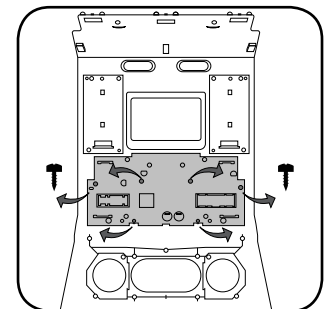

Fig. 6.0

INSTALLATION INSTRUCTIONS *NOT RETAINING SYNC

DASH KIT ASSEMBLY

When assembling the dash kit, be careful to use the correct length screws (use of too long of screw will puncture the front of the dash kit).

1. Set the plastic climate buttons into the FTR1 kit. Ensure the temperature control knob is in the center position, then install the temperature and fan knobs into the kit. (Fig. 1.0)
2. Install the climate circuit board (bottom board from the OEM dash panel) over the top of the climate knobs. Ensure that the black plastic gear that aligns with the temperature control is centered, just like the temperature knob (point the line on the big black gear toward the little gear (Fig. 2.0 A)). Use (4) short T10 screws to secure the climate circuit board to the dash kit (leave the 3 holes in the center of the board empty). (Fig. 2.0)
3. Install the new ribbon cables as shown (shiny side of the ribbon cable and the copper contacts at the end facing you). Insert them into the connector then push the latch to lock them into place. **Failure to correctly install the ribbon cables will cause the climate controls to not function at all.** (Fig. 3.0)
4. Feed the ribbon cable through the holes on the back of the housing cover for the climate unit. Use (3) long T10 screws and secure the FTR1 back cover of the climate board. (Fig. 4.0)
5. Install the ribbon cables shiny side down, to the bottom ports of the control board then seat the second control board to the back of the climate portion of the dash kit. (Fig. 5.0 and 5.1)
Secure this board to the dash kit with (6) short T10 screws. Note: Make sure the ribbon cables are not obstructing the screw holes on the sides. (Fig. 5.1)
6. Put the second FTR1 plastic cover on the control board and secure it at the sides and bottom with (3) long T10 screws. (Fig. 6.0)
7. Insert the hazard and traction control buttons in the holes in the top of the dash kit. (Fig. 7.0)
8. Insert and fix the storage pocket at the bottom of the dash panel, using provided screws. (Fig. 7.0 (A))

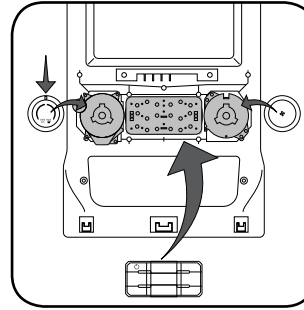

Fig. 1.0

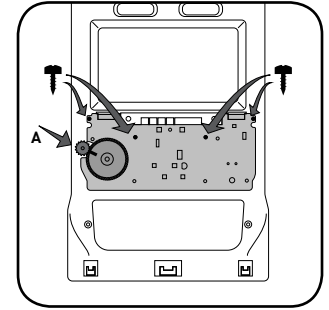

Fig. 2.0

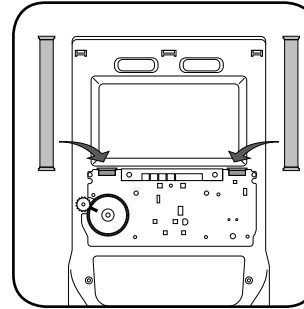

Fig. 3.0

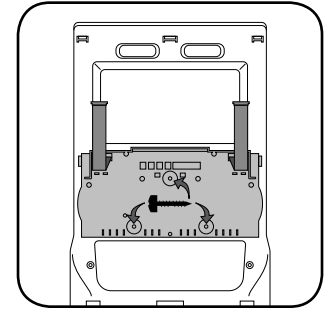

Fig. 4.0

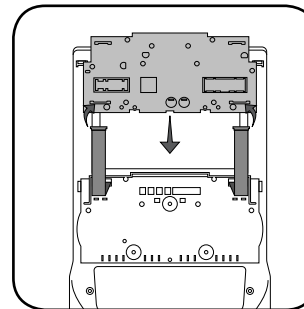

Fig. 5.0

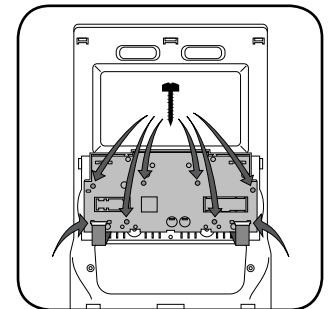

Fig. 5.1

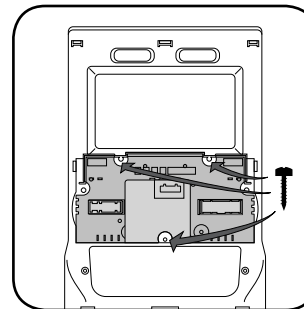

Fig. 6.0

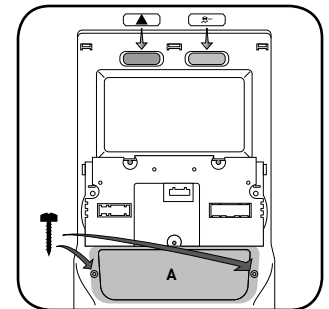

Fig. 7.0

INSTALLATION INSTRUCTIONS *NOT RETAINING SYNC

DASH KIT ASSEMBLY

- Unbox the aftermarket radio and mount it to the brackets included with the FTR1 kit (use the holes marked "1" for proper placement of the new radio) . (Fig. 8.0)
- If the camera module is present, mount it to the supplied mounting bracket using (3) M6 bolts and washers included with the FTR1 kit. Connect it. Insert in dash (area where OEM radio was) and secure it with (4) 7mm screws. (Fig. 9.0)

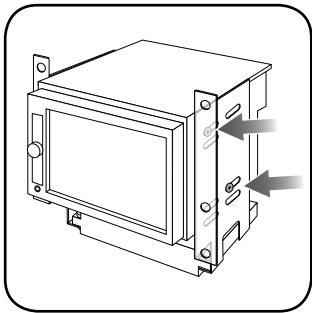

Fig. 8.0

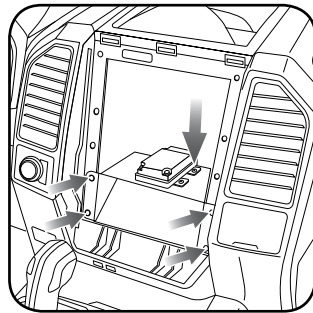

Fig. 9.0

MAKE CONNECTIONS (refer to wiring diagram)

- Locate the aftermarket radio's main harness. Connect the wires from the aftermarket radio's main harness to the FTR1 t-harness and match the wire functions (refer to diagram).
- Connect the FTR1 T-harness to the factory radio harness. Plug the backup camera cable into the factory harness (if applicable).
- Plug the FTR1 cable into the OEM Sync module harness. Connect the BLACK 2-pin connector of this cable to the BLACK 2-pin on the FTR1 T-harness. Connect the BLACK wire to ground. The backup camera RCA plug of this cable is not connected.
- Connect all harnesses to the Maestro RR module.
- Plug the aftermarket radio harnesses into the aftermarket radio. Plug the data cable to the data port of the aftermarket radio (port labeled iDataLink). Insert the Audio cable into the iDataLink 3.5 mm audio jack of the aftermarket radio (if there is no iDataLink audio input, connect to AUX). Plug the backup camera RCA into the aftermarket radio (if applicable).

Note: On Pioneer radio, ensure that there is nothing plugged into the W/R port.

- Insert the radio into the dash and secure the metal brackets with (4) 7mm bolts. (Fig. 1.0)
- Connect all the harnesses to the FTR1 kit, and secure it in the dash. Test your installation before completely re-assembling the bezel to the truck. (Fig. 2.0)

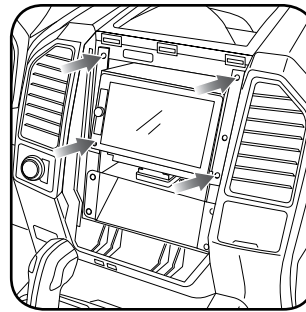

Fig. 1.0

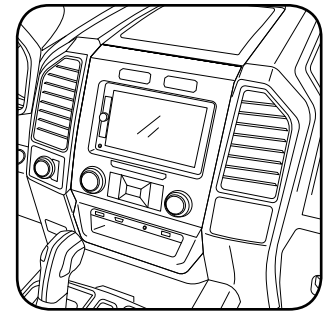
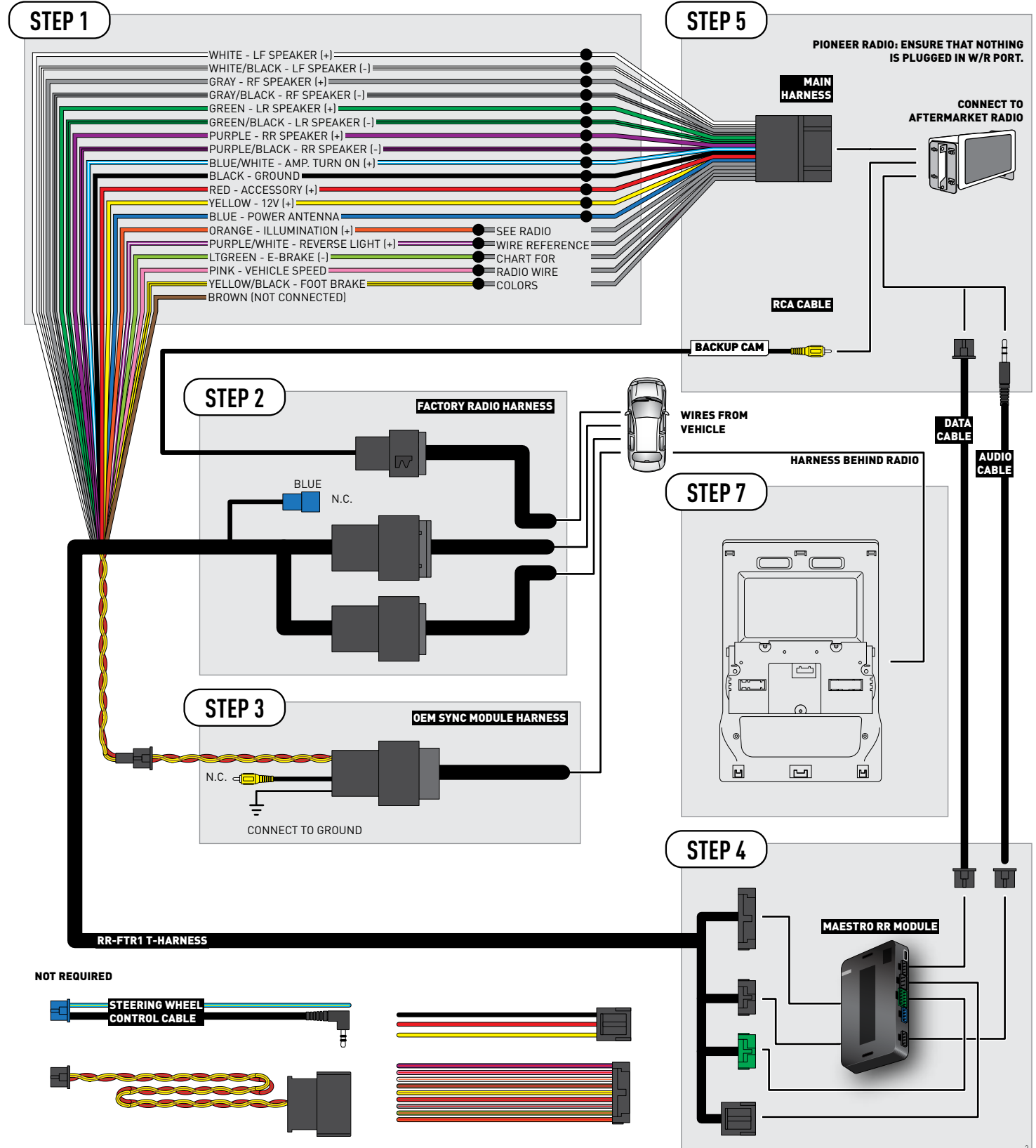

Fig. 2.0

WIRING DIAGRAM *NOT RETAINING SYNC



RADIO WIRE REFERENCE CHART

Wire Description	Polarity	Wire Color on Maestro T-Harness	Wire Color on Alpine cable	Wire Color on Kenwood cable	Wire Color on Pioneer cable
Illumination	(+)	Orange	N/A	Orange/White	Orange/White
Reverse Light	(+)	Purple/White	Orange/White	Purple/White	Purple/White
E-Brake	(-)	Lt Green	Yellow/Blue	Lt Green	Lt Green
Foot Brake	(+)	Yellow/Black	Yellow/Black	N/A	N/A
VSS (vehicle speed sensor)	(DATA)	Pink	Green/White	Pink	Pink
Power Antenna	(+)	Blue	Blue	Blue	N/A

TROUBLESHOOTING TABLE

PROBLEM	SOLUTION
Gauges do not work, radio shows OBD2 Error 1 or Error 2.	<p>Ensure OBDII connector is securely attached to the OBDII connector of the vehicle.</p> <p>If you hardwired connections at the OBDII, check connections at the OBDII connector. Make sure the RED/ BROWN wire is on PIN 6 and the YELLOW/ BROWN wire is connected to PIN 14 of the OBDII connector. Do not use T-Taps. Soldering or military splicing methods are recommended.</p> <p>Reset the RR.</p>
There is no sound from OEM sources like Sync.	<p>Ensure the all black, 3-pin to 3.5mm audio cable is connected between the RR and the radio. Make sure it is in the correct radio input.</p>
The climate controls do not work.	<p>Re-check the climate control assembly. Ensure the ribbon cables are not installed backward.</p>
There is no image from the backup camera.	<p>Ensure that the yellow RCA is plugged into the correct port on the radio.</p> <p>Ensure the 12-pin connector from the 4.3" factory screen is plugged into the 12 pin plug of the FTR1 T-harness.</p> <p>*Some vehicles get the backup camera video from the Sync connector (54-pin) instead. Plug this connector to the supplied 54-pin connector of the FTR1 T-harness.</p>
The light on the Maestro is flashing RED ONCE .	<p>There is no firmware on the module; flash the RR module.</p>
The light on the Maestro is blinking RED TWICE .	<p>Ensure the 4-pin data cable is connected between the radio and the RR, and that it is plugged into the black port on the Maestro RR. The red and blue ports on the RR should be empty.</p> <p>Make sure the correct radio model and serial number were entered during the flash. Verify the radio's serial number entered during the flash matches what is listed on the radio screen. This can be found in the settings of the radio, listed as Device Id, Device Number, or Serial Number.</p>

MAESTRO RR RESET PROCEDURE:

Turn the key to the OFF position, then disconnect all connectors from the module.

Press and hold the module's programming button and connect all the connectors back to the module. Wait, the module's LED will flash RED rapidly (this may take up to 10 seconds).

Release the programming button. Wait, the LED will turn solid GREEN for 2 seconds to show the reset was successful.

TECHNICAL ASSISTANCE

Phone: 1-866-427-2999

Email: maestro.support@idatalink.com

Web: maestro.idatalink.com/support add www.12voltdata.com/forum/

IMPORTANT: To ensure proper operation, the aftermarket radio needs to have the latest firmware from the manufacturer. Please visit the radio manufacturer's website and look for any updates pertaining to your radio.

LIMITED 1-YEAR WARRANTY

Automotive Data Solutions Inc. ("ADS") warrants to the original purchaser that this product shall be free of defects in material and workmanship under normal use and circumstances, for the period of one (1) year as of the original date of purchase.

In the event of any product malfunction during the Warranty period, the original purchaser must return to the Authorized Dealer where it was originally purchased with the original proof of purchase. If a malfunction is detected, the Authorized Dealer will elect to repair or replace the product at its discretion. Labor costs may be applicable and are at the discretion of the Authorized Dealer.

ADS is not responsible for any damages whatsoever, including but not limited to any consequential damages, incidental damages for loss of time, loss of earnings, commercial loss of economic opportunity and the like that may or may not have resulted from the installation or operation of an iDataLink Maestro product.

GARANTIE LIMITÉE DE 1 AN

Automotive Data Solutions Inc. (ADS) garantit à l'acheteur original que ce produit est exempt de défauts dans les matériaux et dans la fabrication, et ce, dans des conditions normales d'utilisation, pour une période de un (1) an à partir de la date d'achat originale.

Si le produit ne fonctionne pas correctement alors qu'il est encore sous garantie, l'acheteur original doit retourner chez le détaillant autorisé où il a acheté son produit avec la preuve d'achat originale. Si le détaillant autorisé détecte une quelconque anomalie, il réparera ou de remplacera le produit, et ce, à sa discrétion. Des frais de main d'oeuvre peuvent s'appliquer et sont à la discrétion du détaillant autorisé.

ADS n'accepte aucune responsabilité pour tout dommage, y compris, sans s'y limiter, aux dommages consécutifs, dommages indirects, dommages pour pertes de temps, pour pertes de revenus, pour pertes commerciales, pour pertes de possibilités économiques qui pourraient ou non avoir résulté de l'installation ou du fonctionnement d'un produit iDataLink Maestro.

iDataLink
maestro

GARANTÍA LIMITADA POR 1 AÑO

Automotive Data Solutions Inc. ("ADS") garantiza al comprador original que este producto no presentará ningún defecto relacionado con sus materiales o su fabricación, bajo condiciones normales de uso, durante un (1) año a partir de la fecha original de compra.

En caso de que el producto presente alguna falla durante el período de Garantía, el comprador original deberá remitirse al Distribuidor Autorizado donde lo compró, llevando consigo la prueba de compra original. Si se determina que el producto presenta una falla, el Distribuidor Autorizado podrá decidir si reparará o reemplazará el producto, según su criterio. Si esta situación genera costos por mano de obra, estos responderán al criterio del Distribuidor Autorizado.

ADS no se hace responsable por ningún tipo de daños, incluyendo, pero sin limitarse a, daños consecuenciales, daños indirectos producto de la pérdida de tiempo, la pérdida de ingresos, la pérdida comercial de una oportunidad económica y otros similares que puedan haber resultado o no de la instalación de un producto iDataLink Maestro.



iDataLink
maestro

NEED HELP? BESOIN D'AIDE? ¿NECESITA AYUDA?

☎ 877.212.6169

ADS
AUTOMOTIVE DATA SOLUTIONS

iDataLink
maestro

QUICK START GUIDE FOR CAR RADIO INSTALLATION KITS

GUIDE DE DÉMARRAGE RAPIDE POUR KITS D'INSTALLATION AUTORADIO

GUÍA DE INICIO RÁPIDO PARA KITS DE INSTALACIÓN DE AUTORRADIO

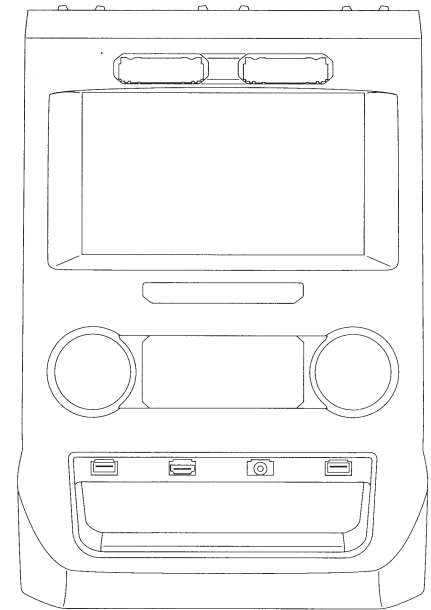

2017/09

ADS
AUTOMOTIVE DATA SOLUTIONS

WEB-PROGRAMMING STEPS

 THIS PRODUCT REQUIRES THE INSTALLATION OF A MAESTRO RR (ADS-MRR) MODULE SOLD SEPARATELY

- 1 INSTALL THE WEBLINK PLUGIN (FOR PC ONLY)**
Go to idatalinkmaestro.com/plugin and follow the installation steps. Review the System Requirements before installing. **Macintosh not supported.**
- 2 REGISTER A WEBLINK ACCOUNT**
Go to idatalinkmaestro.com/register and complete the registration process. A confirmation email will be sent to you requiring validation.
- 3 CONNECT THE MODULE TO YOUR PC**
Use the included mini USB cable to connect your iDataLink Maestro RR module to your PC.
- 4 WEBLINK PROGRAMMING**
Go to idatalinkmaestro.com/login. Enter your username and password, then click OK. Follow the installation steps in Weblink until your module is flashed, then download your install guide. **Be sure to select the dash kit as an accessory in step 4.**
- 5 COMPLETE VEHICLE-SPECIFIC INSTALLATION**
Follow the steps in your install guide and complete the installation. **ADS recommends having your iDataLink Maestro products installed by a certified technician.**

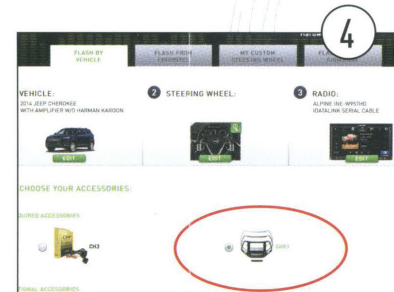
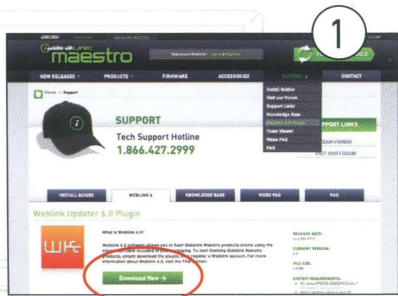

ÉTAPES DE PROGRAMMATION WEB

 CE PRODUIT NÉCESSITE L'INSTALLATION D'UN MODULE MAESTRO RR (ADS-MRR) VENDU SÉPARÉMENT

- 1 INSTALLEZ LE PLUGIN WEBLINK (PC SEULEMENT)**
Allez à idatalinkmaestro.com/plugin et suivez les étapes d'installation. Vérifiez les exigences système avant l'installation. **Macintosh n'est pas supporté.**
- 2 INSCRIVEZ-VOUS À WEBLINK**
Allez à idatalinkmaestro.com/register et terminez le processus d'inscription. Un courriel de confirmation vous sera envoyé pour validation.
- 3 BRANCHEZ LE MODULE À VOTRE PC**
Utilisez le mini-câble USB fourni pour brancher votre module iDataLink Maestro RR à votre PC.
- 4 PROGRAMMATION WEBLINK**
Allez à idatalinkmaestro.com/login. Entrez votre nom d'utilisateur et votre mot de passe, puis cliquez sur OK. Suivez les étapes d'installation dans Weblink jusqu'à ce que votre module soit flashé, puis téléchargez votre guide d'installation. **Assurez-vous de sélectionner le kit de tableau de bord comme accessoire à l'étape 4.**
- 5 INSTALLATION COMPLÈTE DU VÉHICULE**
Suivez les étapes de votre guide d'installation et terminez l'installation. **ADS recommande que vos iDataLink Maestro soient installés par un technicien certifié.**

PASOS DE PROGRAMACIÓN WEB

 ESTE PRODUCTO REQUIERE LA INSTALACIÓN DEL MÓDULO MAESTRO RR (ADS-MRR) VENDIDO POR SEPARADO

- 1 INSTALE EL COMPLEMENTO WEBLINK (SÓLO PC)**
Vaya a idatalinkmaestro.com/plugin y siga los pasos de instalación. Compruebe los requisitos del sistema antes de la instalación. **Macintosh no es compatible.**
- 2 REGÍSTRESE A WEBLINK**
Vaya a idatalinkmaestro.com/register y complete el proceso de registro. Se le enviará un correo electrónico de confirmación para su validación.
- 3 CONECTE EL MÓDULO A SU PC**
Utilice el cable mini USB suministrado para conectar su módulo iDataLink Maestro RR a su PC.
- 4 PROGRAMACIÓN WEBLINK**
Vaya a idatalinkmaestro.com/login. Introduzca su nombre de usuario y contraseña y haga clic en OK. Siga los pasos de instalación en Enlace web hasta que su módulo se muestra, luego descargue la guía de instalación. **Asegúrese de seleccionar el kit del panel de instrumentos como accesorio en el paso 4.**
- 5 INSTALACIÓN COMPLETA PARA SU VEHÍCULO**
Siga los pasos de la guía de instalación y complete la instalación. **ADS recomienda que su productos iDataLink Maestro sea instalado por un técnico certificado.**

2018-2020

FORD F-SERIES SUPER DUTY
NOT RETAINING SYNC WITH MYFORD 4.3" SCREEN

RETAINS STEERING WHEEL CONTROLS, BACKUP CAMERA AND MORE!



PRODUCTS REQUIRED

iDatalink Maestro RR or RR2 Radio Replacement Interface
iDatalink Maestro FTR1 Dash Kit

PROGRAMMED FIRMWARE

ADS-RR(SR)-F02B-DS

ADDITIONAL RESOURCES

[Maestro RR2 Programmable Outputs Guide](#)

OPTIONAL ACCESSORIES

K40[™]
ELECTRONICS
ESCORT

HRN-ANT-SAT1

Click here for:
[Radar Installation Guides](#)

WELCOME

Congratulations on the purchase of your iDatalink Maestro RR Radio replacement solution. You are now a few simple steps away from enjoying your new car radio with enhanced features.

Before starting your installation, please ensure that your iDatalink Maestro module is programmed with the correct firmware for your vehicle and that you carefully review the install guide.

Please note that Maestro RR will only retain functionalities that were originally available in the vehicle.

NEED HELP?

 1 866 427-2999

 maestro.support@idatalink.com

 maestro.idatalink.com/support
www.12voltdata.com/forum

TABLE OF CONTENTS

Installation Instructions	3
Wiring Diagram	7
Radio Wire Reference Chart	8
Troubleshooting Table	9

INSTALLATION INSTRUCTIONS *NOT RETAINING SYNC

DASH DISASSEMBLY

1. If the vehicle is equipped with a center channel speaker: Pop the speaker grille up (A), unscrew (2) 7mm bolts from the tray (B), and remove it (C). (Fig. 1.0)
If there is no center channel speaker: lift the rubber mat at the top of the dash (A), then remove (2) 7mm bolts from the tray (B), and remove it (C). (Fig. 1.1)
2. Remove the (2) 7mm bolts from the top of the radio panel. Unclip the radio bezel, unplug its connectors, and remove the panel. (Fig. 2.0)
3. Remove the 7mm screws securing the factory screen and disconnect it. (Fig. 3.0)
4. Remove the (4) 7mm screws securing the radio module, then unplug and remove it. (Fig. 3.0)
5. If the camera module is present, remove the (3) 10mm nuts securing it and remove the module. (Fig.4.0)
Looking down, from the top of the dash, locate the (2) 8mm bolts securing the camera module's bracket and remove them. Remove the (2) 7mm bolts under the plastic of the top of the dash (bolts aren't visible). Work the metal bracket free from the sub-dash and remove it. (Fig. 4.1)
Note: the bracket may be cut but this will prevent re-installing OEM equipment.
6. Unclip the factory harness that is secured to the plastic trim at the front of the radio cavity and push it out of the way, to the back of the dash. Cut and remove the plastic sub-dash at the front of the radio cavity. (Fig. 5.0)

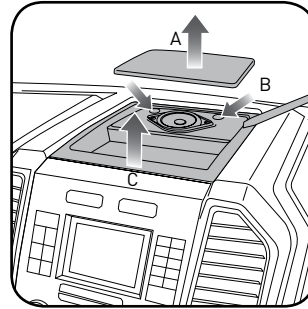

Fig. 1.0

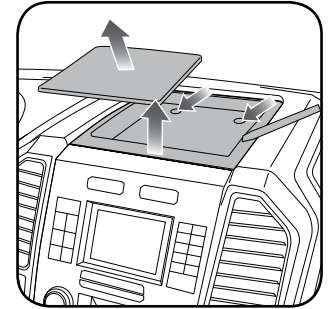

Fig. 1.1

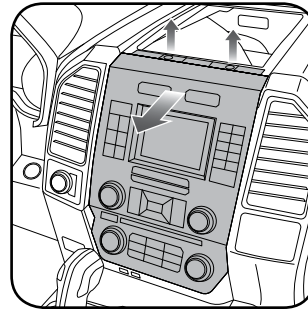

Fig. 2.0

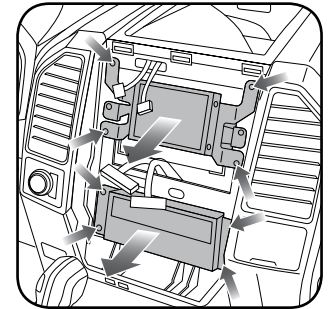

Fig. 3.0

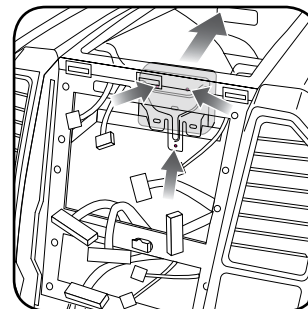

Fig. 4.0

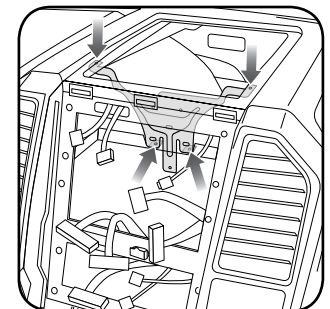

Fig. 4.1

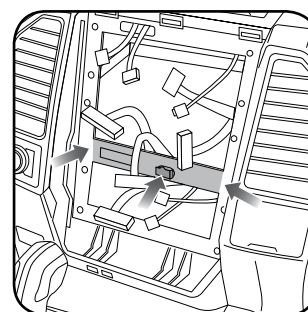

Fig. 5.0

INSTALLATION INSTRUCTIONS *NOT RETAINING SYNC

RADIO BEZEL DISASSEMBLY

Note: Save all of the screws from the disassembly and separate them by length, short and long, many of these screws will be used to assemble the FTR-1 kit.

1. Remove the hazard and traction control buttons by depressing the release tabs. (Fig. 1.0)
2. Remove the T10 screws from the back of the factory dash panel. (Fig. 2.0)
Remove the back cover of the bezel. (Fig. 2.0)
3. Remove the (4) ribbon cables from the circuit boards on the factory panel (gently push on the white release tabs and gently pull on the cables to detach them). (Fig. 3.0)
4. Remove the T10 screws from the climate circuit board. Remove the circuit board; set the board and screws aside. (Fig. 4.0)
5. Remove the fan speed and temperature control knobs, the HVAC buttons and rubber button pad. (Fig. 5.0)
6. Remove T10 screws from the controller board, the middle circuit board on the bezel. Remove the middle circuit board and set aside. The rubber buttons will not be used for this installation; set them aside to be saved with the OEM parts. (Fig. 6.0)

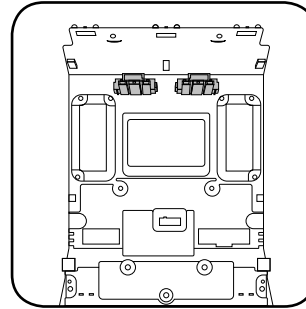

Fig. 1.0

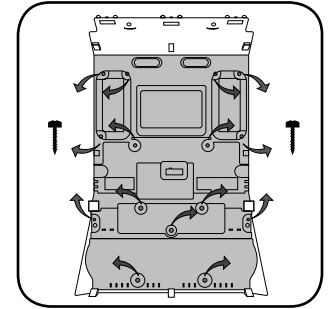

Fig. 2.0

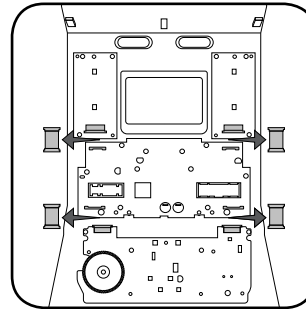

Fig. 3.0

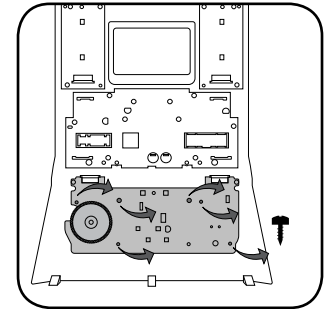

Fig. 4.0

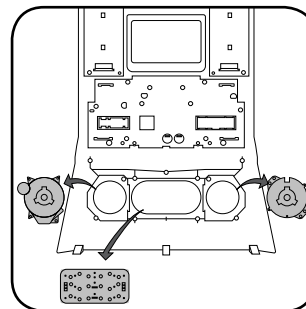

Fig. 5.0

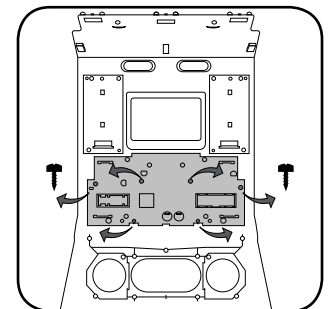

Fig. 6.0

INSTALLATION INSTRUCTIONS *NOT RETAINING SYNC

DASH KIT ASSEMBLY

When assembling the dash kit, be careful to use the correct length screws (use of too long of screw will puncture the front of the dash kit).

1. Set the plastic climate buttons into the FTR1 kit. Ensure the temperature control knob is in the center position, then install the temperature and fan knobs into the kit. (Fig. 1.0)
2. Install the climate circuit board (bottom board from the OEM dash panel) over the top of the climate knobs. Ensure that the black plastic gear that aligns with the temperature control is centered, just like the temperature knob (point the line on the big black gear toward the little gear (Fig. 2.0 A)). Use (4) short T10 screws to secure the climate circuit board to the dash kit (leave the 3 holes in the center of the board empty). (Fig. 2.0)
3. Install the new ribbon cables as shown (shiny side of the ribbon cable and the copper contacts at the end facing you). Insert them into the connector then push the latch to lock them into place. **Failure to correctly install the ribbon cables will cause the climate controls to not function at all.** (Fig. 3.0)
4. Feed the ribbon cable through the holes on the back of the housing cover for the climate unit. Use (3) long T10 screws and secure the FTR1 back cover of the climate board. (Fig. 4.0)
5. Install the ribbon cables shiny side down, to the bottom ports of the control board then seat the second control board to the back of the climate portion of the dash kit. (Fig. 5.0 and 5.1)
Secure this board to the dash kit with (6) short T10 screws. Note: Make sure the ribbon cables are not obstructing the screw holes on the sides. (Fig. 5.1)
6. Put the second FTR1 plastic cover on the control board and secure it at the sides and bottom with (3) long T10 screws. (Fig. 6.0)
7. Insert the hazard and traction control buttons in the holes in the top of the dash kit. (Fig. 7.0)
8. Insert and fix the storage pocket at the bottom of the dash panel, using provided screws. (Fig. 7.0 (A))

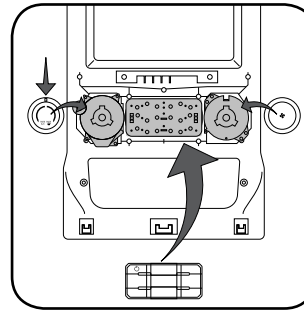

Fig. 1.0

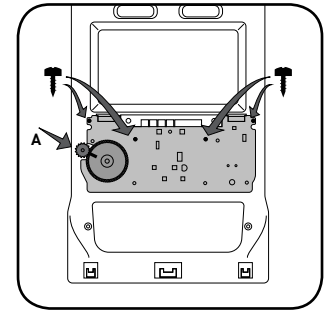

Fig. 2.0

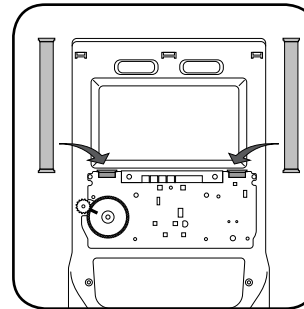

Fig. 3.0

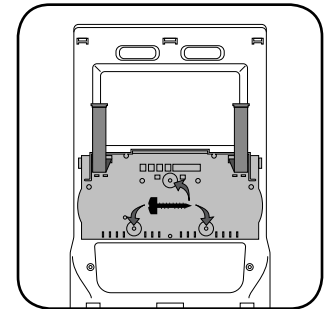

Fig. 4.0

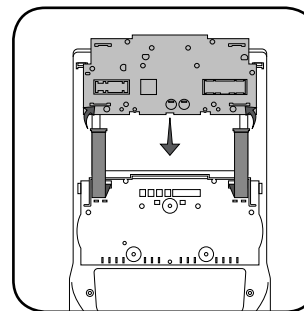

Fig. 5.0

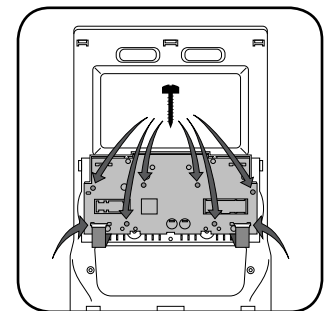

Fig. 5.1

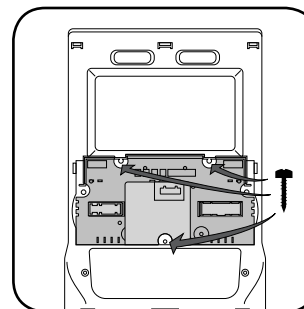

Fig. 6.0

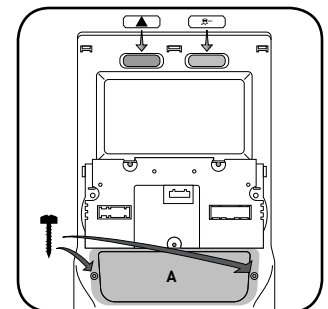

Fig. 7.0

3

INSTALLATION INSTRUCTIONS ***NOT RETAINING SYNC**

DASH KIT ASSEMBLY

- Unbox the aftermarket radio and mount it to the brackets included with the FTR1 kit (use the holes marked "1" for proper placement of the new radio) . (Fig. 8.0)
- If the camera module is present, mount it to the supplied mounting bracket using (3) M6 bolts and washers included with the FTR1 kit. Connect it. Insert in dash (area where OEM radio was) and secure it with (4) 7mm screws. (Fig. 9.0)

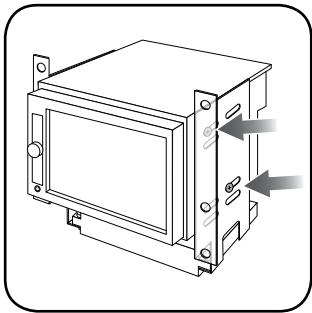

Fig. 8.0

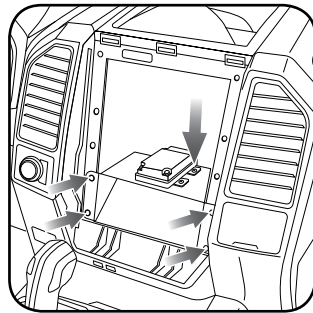

Fig. 9.0

Note: On Pioneer radio, ensure that there is nothing plugged into the W/R port.

- Insert the radio into the dash and secure the metal brackets with (4) 7mm bolts. (Fig. 1.0)
- Connect all the harnesses to the FTR1 kit, and secure it in the dash. Test your installation before completely re-assembling the bezel to the truck. (Fig. 2.0)

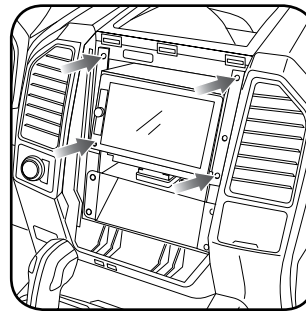

Fig. 1.0

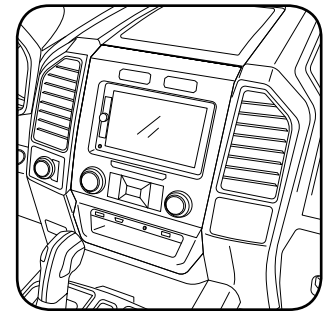
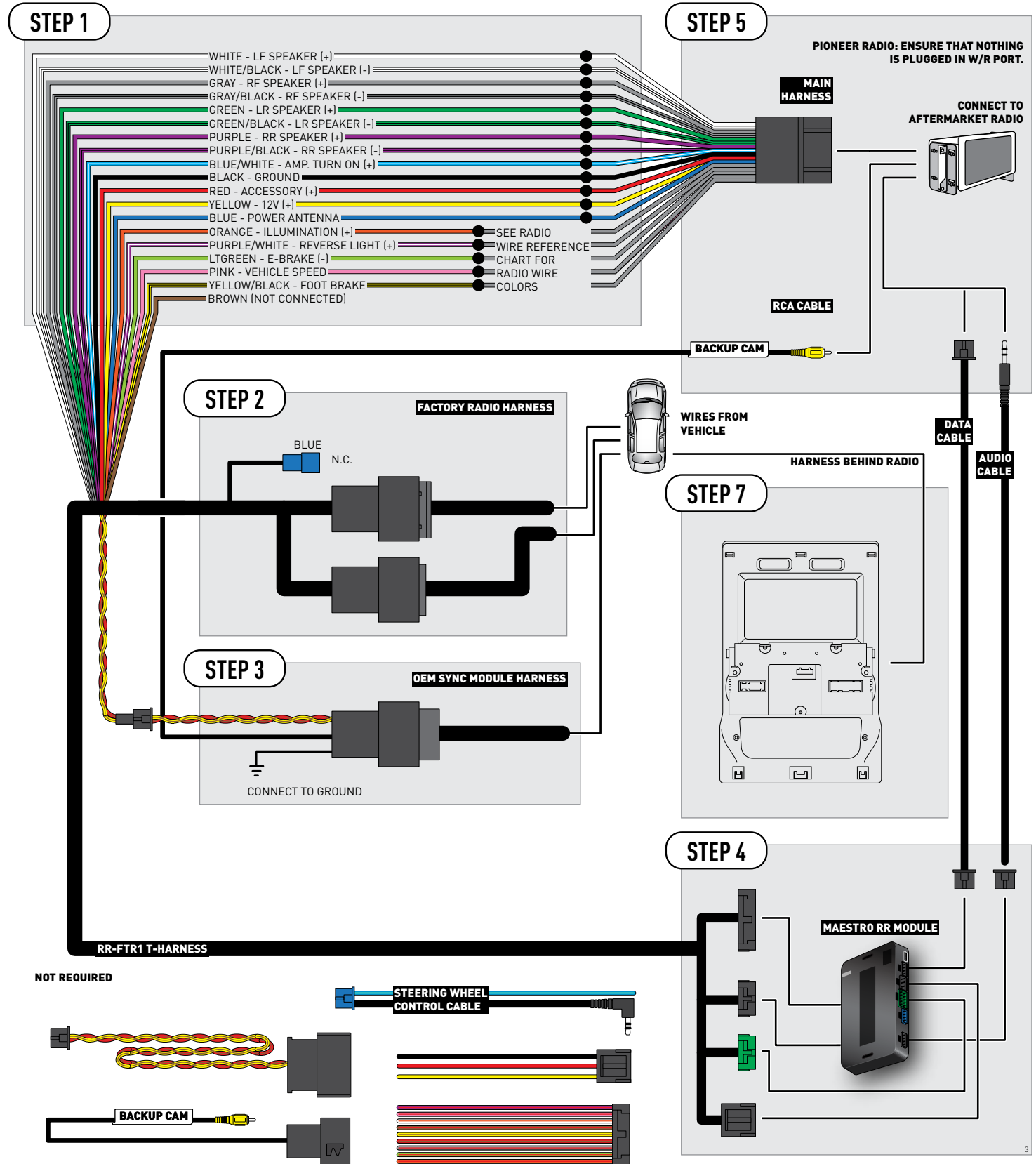

Fig. 2.0

MAKE CONNECTIONS (refer to wiring diagram)

- Locate the aftermarket radio's main harness. Connect the wires from the aftermarket radio's main harness to the FTR1 t-harness and match the wire functions (refer to diagram).
- Connect the FTR1 T-harness to the factory radio harness. Plug the backup camera cable into the factory harness (if applicable).
- Plug the FTR1 cable into the OEM Sync module harness. Connect the BLACK 2-pin connector of this cable to the BLACK 2-pin on the FTR1 T-harness. Connect the BLACK wire to ground.
- Connect all harnesses to the Maestro RR module.
- Plug the aftermarket radio harnesses into the aftermarket radio. Plug the data cable to the data port of the aftermarket radio (port labeled iDatalink). Insert the Audio cable into the iDatalink 3.5 mm audio jack of the aftermarket radio (if there is no iDatalink audio input, connect to AUX). Plug the backup camera RCA into the aftermarket radio from FTR1 cable (if applicable).

WIRING DIAGRAM *NOT RETAINING SYNC



RADIO WIRE REFERENCE CHART

Wire Description	Polarity	Wire Color on Maestro T-Harness	Wire Color on Alpine cable	Wire Color on Kenwood cable	Wire Color on Pioneer cable
Illumination	(+)	Orange	N/A	Orange/White	Orange/White
Reverse Light	(+)	Purple/White	Orange/White	Purple/White	Purple/White
E-Brake	(-)	Lt Green	Yellow/Blue	Lt Green	Lt Green
Foot Brake	(+)	Yellow/Black	Yellow/Black	N/A	N/A
VSS (vehicle speed sensor)	(DATA)	Pink	Green/White	Pink	Pink
Power Antenna	(+)	Blue	Blue	Blue	N/A

TROUBLESHOOTING TABLE

PROBLEM	SOLUTION
Gauges do not work, radio shows OBD2 Error 1 or Error 2.	<p>Ensure OBDII connector is securely attached to the OBDII connector of the vehicle.</p> <p>If you hardwired connections at the OBDII, check connections at the OBDII connector. Make sure the RED/ BROWN wire is on PIN 6 and the YELLOW/ BROWN wire is connected to PIN 14 of the OBDII connector. Do not use T-Taps. Soldering or military splicing methods are recommended.</p> <p>Reset the RR.</p>
There is no sound from OEM sources like Sync.	<p>Ensure the all black, 3-pin to 3.5mm audio cable is connected between the RR and the radio. Make sure it is in the correct radio input.</p>
The climate controls do not work.	<p>Re-check the climate control assembly. Ensure the ribbon cables are not installed backward.</p>
There is no image from the backup camera.	<p>Ensure that the yellow RCA is plugged into the correct port on the radio.</p> <p>Ensure the 54-pin connector is plugged into the 54-pin plug of the FTR1 T-harness.</p> <p>*Some vehicles get the backup camera video from the 12-pin connector that was plugged into the 4.3" screen instead. Plug this 12-pin connector to the 12-pin of the FTR1 T-harness. Also connect the vehicle's 54-pin connector to the FTR1 T-harness.</p>
The light on the Maestro is flashing RED ONCE .	<p>There is no firmware on the module; flash the RR module.</p>
The light on the Maestro is blinking RED TWICE .	<p>Ensure the 4-pin data cable is connected between the radio and the RR, and that it is plugged into the black port on the Maestro RR. The red and blue ports on the RR should be empty.</p> <p>Make sure the correct radio model and serial number were entered during the flash. Verify the radio's serial number entered during the flash matches what is listed on the radio screen. This can be found in the settings of the radio, listed as Device Id, Device Number, or Serial Number.</p>

MAESTRO RR RESET PROCEDURE:

Turn the key to the OFF position, then disconnect all connectors from the module.

Press and hold the module's programming button and connect all the connectors back to the module. Wait, the module's LED will flash RED rapidly (this may take up to 10 seconds).

Release the programming button. Wait, the LED will turn solid GREEN for 2 seconds to show the reset was successful.

TECHNICAL ASSISTANCE

Phone: 1-866-427-2999

Email: maestro.support@idatalink.com

Web: maestro.idatalink.com/support add www.12voltdata.com/forum/

IMPORTANT: To ensure proper operation, the aftermarket radio needs to have the latest firmware from the manufacturer. Please visit the radio manufacturer's website and look for any updates pertaining to your radio.

2017

FORD F-SERIES SUPER DUTY RETAINING SYNC WITH MYFORD 4.3" SCREEN

RETAINS STEERING WHEEL CONTROLS, BACKUP CAMERA AND MORE!



PRODUCTS REQUIRED

iDatalink Maestro RR or RR2 Radio Replacement Interface
iDatalink Maestro FTR1 Dash Kit

PROGRAMMED FIRMWARE

ADS-RR(SR)-F02B-DS

ADDITIONAL RESOURCES

[Maestro RR2 Programmable Outputs Guide](#)

OPTIONAL ACCESSORIES

K40[™]
ELECTRONICS
ESCORT

HRN-ANT-SAT1

Click here for:
[Radar Installation Guides](#)

WELCOME

Congratulations on the purchase of your iDatalink Maestro RR Radio replacement solution. You are now a few simple steps away from enjoying your new car radio with enhanced features.

Before starting your installation, please ensure that your iDatalink Maestro module is programmed with the correct firmware for your vehicle and that you carefully review the install guide.

Please note that Maestro RR will only retain functionalities that were originally available in the vehicle.

NEED HELP?

 1 866 427-2999

 maestro.support@idatalink.com

 maestro.idatalink.com/support
www.12voltdata.com/forum

TABLE OF CONTENTS

Installation Instructions	3
Wiring Diagram	7
Radio Wire Reference Chart	8
Troubleshooting Table	9

INSTALLATION INSTRUCTIONS *RETAINING SYNC

DASH DISASSEMBLY

1. If the vehicle is equipped with a center channel speaker: Pop the speaker grille up (A), unscrew (2) 7mm bolts from the tray (B), and remove it (C). (Fig. 1.0)
If there is no center channel speaker: lift the rubber mat at the top of the dash (A), then remove (2) 7mm bolts from the tray (B), and remove it (C). (Fig. 1.1)
2. Remove the (2) 7mm bolts from the top of the radio panel. Unclip the radio bezel, unplug its connectors, and remove the panel. (Fig. 2.0)
3. Remove the 7mm screws securing the factory screen and disconnect it. (Fig. 3.0)
4. Remove the (4) 7mm screws securing the radio module, then unplug and remove it. (Fig. 4.0)
5. Remove (2) 7mm screws securing the Sync module. Unplug and remove it. (Fig. 5.0)
6. If the camera module is present, remove the (3) 10mm nuts securing it and remove the module. (Fig. 6.0)
Looking down, from the top of the dash, locate the (2) 8mm bolts securing the camera module's bracket and remove them. Remove the (2) 7mm bolts under the plastic of the top of the dash (bolts aren't visible). Work the metal bracket free from the sub-dash and remove it. (Fig. 6.1)
Note: the bracket may be cut but this will prevent re-installing OEM equipment.
7. Unclip the factory harness that is secured to the plastic trim at the front of the radio cavity and push it out of the way, to the back of the dash. Cut and remove the plastic sub-dash at the front of the radio cavity. (Fig. 7.0)

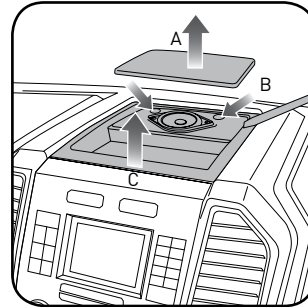

Fig. 1.0

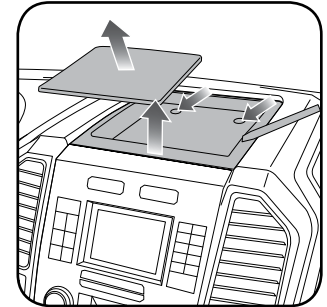

Fig. 1.1

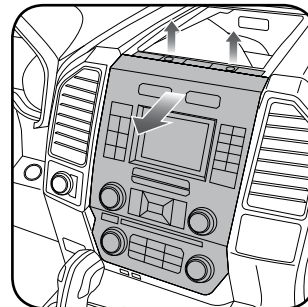

Fig. 2.0

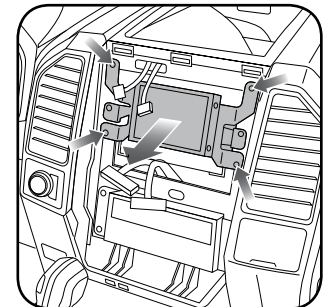

Fig. 3.0

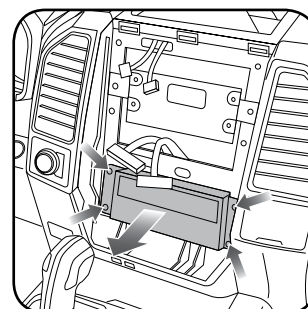

Fig. 4.0

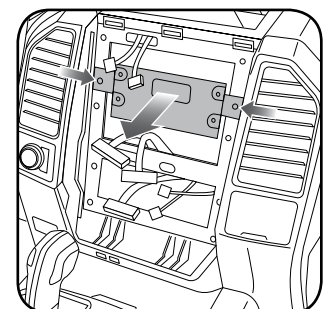

Fig. 5.0

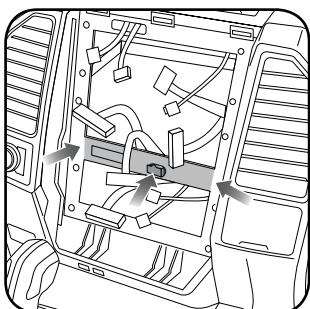

Fig. 7.0

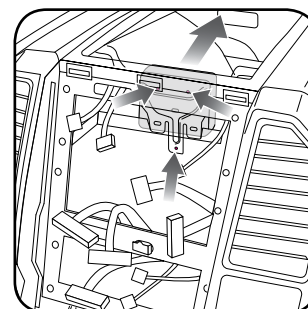

Fig. 6.0

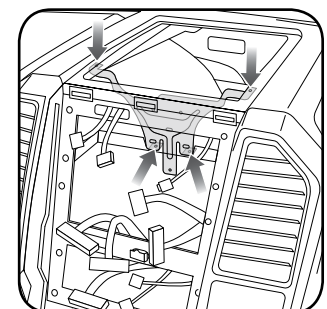

Fig. 6.1

INSTALLATION INSTRUCTIONS *RETAINING SYNC

RADIO BEZEL DISASSEMBLY

Note: Save all of the screws from the disassembly and separate them by length, short and long, many of these screws will be used to assemble the FTR-1 kit.

1. Remove the hazard and traction control buttons by depressing the release tabs. (Fig. 1.0)
2. Remove the T10 screws from the back of the factory dash panel. (Fig. 2.0)
Remove the back cover of the bezel. (Fig. 2.0)
3. Remove the (4) ribbon cables from the circuit boards on the factory panel (gently push on the white release tabs and gently pull on the cables to detach them). (Fig. 3.0)
4. Remove the T10 screws from the climate circuit board. Remove the circuit board; set the board and screws aside. (Fig. 4.0)
5. Remove the fan speed and temperature control knobs, the HVAC buttons and rubber button pad. (Fig. 5.0)
6. Remove T10 screws from the controller board, the middle circuit board on the bezel. Remove the middle circuit board and set aside. The rubber buttons will not be used for this installation; set them aside to be saved with the OEM parts. (Fig. 6.0)

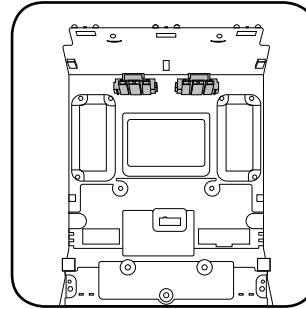

Fig. 1.0

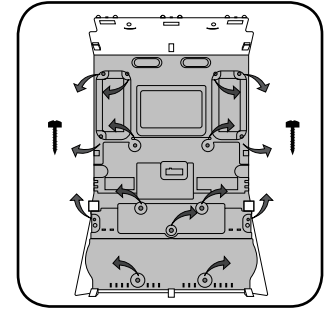

Fig. 2.0

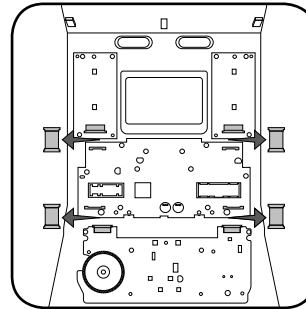

Fig. 3.0

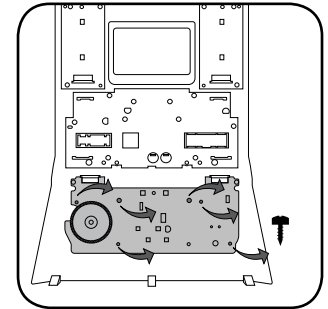

Fig. 4.0

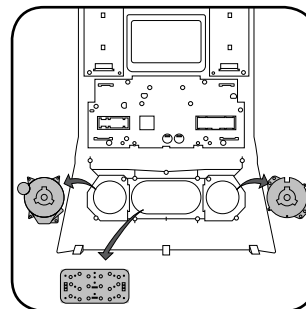

Fig. 5.0

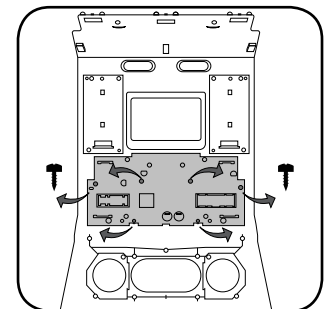

Fig. 6.0

INSTALLATION INSTRUCTIONS *RETAINING SYNC

DASH KIT ASSEMBLY

When assembling the dash kit, be careful to use the correct length screws (use of too long of screw will puncture the front of the dash kit).

1. Set the plastic climate buttons into the FTR1 kit. Ensure the temperature control knob is in the center position, then install the temperature and fan knobs into the kit. (Fig. 1.0)
2. Install the climate circuit board (bottom board from the OEM dash panel) over the top of the climate knobs. Ensure that the black plastic gear that aligns with the temperature control is centered, just like the temperature knob (point the line on the big black gear toward the little gear (Fig. 2.0 A)). Use (4) short T10 screws to secure the climate circuit board to the dash kit (leave the 3 holes in the center of the board empty). (Fig. 2.0)
3. Install the new ribbon cables as shown (shiny side of the ribbon cable and the copper contacts at the end facing you). Insert them into the connector then push the latch to lock them into place. **Failure to correctly install the ribbon cables will cause the climate controls to not function at all.** (Fig. 3.0)
4. Feed the ribbon cable through the holes on the back of the housing cover for the climate unit. Use (3) long T10 screws and secure the FTR1 back cover of the climate board. (Fig. 4.0)
5. Install the ribbon cables shiny side down, to the bottom ports of the control board then seat the second control board to the back of the climate portion of the dash kit. (Fig. 5.0 and 5.1)
Secure this board to the dash kit with (6) short T10 screws. Note: Make sure the ribbon cables are not obstructing the screw holes on the sides. (Fig. 5.1)
6. Put the second FTR1 plastic cover on the control board and secure it at the sides and bottom with (3) long T10 screws. (Fig. 6.0)
7. Insert the hazard and traction control buttons in the holes in the top of the dash kit. (Fig. 7.0)
8. Insert and fix the storage pocket at the bottom of the dash panel, using provided screws. (Fig. 7.0 A)

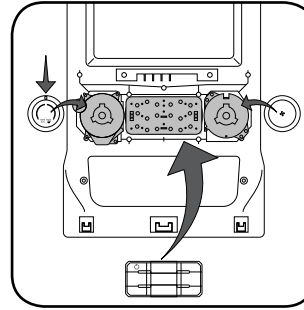

Fig. 1.0

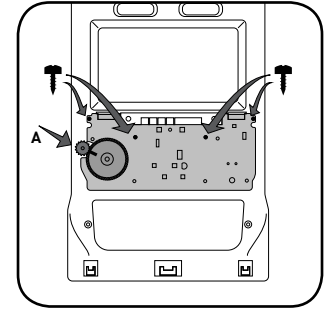

Fig. 2.0

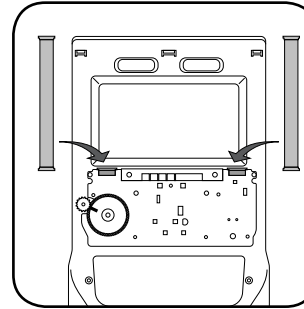

Fig. 3.0

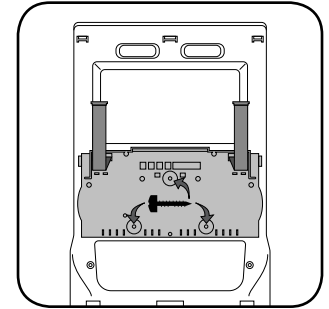

Fig. 4.0

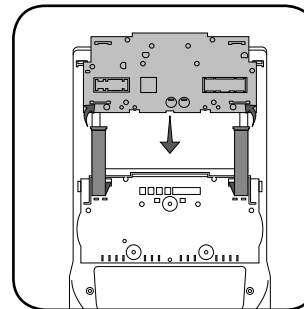

Fig. 5.0

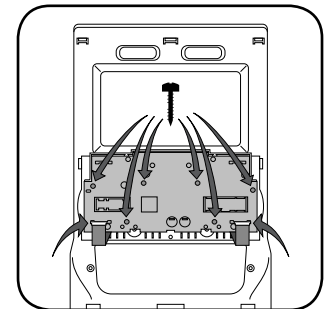

Fig. 5.1

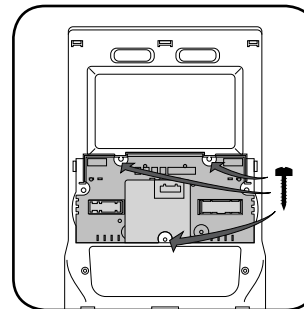

Fig. 6.0

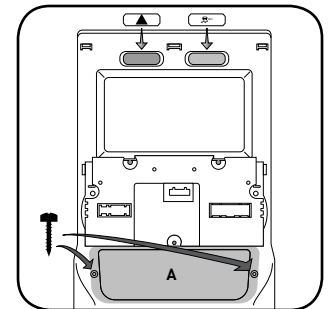

Fig. 7.0

INSTALLATION INSTRUCTIONS *RETAINING SYNC

DASH KIT ASSEMBLY

9. Unscrew the sync module from the factory brackets. (Fig. 8.0)
Mount the sync module using the supplied M5 bolts and washers to the brackets included with the FTR1 kit. (Fig. 8.1)
10. Unbox the aftermarket radio and mount it to the brackets (use the holes marked "1" for proper placement of the new radio) . (Fig. 8.2)
11. If the camera module is present, mount it to the supplied mounting bracket using (3) M6 bolts and washers included with the FTR1 kit. Connect it. Insert in dash (area where OEM radio was) and secure it with (4) 7mm screws. (Fig. 9.0)

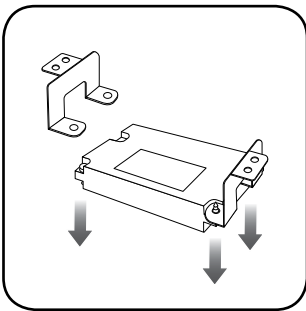

Fig. 8.0

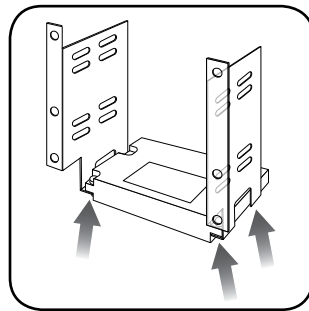

Fig. 8.1

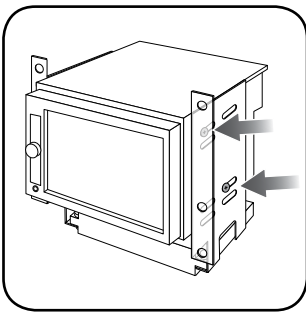

Fig. 8.2

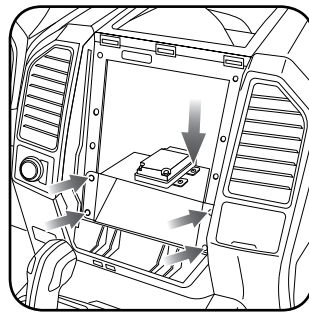

Fig. 9.0

Plug the backup camera cable into the factory harness (if applicable).

3. Plug the OBD2 connector into the OBD2 port of the vehicle, located under the driver side dash, and run the wires up to the radio cavity.
4. Connect all harnesses to the Maestro RR module.
5. Plug the aftermarket radio harnesses into the aftermarket radio. Plug the data cable to the data port of the aftermarket radio (port labeled iDatalink). Insert the Audio cable into the iDatalink 3.5 mm audio jack of the aftermarket radio (if there is no iDatalink audio input, connect to AUX). Plug the backup camera RCA into the aftermarket radio (if applicable).

Note: On Pioneer radio, ensure that there is nothing plugged into the W/R port.

6. Insert the radio and sync module into the dash and secure the metal brackets with (4) 7mm bolts. (Fig. 1.0)
7. Connect all the harnesses to the FTR1 kit, and secure it in the dash. Test your installation before completely re-assembling the bezel to the truck. (Fig. 2.0)

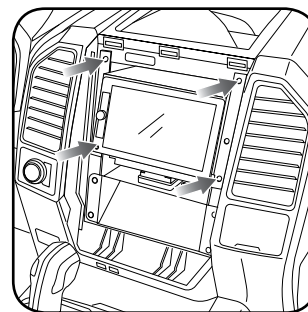

Fig. 1.0

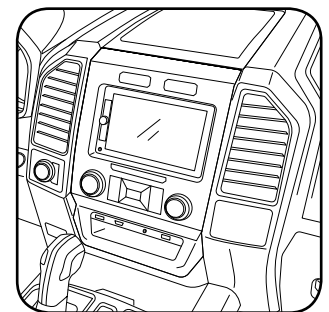

Fig. 2.0

MAKE CONNECTIONS (refer to wiring diagram)

1. Locate the aftermarket radio's main harness. Connect the wires from the aftermarket radio's main harness to the FTR1 t-harness and match the wire functions (refer to diagram).
2. Connect the FTR1 T-harness to the factory radio harness.

WIRING DIAGRAM *RETAINING SYNC

STEP 1

- WHITE - LF SPEAKER (+)
- WHITE/BLACK - LF SPEAKER (-)
- GRAY - RF SPEAKER (+)
- GRAY/BLACK - RF SPEAKER (-)
- GREEN - LR SPEAKER (+)
- GREEN/BLACK - LR SPEAKER (-)
- PURPLE - RR SPEAKER (+)
- PURPLE/BLACK - RR SPEAKER (-)
- BLUE/WHITE - AMP. TURN ON (+)
- BLACK - GROUND
- RED - ACCESSORY (+)
- YELLOW - 12V (+)
- BLUE - POWER ANTENNA
- ORANGE - ILLUMINATION (+)
- PURPLE/WHITE - REVERSE LIGHT (+)
- LTGREEN - E-BRAKE (-)
- PINK - VEHICLE SPEED
- YELLOW/BLACK - FOOT BRAKE
- BROWN (NOT CONNECTED)

STEP 5

PIONEER RADIO: ENSURE THAT NOTHING IS PLUGGED IN W/R PORT.

CONNECT TO AFTERMARKET RADIO

STEP 2

FACTORY RADIO HARNESS

STEP 3

OBDII CONNECTOR

STEP 7

HARNESS BEHIND RADIO

STEP 4

MAESTRO RR MODULE

NOT REQUIRED

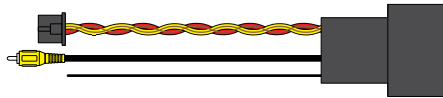

RR-FTR1 T-HARNESS

WIRES FROM VEHICLE

DATA CABLE

AUDIO CABLE

RCA CABLE

BACKUP CAM

RADIO WIRE REFERENCE CHART

Wire Description	Polarity	Wire Color on Maestro T-Harness	Wire Color on Alpine cable	Wire Color on Kenwood cable	Wire Color on Pioneer cable
Illumination	(+)	Orange	N/A	Orange/White	Orange/White
Reverse Light	(+)	Purple/White	Orange/White	Purple/White	Purple/White
E-Brake	(-)	Lt Green	Yellow/Blue	Lt Green	Lt Green
Foot Brake	(+)	Yellow/Black	Yellow/Black	N/A	N/A
VSS (vehicle speed sensor)	(DATA)	Pink	Green/White	Pink	Pink
Power Antenna	(+)	Blue	Blue	Blue	N/A

TROUBLESHOOTING TABLE

PROBLEM	SOLUTION
Gauges do not work, radio shows OBD2 Error 1 or Error 2.	<p>Ensure OBDII connector is securely attached to the OBDII connector of the vehicle.</p> <p>If you hardwired connections at the OBDII, check connections at the OBDII connector. Make sure the RED/ BROWN wire is on PIN 6 and the YELLOW/ BROWN wire is connected to PIN 14 of the OBDII connector. Do not use T-Taps. Soldering or military splicing methods are recommended.</p> <p>Reset the RR.</p>
There is no sound from OEM sources like Sync.	Ensure the all black, 3-pin to 3.5mm audio cable is connected between the RR and the radio. Make sure it is in the correct radio input.
The climate controls do not work.	Re-check the climate control assembly. Ensure the ribbon cables are not installed backward.
The light on the Maestro is flashing RED ONCE .	There is no firmware on the module; flash the RR module.
The light on the Maestro is blinking RED TWICE .	<p>Ensure the 4-pin data cable is connected between the radio and the RR, and that it is plugged into the black port on the Maestro RR. The red and blue ports on the RR should be empty.</p> <p>Make sure the correct radio model and serial number were entered during the flash. Verify the radio's serial number entered during the flash matches what is listed on the radio screen. This can be found in the settings of the radio, listed as Device Id, Device Number, or Serial Number.</p>

MAESTRO RR RESET PROCEDURE:

Turn the key to the OFF position, then disconnect all connectors from the module.
 Press and hold the module's programming button and connect all the connectors back to the module. Wait, the module's LED will flash RED rapidly (this may take up to 10 seconds).
 Release the programming button. Wait, the LED will turn solid GREEN for 2 seconds to show the reset was successful.

TECHNICAL ASSISTANCE

Phone: 1-866-427-2999

Email: maestro.support@idatalink.com

Web: maestro.idatalink.com/support add www.12voldata.com/forum/

IMPORTANT: To ensure proper operation, the aftermarket radio needs to have the latest firmware from the manufacturer. Please visit the radio manufacturer's website and look for any updates pertaining to your radio.

2015-2017

FORD F150

NOT RETAINING SYNC WITH MYFORD 4.3" SCREEN

RETAINS STEERING WHEEL CONTROLS, BACKUP CAMERA AND MORE!



PRODUCTS REQUIRED

iDatalink Maestro RR or RR2 Radio Replacement Interface
iDatalink Maestro FTR1 Dash Kit

PROGRAMMED FIRMWARE

ADS-RR(SR)-F02B-DS

ADDITIONAL RESOURCES

[Maestro RR2 Programmable Outputs Guide](#)

OPTIONAL ACCESSORIES

K40[™]
ELECTRONICS
ESCORT

HRN-ANT-SAT1

Click here for:
[Radar Installation Guides](#)

WELCOME

Congratulations on the purchase of your iDatalink Maestro RR Radio replacement solution. You are now a few simple steps away from enjoying your new car radio with enhanced features.

Before starting your installation, please ensure that your iDatalink Maestro module is programmed with the correct firmware for your vehicle and that you carefully review the install guide.

Please note that Maestro RR will only retain functionalities that were originally available in the vehicle.

NEED HELP?

 1 866 427-2999

 maestro.support@idatalink.com

 maestro.idatalink.com/support
www.12voltdata.com/forum

TABLE OF CONTENTS

Installation Instructions	3
Wiring Diagram	7
Radio Wire Reference Chart	8
Troubleshooting Table	9

INSTALLATION INSTRUCTIONS *NOT RETAINING SYNC

DASH DISASSEMBLY

1. If the vehicle is equipped with a center channel speaker: Pop the speaker grille up (A), unscrew (2) 7mm bolts from the tray (B), and remove it (C). (Fig. 1.0)
If there is no center channel speaker: lift the rubber mat at the top of the dash (A), then remove (2) 7mm bolts from the tray (B), and remove it (C). (Fig. 1.1)
2. Remove the (2) 7mm bolts from the top of the radio panel. Unclip the radio bezel, unplug its connectors, and remove the panel. (Fig. 2.0)
3. Remove the 7mm screws securing the factory screen and disconnect it. (Fig. 3.0)
4. Remove the (4) 7mm screws securing the radio module, then unplug and remove it. (Fig. 4.0)
5. Remove (2) 7mm screws securing the Sync module. Unplug and remove it. Note: Because sync is not being retained, the sync module does not need to be re-installed. (Fig. 5.0)
6. If the camera module is present, remove the (3) 10mm nuts securing it and remove the module. (Fig. 6.0)
Looking down, from the top of the dash, locate the (2) 8mm bolts securing the camera module's bracket and remove them. Remove the (2) 7mm bolts under the plastic of the top of the dash (bolts aren't visible). Work the metal bracket free from the sub-dash and remove it. (Fig. 6.1)
Note: the bracket may be cut but this will prevent re-installing OEM equipment.
7. Unclip the factory harness that is secured to the plastic trim at the front of the radio cavity and push it out of the way, to the back of the dash. Cut and remove the plastic sub-dash at the front of the radio cavity. (Fig. 7.0)

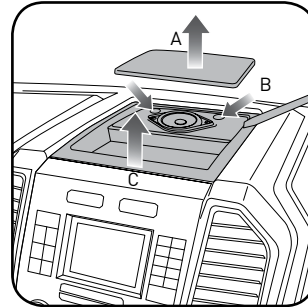

Fig. 1.0

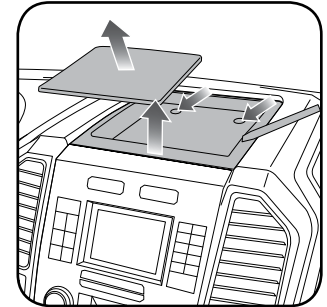

Fig. 1.1

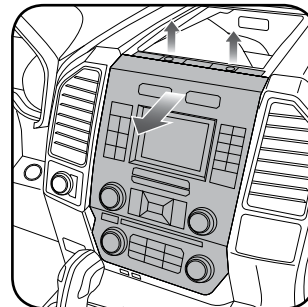

Fig. 2.0

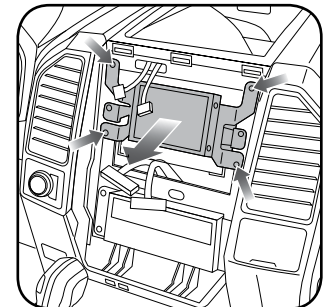

Fig. 3.0

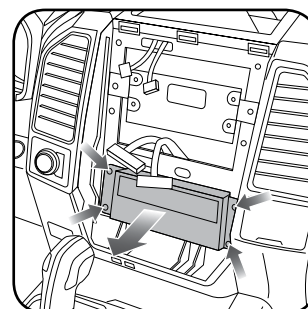

Fig. 4.0

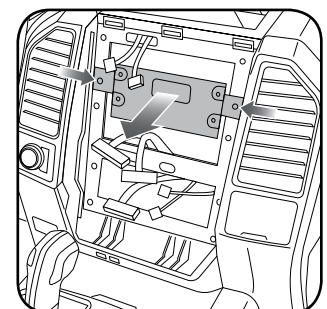

Fig. 5.0

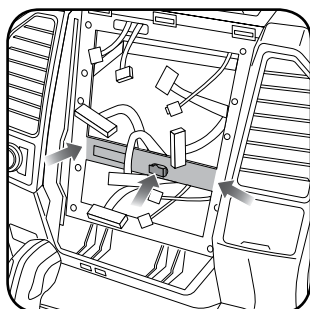

Fig. 7.0

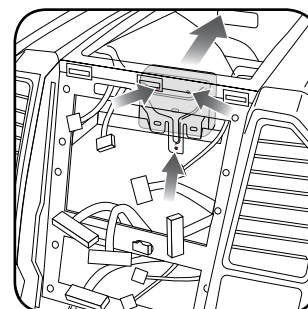

Fig. 6.0

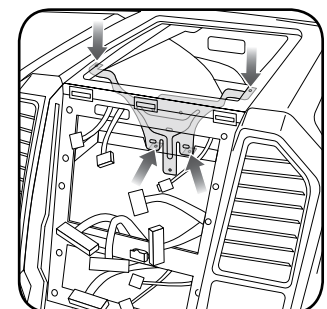

Fig. 6.1

INSTALLATION INSTRUCTIONS *NOT RETAINING SYNC

RADIO BEZEL DISASSEMBLY

Note: Save all of the screws from the disassembly and separate them by length, short and long, many of these screws will be used to assemble the FTR-1 kit.

1. Remove the hazard and traction control buttons by depressing the release tabs. (Fig. 1.0)
2. Remove the T10 screws from the back of the factory dash panel. (Fig. 2.0)
Remove the back cover of the bezel. (Fig. 2.0)
3. Remove the (4) ribbon cables from the circuit boards on the factory panel (gently push on the white release tabs and gently pull on the cables to detach them. (Fig. 3.0)
4. Remove the T10 screws from the climate circuit board. Remove the circuit board; set the board and screws aside. (Fig. 4.0)
5. Remove the fan speed and temperature control knobs, the HVAC buttons and rubber button pad. (Fig. 5.0)
6. Remove T10 screws from the controller board, the middle circuit board on the bezel. Remove the middle circuit board and set aside. The rubber buttons will not be used for this installation; set them aside to be saved with the OEM parts. (Fig. 6.0)

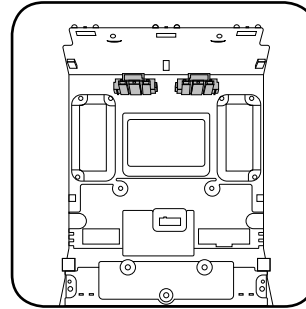

Fig. 1.0

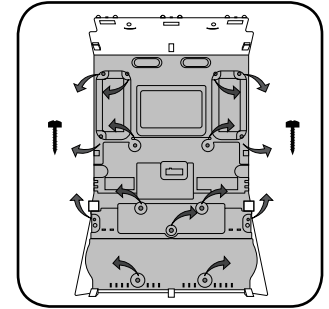

Fig. 2.0

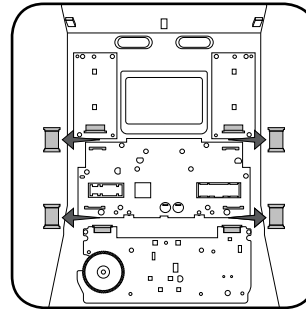

Fig. 3.0

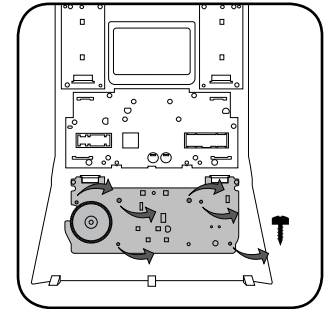

Fig. 4.0

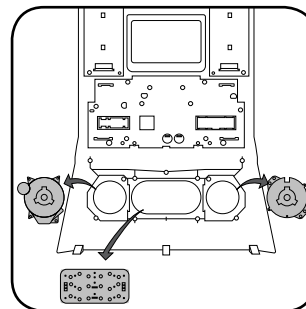

Fig. 5.0

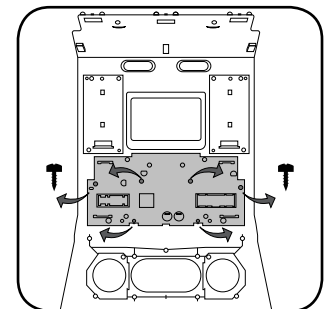

Fig. 6.0

INSTALLATION INSTRUCTIONS *NOT RETAINING SYNC

DASH KIT ASSEMBLY

When assembling the dash kit, be careful to use the correct length screws (use of too long of screw will puncture the front of the dash kit).

1. Set the plastic climate buttons into the FTR1 kit. Ensure the temperature control knob is in the center position, then install the temperature and fan knobs into the kit. (Fig. 1.0)
2. Install the climate circuit board (bottom board from the OEM dash panel) over the top of the climate knobs. Ensure that the black plastic gear that aligns with the temperature control is centered, just like the temperature knob (point the line on the big black gear toward the little gear (Fig. 2.0 A)). Use (4) short T10 screws to secure the climate circuit board to the dash kit (leave the 3 holes in the center of the board empty). (Fig. 2.0)
3. Install the new ribbon cables as shown (shiny side of the ribbon cable and the copper contacts at the end facing you). Insert them into the connector then push the latch to lock them into place. **Failure to correctly install the ribbon cables will cause the climate controls to not function at all.** (Fig. 3.0)
4. Feed the ribbon cable through the holes on the back of the housing cover for the climate unit. Use (3) long T10 screws and secure the FTR1 back cover of the climate board. (Fig. 4.0)
5. Install the ribbon cables shiny side down, to the bottom ports of the control board then seat the second control board to the back of the climate portion of the dash kit. (Fig. 5.0 and 5.1)
Secure this board to the dash kit with (6) short T10 screws. Note: Make sure the ribbon cables are not obstructing the screw holes on the sides. (Fig. 5.1)
6. Put the second FTR1 plastic cover on the control board and secure it at the sides and bottom with (3) long T10 screws. (Fig. 6.0)
7. Insert the hazard and traction control buttons in the holes in the top of the dash kit. (Fig. 7.0)
8. Insert and fix the storage pocket at the bottom of the dash panel, using provided screws. (Fig. 7.0 (A))

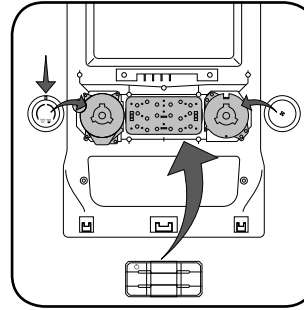

Fig. 1.0

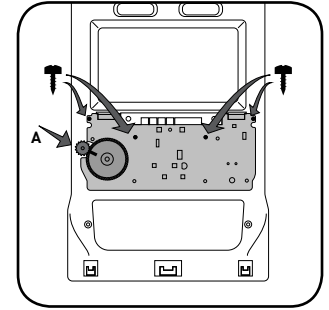

Fig. 2.0

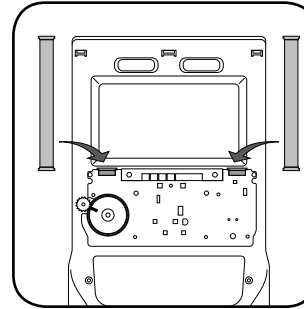

Fig. 3.0

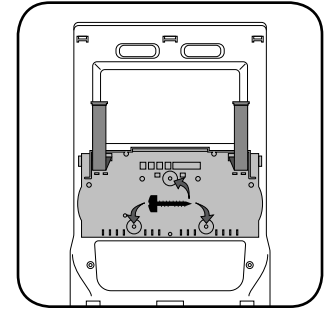

Fig. 4.0

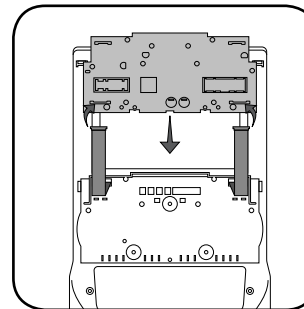

Fig. 5.0

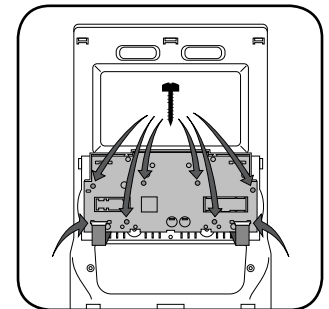

Fig. 5.1

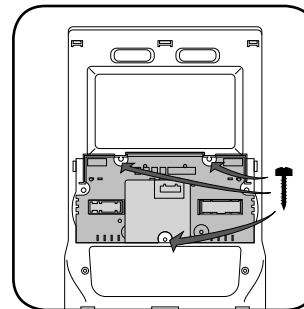

Fig. 6.0

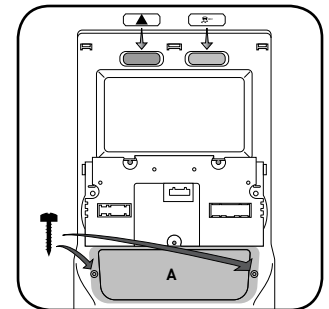

Fig. 7.0

INSTALLATION INSTRUCTIONS ***NOT RETAINING SYNC**

DASH KIT ASSEMBLY

- Unbox the aftermarket radio and mount it to the brackets included with the FTR1 kit (use the holes marked "1" for proper placement of the new radio) . (Fig. 8.0)
- If the camera module is present, mount it to the supplied mounting bracket using (3) M6 bolts and washers included with the FTR1 kit. Connect it. Insert in dash (area where OEM radio was) and secure it with (4) 7mm screws. (Fig. 9.0)

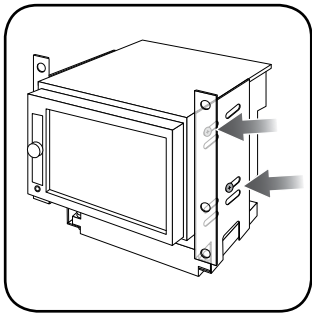

Fig. 8.0

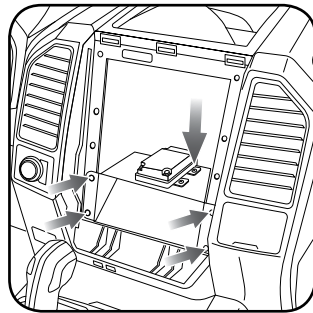

Fig. 9.0

MAKE CONNECTIONS (refer to wiring diagram)

- Locate the aftermarket radio's main harness. Connect the wires from the aftermarket radio's main harness to the FTR1 t-harness and match the wire functions (refer to diagram).
- Connect the FTR1 T-harness to the factory radio harness. Plug the backup camera cable into the factory harness (if applicable).
- Plug the FTR1 cable into the OEM Sync module harness. Connect the BLACK 2-pin connector of this cable to the BLACK 2-pin on the FTR1 T-harness. Connect the BLACK wire to ground. The backup camera RCA plug of this cable is not connected.
- Connect all harnesses to the Maestro RR module.
- Plug the aftermarket radio harnesses into the aftermarket radio. Plug the data cable to the data port of the aftermarket radio (port labeled iDataLink). Insert the Audio cable into the iDataLink 3.5 mm audio jack of the aftermarket radio (if there is no iDataLink audio input, connect to AUX). Plug the backup camera RCA into the aftermarket radio (if applicable).

Note: On Pioneer radio, ensure that there is nothing plugged into the W/R port.

- Insert the radio into the dash and secure the metal brackets with (4) 7mm bolts. (Fig. 1.0)
- Connect all the harnesses to the FTR1 kit, and secure it in the dash. Test your installation before completely re-assembling the bezel to the truck. (Fig. 2.0)

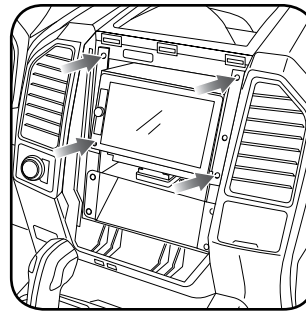

Fig. 1.0

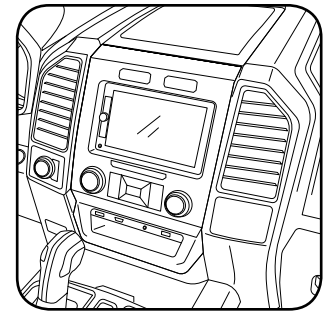

Fig. 2.0

WIRING DIAGRAM *NOT RETAINING SYNC

STEP 1

- WHITE - LF SPEAKER (+)
- WHITE/BLACK - LF SPEAKER (-)
- GRAY - RF SPEAKER (+)
- GRAY/BLACK - RF SPEAKER (-)
- GREEN - LR SPEAKER (+)
- GREEN/BLACK - LR SPEAKER (-)
- PURPLE - RR SPEAKER (+)
- PURPLE/BLACK - RR SPEAKER (-)
- BLUE/WHITE - AMP. TURN ON (+)
- BLACK - GROUND
- RED - ACCESSORY (+)
- YELLOW - 12V (+)
- BLUE - POWER ANTENNA
- ORANGE - ILLUMINATION (+)
- PURPLE/WHITE - REVERSE LIGHT (+)
- LTGREEN - E-BRAKE (-)
- PINK - VEHICLE SPEED
- YELLOW/BLACK - FOOT BRAKE
- BROWN (NOT CONNECTED)

STEP 5

PIONEER RADIO: ENSURE THAT NOTHING IS PLUGGED IN W/R PORT.

CONNECT TO AFTERMARKET RADIO

STEP 2

FACTORY RADIO HARNESS

STEP 3

OEM SYNC MODULE HARNESS

STEP 7

HARNESS BEHIND RADIO

STEP 4

MAESTRO RR MODULE

NOT REQUIRED

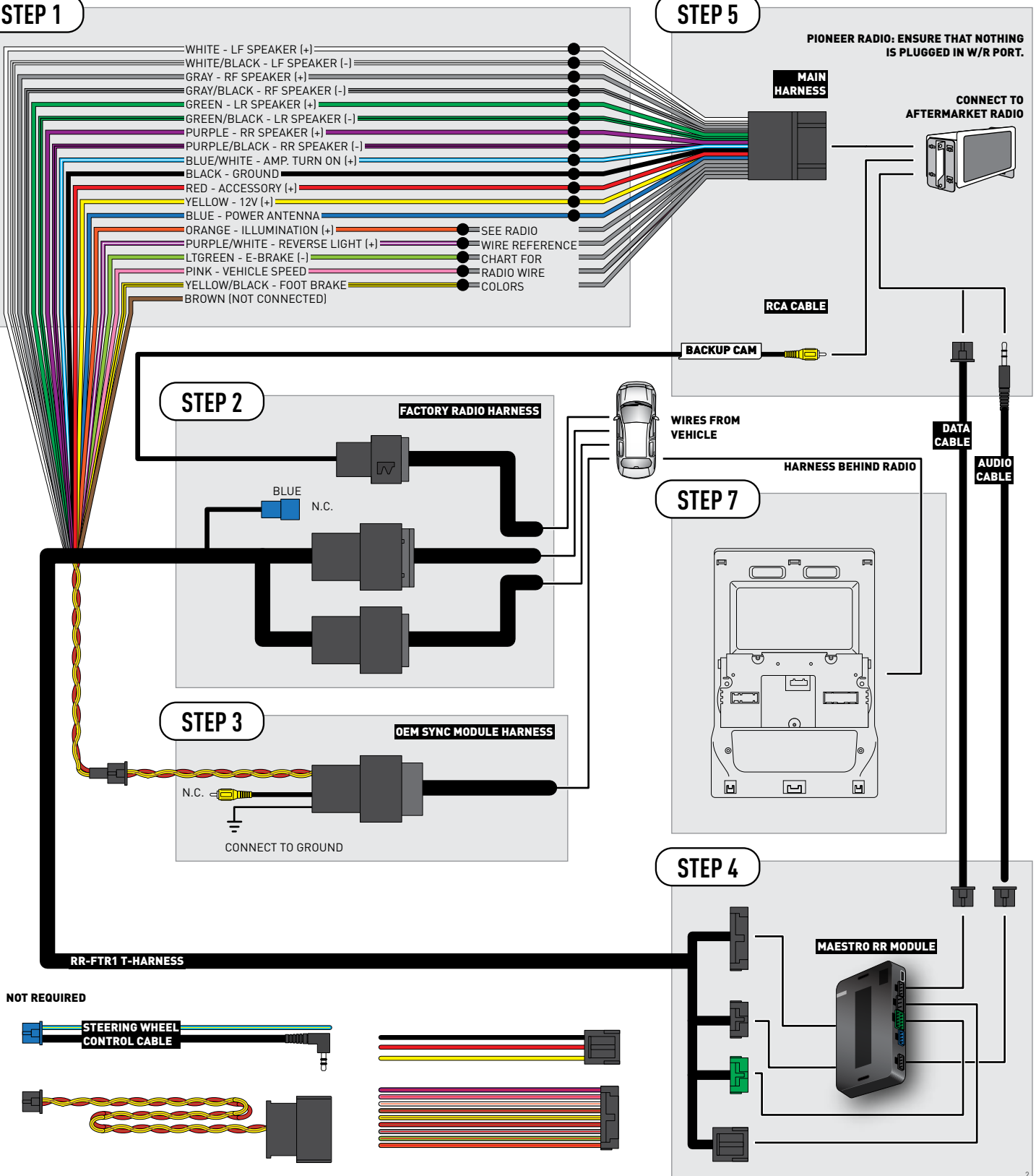
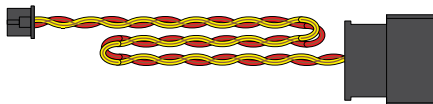

RADIO WIRE REFERENCE CHART

Wire Description	Polarity	Wire Color on Maestro T-Harness	Wire Color on Alpine cable	Wire Color on Kenwood cable	Wire Color on Pioneer cable
Illumination	(+)	Orange	N/A	Orange/White	Orange/White
Reverse Light	(+)	Purple/White	Orange/White	Purple/White	Purple/White
E-Brake	(-)	Lt Green	Yellow/Blue	Lt Green	Lt Green
Foot Brake	(+)	Yellow/Black	Yellow/Black	N/A	N/A
VSS (vehicle speed sensor)	(DATA)	Pink	Green/White	Pink	Pink
Power Antenna	(+)	Blue	Blue	Blue	N/A

TROUBLESHOOTING TABLE

PROBLEM	SOLUTION
Gauges do not work, radio shows OBD2 Error 1 or Error 2.	<p>Ensure OBDII connector is securely attached to the OBDII connector of the vehicle.</p> <p>If you hardwired connections at the OBDII, check connections at the OBDII connector. Make sure the RED/ BROWN wire is on PIN 6 and the YELLOW/ BROWN wire is connected to PIN 14 of the OBDII connector. Do not use T-Taps. Soldering or military splicing methods are recommended.</p> <p>Reset the RR.</p>
There is no sound from OEM sources like Sync.	<p>Ensure the all black, 3-pin to 3.5mm audio cable is connected between the RR and the radio. Make sure it is in the correct radio input.</p>
The climate controls do not work.	<p>Re-check the climate control assembly. Ensure the ribbon cables are not installed backward.</p>
There is no image from the backup camera.	<p>Ensure that the yellow RCA is plugged into the correct port on the radio.</p> <p>Ensure the 12-pin connector from the 4.3" factory screen is plugged into the 12 pin plug of the FTR1 T-harness.</p> <p>*Some vehicles get the backup camera video from the Sync connector (54-pin) instead. Plug this connector to the supplied 54-pin connector of the FTR1 T-harness.</p>
The light on the Maestro is flashing RED ONCE .	<p>There is no firmware on the module; flash the RR module.</p>
The light on the Maestro is blinking RED TWICE .	<p>Ensure the 4-pin data cable is connected between the radio and the RR, and that it is plugged into the black port on the Maestro RR. The red and blue ports on the RR should be empty.</p> <p>Make sure the correct radio model and serial number were entered during the flash. Verify the radio's serial number entered during the flash matches what is listed on the radio screen. This can be found in the settings of the radio, listed as Device Id, Device Number, or Serial Number.</p>

MAESTRO RR RESET PROCEDURE:

Turn the key to the OFF position, then disconnect all connectors from the module.

Press and hold the module's programming button and connect all the connectors back to the module. Wait, the module's LED will flash RED rapidly (this may take up to 10 seconds).

Release the programming button. Wait, the LED will turn solid GREEN for 2 seconds to show the reset was successful.

TECHNICAL ASSISTANCE

Phone: 1-866-427-2999

Email: maestro.support@idatalink.com

Web: maestro.idatalink.com/support add www.12voltdata.com/forum/

IMPORTANT: To ensure proper operation, the aftermarket radio needs to have the latest firmware from the manufacturer. Please visit the radio manufacturer's website and look for any updates pertaining to your radio.

2018-2020

FORD F150

NOT RETAINING SYNC WITH MYFORD 4.3" SCREEN

RETAINS STEERING WHEEL CONTROLS, BACKUP CAMERA AND MORE!



PRODUCTS REQUIRED

iDatalink Maestro RR or RR2 Radio Replacement Interface
iDatalink Maestro FTR1 Dash Kit

PROGRAMMED FIRMWARE

ADS-RR(SR)-F02B-DS

ADDITIONAL RESOURCES

[Maestro RR2 Programmable Outputs Guide](#)

OPTIONAL ACCESSORIES

K40[™]
ELECTRONICS
ESCORT

HRN-ANT-SAT1

Click here for:
[Radar Installation Guides](#)

WELCOME

Congratulations on the purchase of your iDatalink Maestro RR Radio replacement solution. You are now a few simple steps away from enjoying your new car radio with enhanced features.

Before starting your installation, please ensure that your iDatalink Maestro module is programmed with the correct firmware for your vehicle and that you carefully review the install guide.

Please note that Maestro RR will only retain functionalities that were originally available in the vehicle.

NEED HELP?

 1 866 427-2999

 maestro.support@idatalink.com

 maestro.idatalink.com/support
www.12voltdata.com/forum

TABLE OF CONTENTS

Installation Instructions	3
Wiring Diagram	7
Radio Wire Reference Chart	8
Troubleshooting Table	9

INSTALLATION INSTRUCTIONS *NOT RETAINING SYNC

DASH DISASSEMBLY

1. If the vehicle is equipped with a center channel speaker: Pop the speaker grille up (A), unscrew (2) 7mm bolts from the tray (B), and remove it (C). (Fig. 1.0)

If there is no center channel speaker: lift the rubber mat at the top of the dash (A), then remove (2) 7mm bolts from the tray (B), and remove it (C). (Fig. 1.1)

2. Remove the (2) 7mm bolts from the top of the radio panel. Unclip the radio bezel, unplug its connectors, and remove the panel. (Fig. 2.0)

3. Remove the 7mm screws securing the factory screen and disconnect it. (Fig. 3.0)

4. Remove the (4) 7mm screws securing the radio module, then unplug and remove it. (Fig. 3.0)

5. If the camera module is present, remove the (3) 10mm nuts securing it and remove the module. (Fig.4.0)

Looking down, from the top of the dash, locate the (2) 8mm bolts securing the camera module's bracket and remove them. Remove the (2) 7mm bolts under the plastic of the top of the dash (bolts aren't visible). Work the metal bracket free from the sub-dash and remove it. (Fig. 4.1)

Note: the bracket may be cut but this will prevent re-installing OEM equipment.

6. Unclip the factory harness that is secured to the plastic trim at the front of the radio cavity and push it out of the way, to the back of the dash. Cut and remove the plastic sub-dash at the front of the radio cavity. (Fig. 5.0)

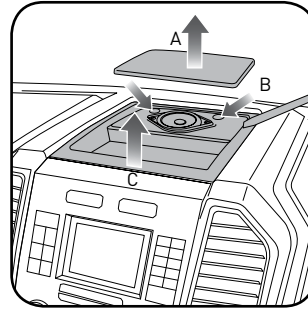

Fig. 1.0

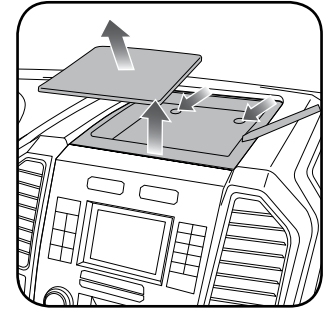

Fig. 1.1

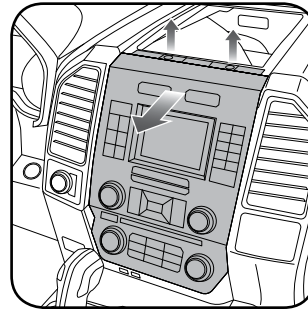

Fig. 2.0

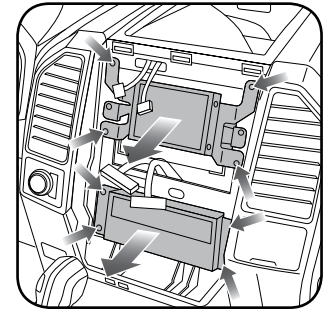

Fig. 3.0

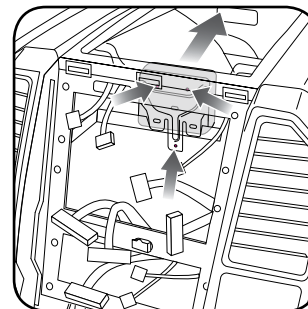

Fig. 4.0

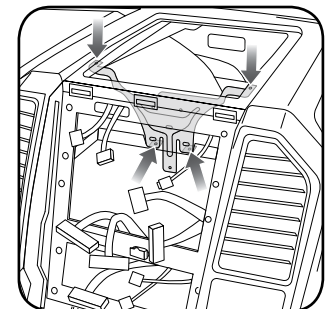

Fig. 4.1

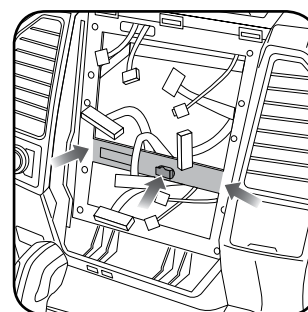

Fig. 5.0

INSTALLATION INSTRUCTIONS *NOT RETAINING SYNC

RADIO BEZEL DISASSEMBLY

Note: Save all of the screws from the disassembly and separate them by length, short and long, many of these screws will be used to assemble the FTR-1 kit.

1. Remove the hazard and traction control buttons by depressing the release tabs. (Fig. 1.0)
2. Remove the T10 screws from the back of the factory dash panel. (Fig. 2.0)
Remove the back cover of the bezel. (Fig. 2.0)
3. Remove the (4) ribbon cables from the circuit boards on the factory panel (gently push on the white release tabs and gently pull on the cables to detach them). (Fig. 3.0)
4. Remove the T10 screws from the climate circuit board. Remove the circuit board; set the board and screws aside. (Fig. 4.0)
5. Remove the fan speed and temperature control knobs, the HVAC buttons and rubber button pad. (Fig. 5.0)
6. Remove T10 screws from the controller board, the middle circuit board on the bezel. Remove the middle circuit board and set aside. The rubber buttons will not be used for this installation; set them aside to be saved with the OEM parts. (Fig. 6.0)

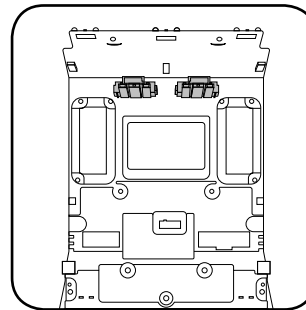

Fig. 1.0

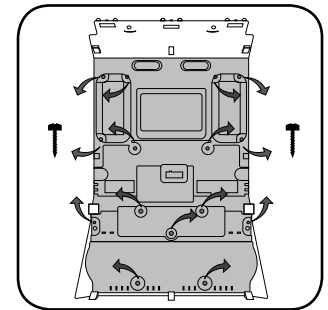

Fig. 2.0

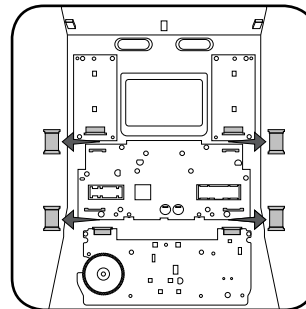

Fig. 3.0

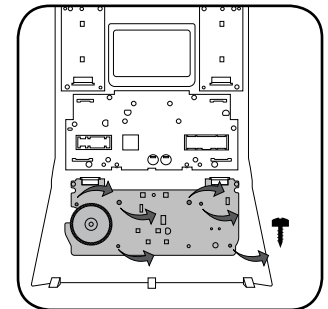

Fig. 4.0

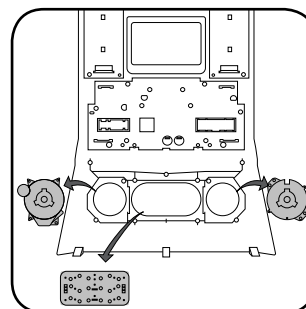

Fig. 5.0

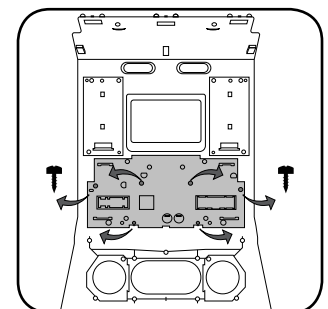

Fig. 6.0

INSTALLATION INSTRUCTIONS *NOT RETAINING SYNC

DASH KIT ASSEMBLY

When assembling the dash kit, be careful to use the correct length screws (use of too long of screw will puncture the front of the dash kit).

1. Set the plastic climate buttons into the FTR1 kit. Ensure the temperature control knob is in the center position, then install the temperature and fan knobs into the kit. (Fig. 1.0)
2. Install the climate circuit board (bottom board from the OEM dash panel) over the top of the climate knobs. Ensure that the black plastic gear that aligns with the temperature control is centered, just like the temperature knob (point the line on the big black gear toward the little gear (Fig. 2.0 A)). Use (4) short T10 screws to secure the climate circuit board to the dash kit (leave the 3 holes in the center of the board empty). (Fig. 2.0)
3. Install the new ribbon cables as shown (shiny side of the ribbon cable and the copper contacts at the end facing you). Insert them into the connector then push the latch to lock them into place. **Failure to correctly install the ribbon cables will cause the climate controls to not function at all.** (Fig. 3.0)
4. Feed the ribbon cable through the holes on the back of the housing cover for the climate unit. Use (3) long T10 screws and secure the FTR1 back cover of the climate board. (Fig. 4.0)
5. Install the ribbon cables shiny side down, to the bottom ports of the control board then seat the second control board to the back of the climate portion of the dash kit. (Fig. 5.0 and 5.1)
Secure this board to the dash kit with (6) short T10 screws. Note: Make sure the ribbon cables are not obstructing the screw holes on the sides. (Fig. 5.1)
6. Put the second FTR1 plastic cover on the control board and secure it at the sides and bottom with (3) long T10 screws. (Fig. 6.0)
7. Insert the hazard and traction control buttons in the holes in the top of the dash kit. (Fig. 7.0)
8. Insert and fix the storage pocket at the bottom of the dash panel, using provided screws. (Fig. 7.0 (A))

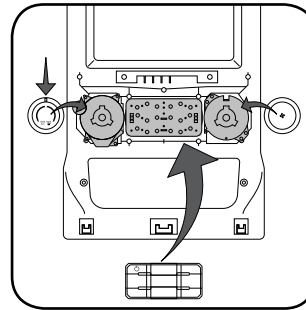

Fig. 1.0

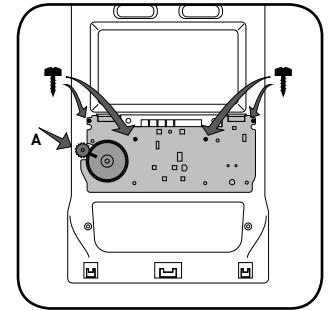

Fig. 2.0

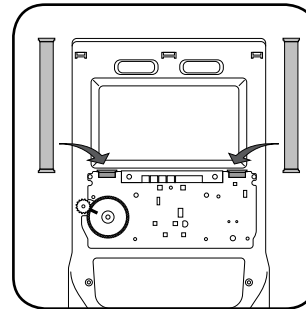

Fig. 3.0

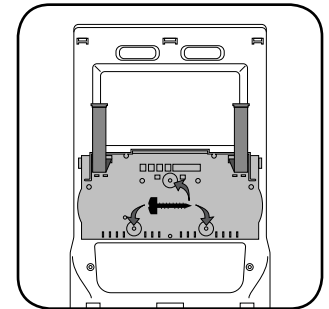

Fig. 4.0

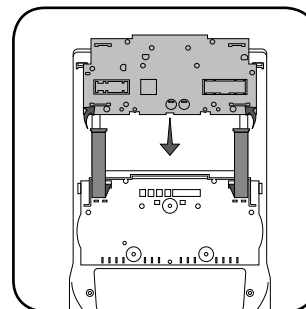

Fig. 5.0

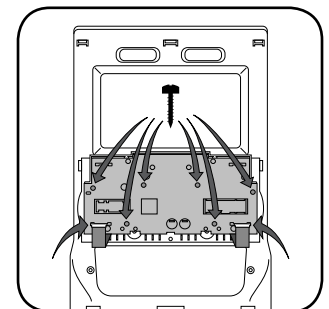

Fig. 5.1

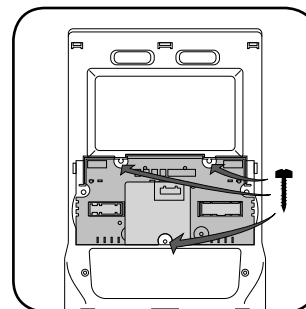

Fig. 6.0

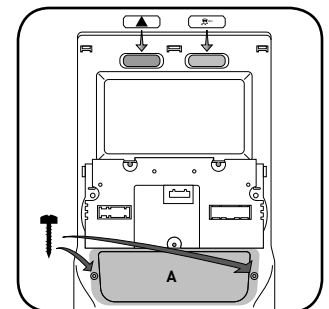

Fig. 7.0

3

INSTALLATION INSTRUCTIONS *NOT RETAINING SYNC

DASH KIT ASSEMBLY

- Unbox the aftermarket radio and mount it to the brackets included with the FTR1 kit (use the holes marked "1" for proper placement of the new radio) . (Fig. 8.0)
- If the camera module is present, mount it to the supplied mounting bracket using (3) M6 bolts and washers included with the FTR1 kit. Connect it. Insert in dash (area where OEM radio was) and secure it with (4) 7mm screws. (Fig. 9.0)

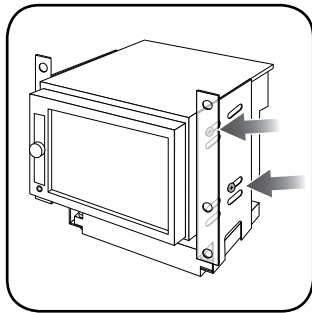

Fig. 8.0

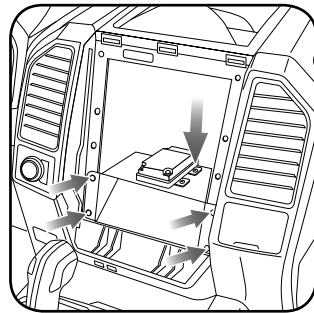

Fig. 9.0

Note: On Pioneer radio, ensure that there is nothing plugged into the W/R port.

- Insert the radio into the dash and secure the metal brackets with (4) 7mm bolts. (Fig. 1.0)
- Connect all the harnesses to the FTR1 kit, and secure it in the dash. Test your installation before completely re-assembling the bezel to the truck. (Fig. 2.0)

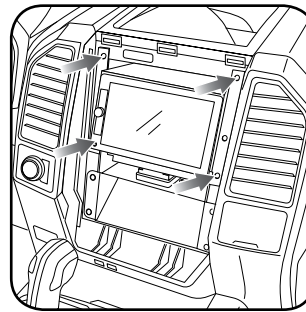

Fig. 1.0

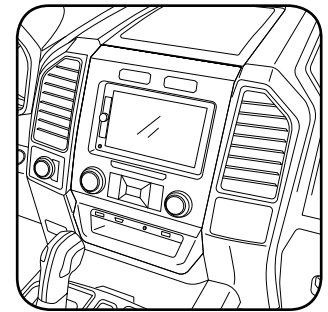

Fig. 2.0

MAKE CONNECTIONS (refer to wiring diagram)

- Locate the aftermarket radio's main harness. Connect the wires from the aftermarket radio's main harness to the FTR1 t-harness and match the wire functions (refer to diagram).
- Connect the FTR1 T-harness to the factory radio harness. Plug the backup camera cable into the factory harness (if applicable).
- Plug the FTR1 cable into the OEM Sync module harness. Connect the BLACK 2-pin connector of this cable to the BLACK 2-pin on the FTR1 T-harness. Connect the BLACK wire to ground.
- Connect all harnesses to the Maestro RR module.
- Plug the aftermarket radio harnesses into the aftermarket radio. Plug the data cable to the data port of the aftermarket radio (port labeled iDatalink). Insert the Audio cable into the iDatalink 3.5 mm audio jack of the aftermarket radio (if there is no iDatalink audio input, connect to AUX). Plug the backup camera RCA into the aftermarket radio from FTR1 cable (if applicable).

WIRING DIAGRAM *NOT RETAINING SYNC

STEP 1

- WHITE - LF SPEAKER (+)
- WHITE/BLACK - LF SPEAKER (-)
- GRAY - RF SPEAKER (+)
- GRAY/BLACK - RF SPEAKER (-)
- GREEN - LR SPEAKER (+)
- GREEN/BLACK - LR SPEAKER (-)
- PURPLE - RR SPEAKER (+)
- PURPLE/BLACK - RR SPEAKER (-)
- BLUE/WHITE - AMP. TURN ON (+)
- BLACK - GROUND
- RED - ACCESSORY (+)
- YELLOW - 12V (+)
- BLUE - POWER ANTENNA
- ORANGE - ILLUMINATION (+)
- PURPLE/WHITE - REVERSE LIGHT (+)
- LTGREEN - E-BRAKE (-)
- PINK - VEHICLE SPEED
- YELLOW/BLACK - FOOT BRAKE
- BROWN (NOT CONNECTED)

STEP 5

PIONEER RADIO: ENSURE THAT NOTHING IS PLUGGED IN W/R PORT.

MAIN HARNESS

CONNECT TO AFTERMARKET RADIO

RCA CABLE

WIRES FROM VEHICLE

STEP 2

FACTORY RADIO HARNESS

BLUE N.C.

STEP 3

DEM SYNC MODULE HARNESS

CONNECT TO GROUND

STEP 7

HARNESS BEHIND RADIO

STEP 4

MAESTRO RR MODULE

NOT REQUIRED

STEERING WHEEL CONTROL CABLE

BACKUP CAM

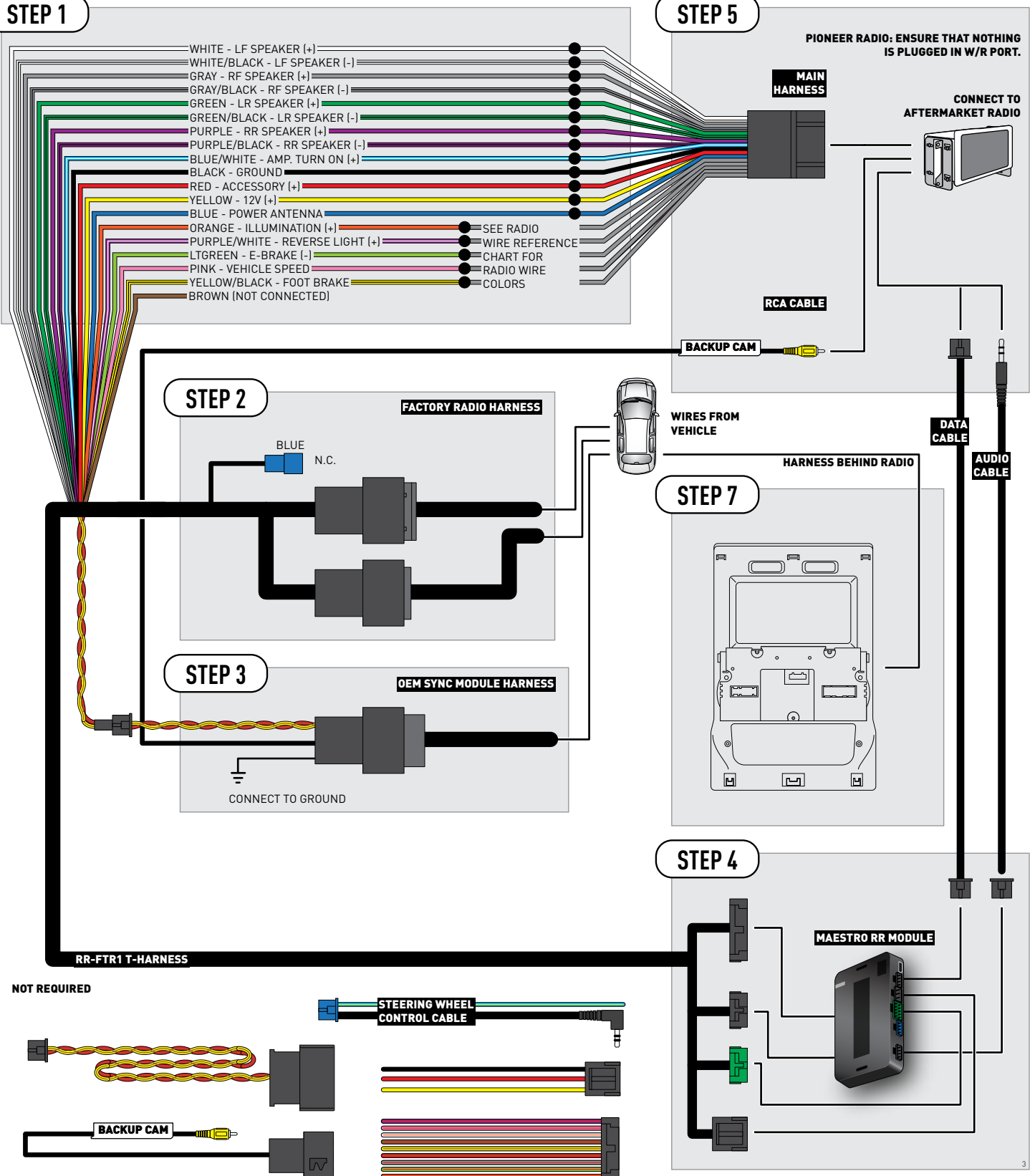

RADIO WIRE REFERENCE CHART

Wire Description	Polarity	Wire Color on Maestro T-Harness	Wire Color on Alpine cable	Wire Color on Kenwood cable	Wire Color on Pioneer cable
Illumination	(+)	Orange	N/A	Orange/White	Orange/White
Reverse Light	(+)	Purple/White	Orange/White	Purple/White	Purple/White
E-Brake	(-)	Lt Green	Yellow/Blue	Lt Green	Lt Green
Foot Brake	(+)	Yellow/Black	Yellow/Black	N/A	N/A
VSS (vehicle speed sensor)	(DATA)	Pink	Green/White	Pink	Pink
Power Antenna	(+)	Blue	Blue	Blue	N/A

TROUBLESHOOTING TABLE

PROBLEM	SOLUTION
Gauges do not work, radio shows OBD2 Error 1 or Error 2.	<p>Ensure OBDII connector is securely attached to the OBDII connector of the vehicle.</p> <p>If you hardwired connections at the OBDII, check connections at the OBDII connector. Make sure the RED/ BROWN wire is on PIN 6 and the YELLOW/ BROWN wire is connected to PIN 14 of the OBDII connector. Do not use T-Taps. Soldering or military splicing methods are recommended.</p> <p>Reset the RR.</p>
There is no sound from OEM sources like Sync.	<p>Ensure the all black, 3-pin to 3.5mm audio cable is connected between the RR and the radio. Make sure it is in the correct radio input.</p>
The climate controls do not work.	<p>Re-check the climate control assembly. Ensure the ribbon cables are not installed backward.</p>
There is no image from the backup camera.	<p>Ensure that the yellow RCA is plugged into the correct port on the radio.</p> <p>Ensure the 54-pin connector is plugged into the 54-pin plug of the FTR1 T-harness.</p> <p>*Some vehicles get the backup camera video from the 12-pin connector that was plugged into the 4.3" screen instead. Plug this 12-pin connector to the 12-pin of the FTR1 T-harness. Also connect the vehicle's 54-pin connector to the FTR1 T-harness.</p>
The light on the Maestro is flashing RED ONCE .	<p>There is no firmware on the module; flash the RR module.</p>
The light on the Maestro is blinking RED TWICE .	<p>Ensure the 4-pin data cable is connected between the radio and the RR, and that it is plugged into the black port on the Maestro RR. The red and blue ports on the RR should be empty.</p> <p>Make sure the correct radio model and serial number were entered during the flash. Verify the radio's serial number entered during the flash matches what is listed on the radio screen. This can be found in the settings of the radio, listed as Device Id, Device Number, or Serial Number.</p>

MAESTRO RR RESET PROCEDURE:

Turn the key to the OFF position, then disconnect all connectors from the module.

Press and hold the module's programming button and connect all the connectors back to the module. Wait, the module's LED will flash RED rapidly (this may take up to 10 seconds).

Release the programming button. Wait, the LED will turn solid GREEN for 2 seconds to show the reset was successful.

TECHNICAL ASSISTANCE

Phone: 1-866-427-2999

Email: maestro.support@idatalink.com

Web: maestro.idatalink.com/support add www.12voltdata.com/forum/

IMPORTANT: To ensure proper operation, the aftermarket radio needs to have the latest firmware from the manufacturer. Please visit the radio manufacturer's website and look for any updates pertaining to your radio.

2015-2017

FORD F150

RETAINING SYNC WITH MYFORD 4.3" SCREEN

RETAINS STEERING WHEEL CONTROLS, BACKUP CAMERA AND MORE!



PRODUCTS REQUIRED

iDatalink Maestro RR or RR2 Radio Replacement Interface
iDatalink Maestro FTR1 Dash Kit

PROGRAMMED FIRMWARE

ADS-RR(SR)-F02B-DS

ADDITIONAL RESOURCES

[Maestro RR2 Programmable Outputs Guide](#)

OPTIONAL ACCESSORIES

K40[™]
ELECTRONICS
ESCORT

HRN-ANT-SAT1

Click here for:
[Radar Installation Guides](#)

WELCOME

Congratulations on the purchase of your iDatalink Maestro RR Radio replacement solution. You are now a few simple steps away from enjoying your new car radio with enhanced features.

Before starting your installation, please ensure that your iDatalink Maestro module is programmed with the correct firmware for your vehicle and that you carefully review the install guide.

Please note that Maestro RR will only retain functionalities that were originally available in the vehicle.

NEED HELP?

 1 866 427-2999

 maestro.support@idatalink.com

 maestro.idatalink.com/support
www.12voltdata.com/forum

TABLE OF CONTENTS

Installation Instructions	3
Wiring Diagram	7
Radio Wire Reference Chart	8
Troubleshooting Table	9

INSTALLATION INSTRUCTIONS *RETAINING SYNC

DASH DISASSEMBLY

1. If the vehicle is equipped with a center channel speaker: Pop the speaker grille up (A), unscrew (2) 7mm bolts from the tray (B), and remove it (C). (Fig. 1.0)
If there is no center channel speaker: lift the rubber mat at the top of the dash (A), then remove (2) 7mm bolts from the tray (B), and remove it (C). (Fig. 1.1)
2. Remove the (2) 7mm bolts from the top of the radio panel. Unclip the radio bezel, unplug its connectors, and remove the panel. (Fig. 2.0)
3. Remove the 7mm screws securing the factory screen and disconnect it. (Fig. 3.0)
4. Remove the (4) 7mm screws securing the radio module, then unplug and remove it. (Fig. 4.0)
5. Remove (2) 7mm screws securing the Sync module. Unplug and remove it. (Fig. 5.0)
6. If the camera module is present, remove the (3) 10mm nuts securing it and remove the module. (Fig. 6.0)
Looking down, from the top of the dash, locate the (2) 8mm bolts securing the camera module's bracket and remove them. Remove the (2) 7mm bolts under the plastic of the top of the dash (bolts aren't visible). Work the metal bracket free from the sub-dash and remove it. (Fig. 6.1)
Note: the bracket may be cut but this will prevent re-installing OEM equipment.
7. Unclip the factory harness that is secured to the plastic trim at the front of the radio cavity and push it out of the way, to the back of the dash. Cut and remove the plastic sub-dash at the front of the radio cavity. (Fig. 7.0)

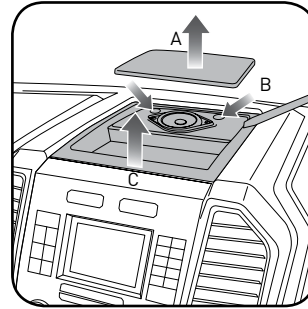

Fig. 1.0

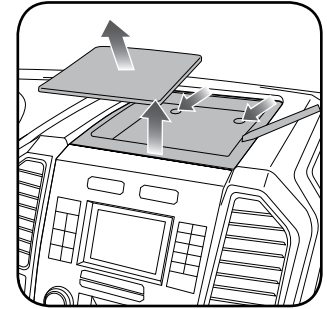

Fig. 1.1

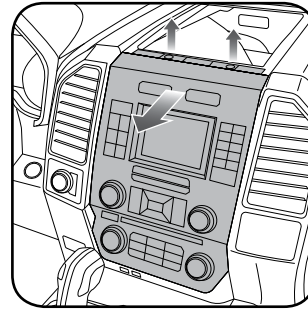

Fig. 2.0

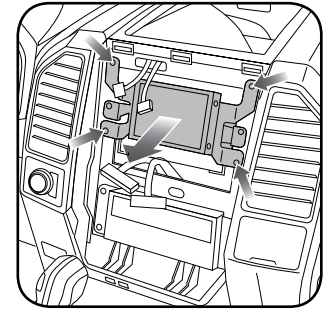

Fig. 3.0

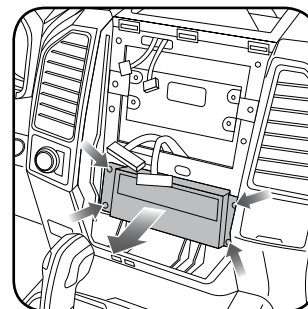

Fig. 4.0

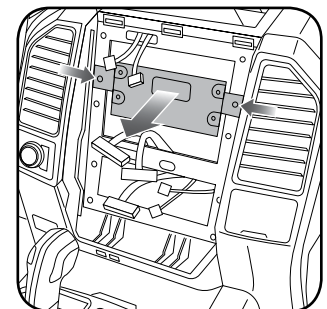

Fig. 5.0

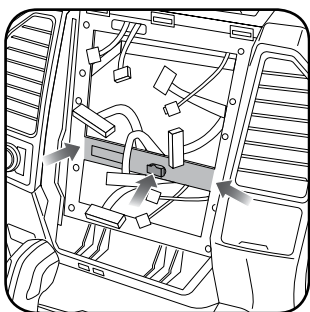

Fig. 7.0

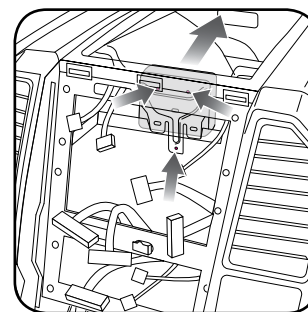

Fig. 6.0

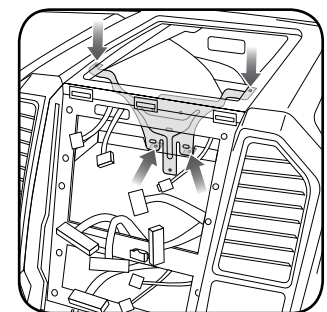

Fig. 6.1

INSTALLATION INSTRUCTIONS *RETAINING SYNC

RADIO BEZEL DISASSEMBLY

Note: Save all of the screws from the disassembly and separate them by length, short and long, many of these screws will be used to assemble the FTR-1 kit.

1. Remove the hazard and traction control buttons by depressing the release tabs. (Fig. 1.0)
2. Remove the T10 screws from the back of the factory dash panel. (Fig. 2.0)
Remove the back cover of the bezel. (Fig. 2.0)
3. Remove the (4) ribbon cables from the circuit boards on the factory panel (gently push on the white release tabs and gently pull on the cables to detach them. (Fig. 3.0)
4. Remove the T10 screws from the climate circuit board. Remove the circuit board; set the board and screws aside. (Fig. 4.0)
5. Remove the fan speed and temperature control knobs, the HVAC buttons and rubber button pad. (Fig. 5.0)
6. Remove T10 screws from the controller board, the middle circuit board on the bezel. Remove the middle circuit board and set aside. The rubber buttons will not be used for this installation; set them aside to be saved with the OEM parts. (Fig. 6.0)

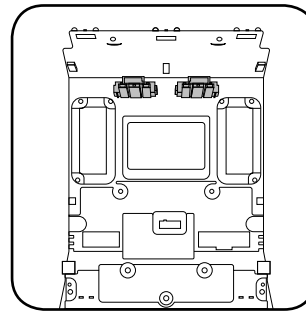

Fig. 1.0

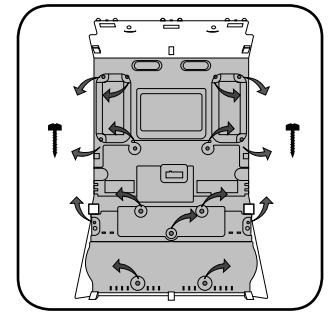

Fig. 2.0

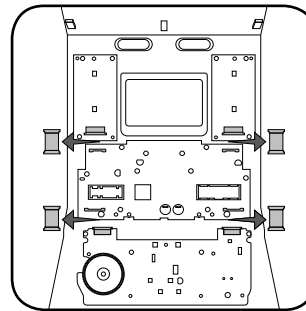

Fig. 3.0

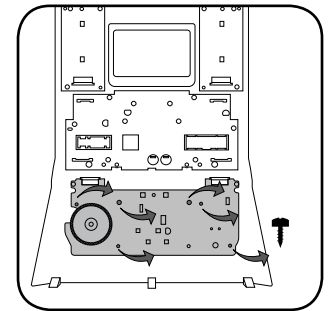

Fig. 4.0

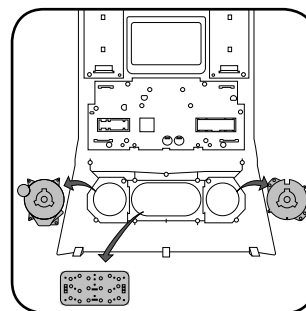

Fig. 5.0

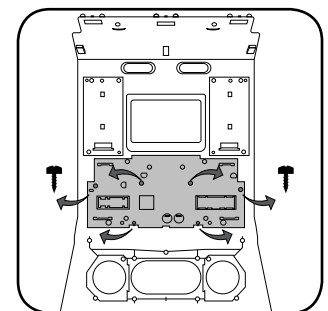

Fig. 6.0

INSTALLATION INSTRUCTIONS *RETAINING SYNC

DASH KIT ASSEMBLY

When assembling the dash kit, be careful to use the correct length screws (use of too long of screw will puncture the front of the dash kit).

1. Set the plastic climate buttons into the FTR1 kit. Ensure the temperature control knob is in the center position, then install the temperature and fan knobs into the kit. (Fig. 1.0)
2. Install the climate circuit board (bottom board from the OEM dash panel) over the top of the climate knobs. Ensure that the black plastic gear that aligns with the temperature control is centered, just like the temperature knob (point the line on the big black gear toward the little gear (Fig. 2.0 A)). Use (4) short T10 screws to secure the climate circuit board to the dash kit (leave the 3 holes in the center of the board empty). (Fig. 2.0)
3. Install the new ribbon cables as shown (shiny side of the ribbon cable and the copper contacts at the end facing you). Insert them into the connector then push the latch to lock them into place. **Failure to correctly install the ribbon cables will cause the climate controls to not function at all.** (Fig. 3.0)
4. Feed the ribbon cable through the holes on the back of the housing cover for the climate unit. Use (3) long T10 screws and secure the FTR1 back cover of the climate board. (Fig. 4.0)
5. Install the ribbon cables shiny side down, to the bottom ports of the control board then seat the second control board to the back of the climate portion of the dash kit. (Fig. 5.0 and 5.1)
Secure this board to the dash kit with (6) short T10 screws. Note: Make sure the ribbon cables are not obstructing the screw holes on the sides. (Fig. 5.1)
6. Put the second FTR1 plastic cover on the control board and secure it at the sides and bottom with (3) long T10 screws. (Fig. 6.0)
7. Insert the hazard and traction control buttons in the holes in the top of the dash kit. (Fig. 7.0)
8. Insert and fix the storage pocket at the bottom of the dash panel, using provided screws. (Fig. 7.0 A)

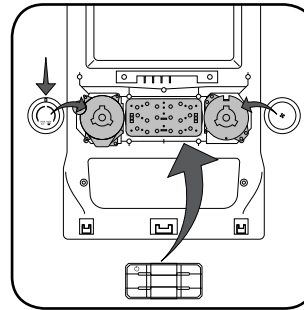

Fig. 1.0

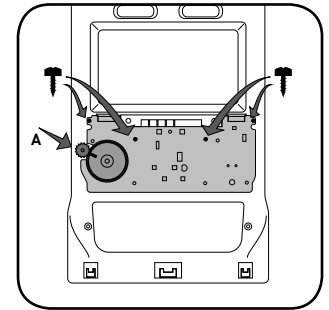

Fig. 2.0

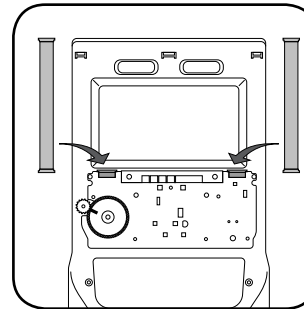

Fig. 3.0

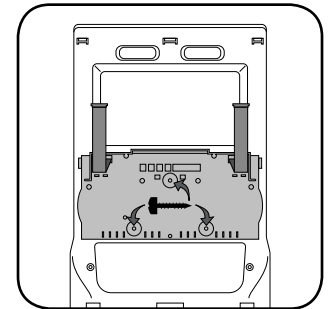

Fig. 4.0

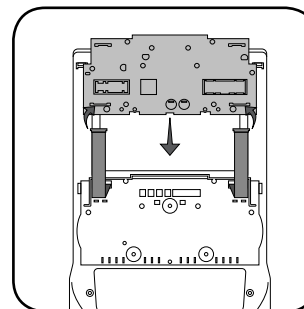

Fig. 5.0

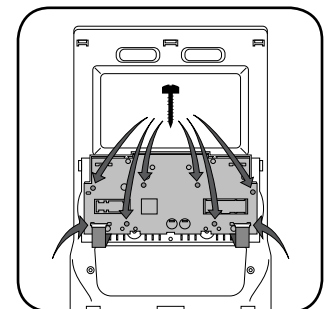

Fig. 5.1

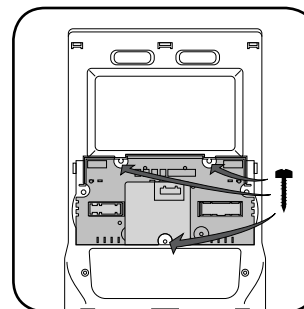

Fig. 6.0

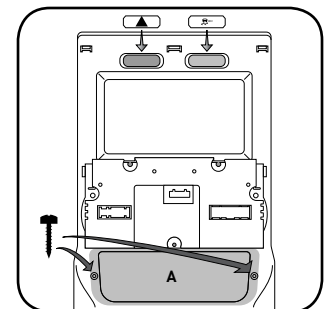

Fig. 7.0

INSTALLATION INSTRUCTIONS *RETAINING SYNC

DASH KIT ASSEMBLY

9. Unscrew the sync module from the factory brackets. (Fig. 8.0)
Mount the sync module using the supplied M5 bolts and washers to the brackets included with the FTR1 kit. (Fig. 8.1)
10. Unbox the aftermarket radio and mount it to the brackets (use the holes marked "1" for proper placement of the new radio) . (Fig. 8.2)
11. If the camera module is present, mount it to the supplied mounting bracket using (3) M6 bolts and washers included with the FTR1 kit. Connect it. Insert in dash (area where OEM radio was) and secure it with (4) 7mm screws. (Fig. 9.0)

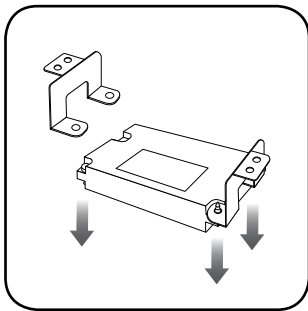

Fig. 8.0

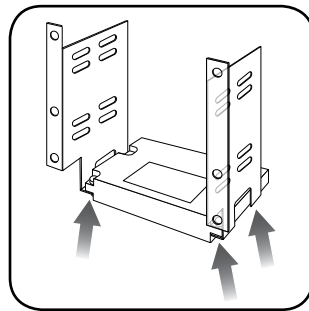

Fig. 8.1

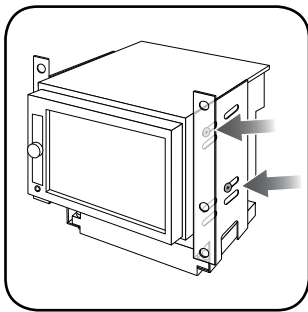

Fig. 8.2

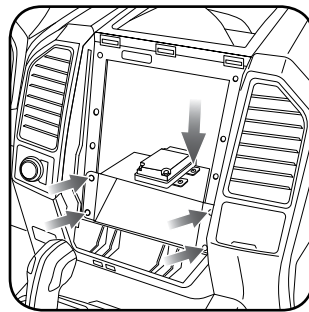

Fig. 9.0

Plug the backup camera cable into the factory harness (if applicable).

3. Plug the OBD2 connector into the OBD2 port of the vehicle, located under the driver side dash, and run the wires up to the radio cavity.
4. Connect all harnesses to the Maestro RR module.
5. Plug the aftermarket radio harnesses into the aftermarket radio. Plug the data cable to the data port of the aftermarket radio (port labeled iDatalink). Insert the Audio cable into the iDatalink 3.5 mm audio jack of the aftermarket radio (if there is no iDatalink audio input, connect to AUX). Plug the backup camera RCA into the aftermarket radio (if applicable).

Note: On Pioneer radio, ensure that there is nothing plugged into the W/R port.

6. Insert the radio and sync module into the dash and secure the metal brackets with (4) 7mm bolts. (Fig. 1.0)
7. Connect all the harnesses to the FTR1 kit, and secure it in the dash. Test your installation before completely re-assembling the bezel to the truck. (Fig. 2.0)

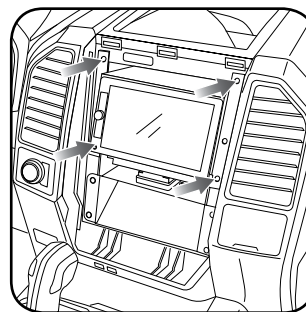

Fig. 1.0

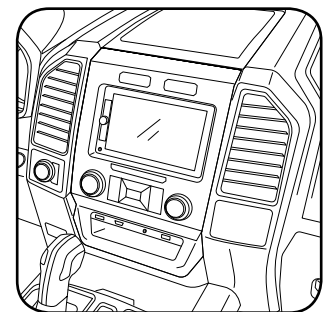
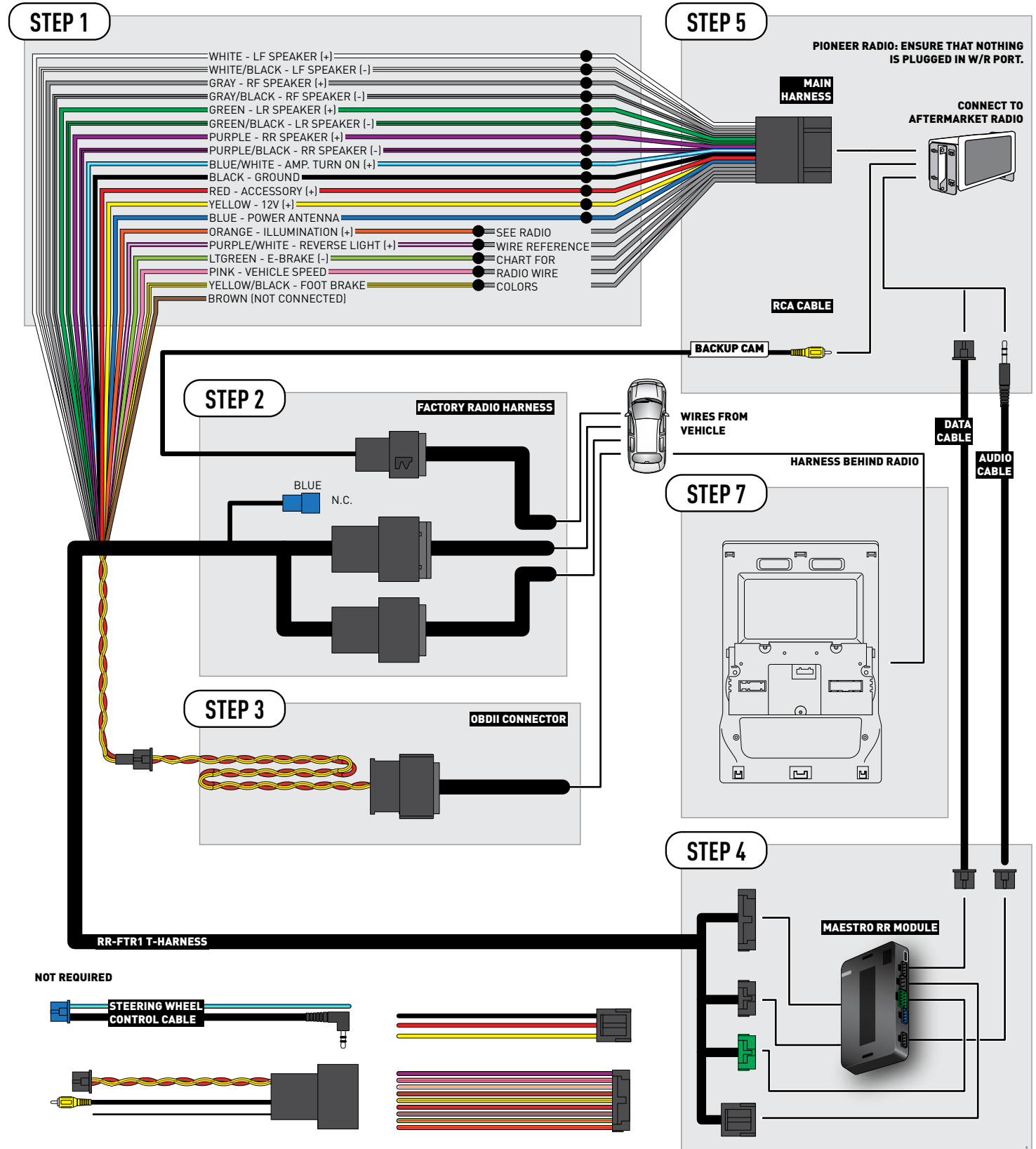

Fig. 2.0

MAKE CONNECTIONS (refer to wiring diagram)

1. Locate the aftermarket radio's main harness. Connect the wires from the aftermarket radio's main harness to the FTR1 t-harness and match the wire functions (refer to diagram).
2. Connect the FTR1 T-harness to the factory radio harness.

WIRING DIAGRAM *RETAINING SYNC



RADIO WIRE REFERENCE CHART

Wire Description	Polarity	Wire Color on Maestro T-Harness	Wire Color on Alpine cable	Wire Color on Kenwood cable	Wire Color on Pioneer cable
Illumination	(+)	Orange	N/A	Orange/White	Orange/White
Reverse Light	(+)	Purple/White	Orange/White	Purple/White	Purple/White
E-Brake	(-)	Lt Green	Yellow/Blue	Lt Green	Lt Green
Foot Brake	(+)	Yellow/Black	Yellow/Black	N/A	N/A
VSS (vehicle speed sensor)	(DATA)	Pink	Green/White	Pink	Pink
Power Antenna	(+)	Blue	Blue	Blue	N/A

TROUBLESHOOTING TABLE

PROBLEM	SOLUTION
Gauges do not work, radio shows OBD2 Error 1 or Error 2.	<p>Ensure OBDII connector is securely attached to the OBDII connector of the vehicle.</p> <p>If you hardwired connections at the OBDII, check connections at the OBDII connector. Make sure the RED/ BROWN wire is on PIN 6 and the YELLOW/ BROWN wire is connected to PIN 14 of the OBDII connector. Do not use T-Taps. Soldering or military splicing methods are recommended.</p> <p>Reset the RR.</p>
There is no sound from OEM sources like Sync.	Ensure the all black, 3-pin to 3.5mm audio cable is connected between the RR and the radio. Make sure it is in the correct radio input.
The climate controls do not work.	Re-check the climate control assembly. Ensure the ribbon cables are not installed backward.
The light on the Maestro is flashing RED ONCE .	There is no firmware on the module; flash the RR module.
The light on the Maestro is blinking RED TWICE .	<p>Ensure the 4-pin data cable is connected between the radio and the RR, and that it is plugged into the black port on the Maestro RR. The red and blue ports on the RR should be empty.</p> <p>Make sure the correct radio model and serial number were entered during the flash. Verify the radio's serial number entered during the flash matches what is listed on the radio screen. This can be found in the settings of the radio, listed as Device Id, Device Number, or Serial Number.</p>

MAESTRO RR RESET PROCEDURE:

Turn the key to the OFF position, then disconnect all connectors from the module.
 Press and hold the module's programming button and connect all the connectors back to the module. Wait, the module's LED will flash RED rapidly (this may take up to 10 seconds).
 Release the programming button. Wait, the LED will turn solid GREEN for 2 seconds to show the reset was successful.

TECHNICAL ASSISTANCE

Phone: 1-866-427-2999

Email: maestro.support@idatalink.com

Web: maestro.idatalink.com/support add www.12voldata.com/forum/

IMPORTANT: To ensure proper operation, the aftermarket radio needs to have the latest firmware from the manufacturer. Please visit the radio manufacturer's website and look for any updates pertaining to your radio.